

HSF

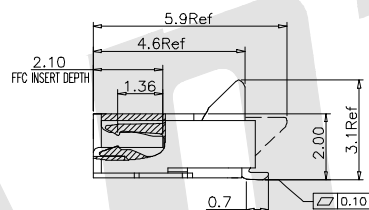

ROHS

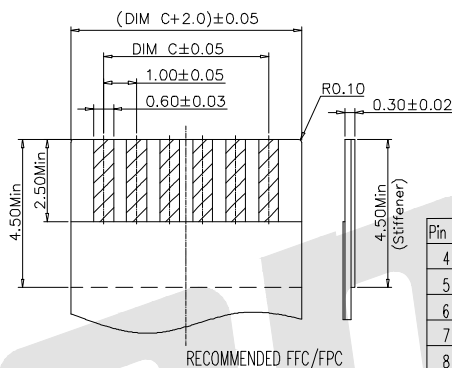
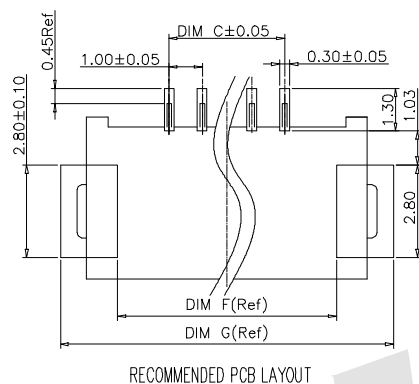
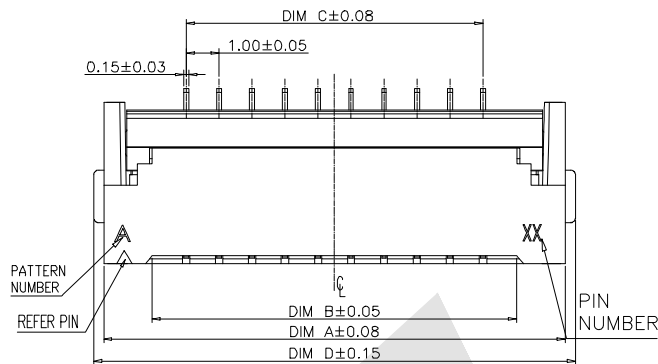

Voltage Rating: AC, DC, 50V (50Hz)
 Current Rating: 0.5A, AC, DC
 Withstand Voltage: 250V/Minute
 Working Temperature: -25°C ~ +85°C
 Insulation Resistance: >500Moh
 Contact Resistance: <0.03oh
 Operating Humidity Range: 20%~85%

Ordering Code:

FPC1.0 - XX - RM - D - X - X - 7
 ① ② ③ ④ ⑤ ⑥ ⑦

- ① 1.0mm FPC Series
- ② Contact NO:
XX=XXpin
04~40P
- ③ APPEARANCE:
RM: SMT Right Angle
- ④ Contact Type:
D: Dual Contact
- ⑤ Packing Type:
T: Tube Packing
A: Tray Packing
R: Tape & Reel
- ⑥ Plating:
G0: Gold Flash
G1: 3U"Gold
SN: MATT-TIN 90-120U"
S0: SELECTIVE GOLD
S1: SELECTIVE GOLD 3U"
- ⑦ Series Number
7

| Pin No. | P/N | DIM A | DIM B | DIM C | DIM D | DIM E | DIM F | DIM G |
|---------|-----------------|-------|-------|-------|-------|-------|-------|-------|
| 4 | FPC1.0-04RMDXX7 | 8.00 | 5.05 | 3.00 | 8.60 | 6.60 | 6.40 | 9.60 |
| 5 | FPC1.0-05RMDXX7 | 9.00 | 6.05 | 4.00 | 9.60 | 7.60 | 7.40 | 10.60 |
| 6 | FPC1.0-06RMDXX7 | 10.00 | 7.05 | 5.00 | 10.60 | 8.60 | 8.40 | 11.60 |
| 7 | FPC1.0-07RMDXX7 | 11.00 | 8.05 | 6.00 | 11.60 | 9.60 | 9.40 | 12.60 |
| 8 | FPC1.0-08RMDXX7 | 12.00 | 9.05 | 7.00 | 12.60 | 10.60 | 10.40 | 13.60 |
| 9 | FPC1.0-09RMDXX7 | 13.00 | 10.05 | 8.00 | 13.60 | 11.60 | 11.40 | 14.60 |
| 10 | FPC1.0-10RMDXX7 | 14.00 | 11.05 | 9.00 | 14.60 | 12.60 | 12.40 | 15.60 |
| 11 | FPC1.0-11RMDXX7 | 15.00 | 12.05 | 10.00 | 15.60 | 13.60 | 13.40 | 16.60 |
| 12 | FPC1.0-12RMDXX7 | 16.00 | 13.05 | 11.00 | 16.60 | 14.60 | 14.40 | 17.60 |
| 13 | FPC1.0-13RMDXX7 | 17.00 | 14.05 | 12.00 | 17.60 | 15.60 | 15.40 | 18.60 |
| 14 | FPC1.0-14RMDXX7 | 18.00 | 15.05 | 13.00 | 18.60 | 16.60 | 16.40 | 19.60 |
| 15 | FPC1.0-15RMDXX7 | 19.00 | 16.05 | 14.00 | 19.60 | 17.60 | 17.40 | 20.60 |
| 16 | FPC1.0-16RMDXX7 | 20.00 | 17.05 | 15.00 | 20.60 | 18.60 | 18.40 | 21.60 |
| 17 | FPC1.0-17RMDXX7 | 21.00 | 18.05 | 16.00 | 21.60 | 19.60 | 19.40 | 22.60 |
| 18 | FPC1.0-18RMDXX7 | 22.00 | 19.05 | 17.00 | 22.60 | 20.60 | 20.40 | 23.60 |
| 19 | FPC1.0-19RMDXX7 | 23.00 | 20.05 | 18.00 | 23.60 | 21.60 | 21.40 | 24.60 |
| 20 | FPC1.0-20RMDXX7 | 24.00 | 21.05 | 19.00 | 24.60 | 22.60 | 22.40 | 25.60 |
| 21 | FPC1.0-21RMDXX7 | 25.00 | 22.05 | 20.00 | 25.60 | 23.60 | 23.40 | 26.60 |
| 22 | FPC1.0-22RMDXX7 | 26.00 | 23.05 | 21.00 | 26.60 | 24.60 | 24.40 | 27.60 |
| 23 | FPC1.0-23RMDXX7 | 27.00 | 24.05 | 22.00 | 27.60 | 25.60 | 25.40 | 28.60 |
| 24 | FPC1.0-24RMDXX7 | 28.00 | 25.05 | 23.00 | 28.60 | 26.60 | 26.40 | 29.60 |
| 25 | FPC1.0-25RMDXX7 | 29.00 | 26.05 | 24.00 | 29.60 | 27.60 | 27.40 | 30.60 |
| 26 | FPC1.0-26RMDXX7 | 30.00 | 27.05 | 25.00 | 30.60 | 28.60 | 28.40 | 31.60 |
| 27 | FPC1.0-27RMDXX7 | 31.00 | 28.05 | 26.00 | 31.60 | 29.60 | 29.40 | 32.60 |
| 28 | FPC1.0-28RMDXX7 | 32.00 | 29.05 | 27.00 | 32.60 | 30.60 | 30.40 | 33.60 |
| 29 | FPC1.0-29RMDXX7 | 33.00 | 30.05 | 28.00 | 33.60 | 31.60 | 31.40 | 34.60 |
| 30 | FPC1.0-30RMDXX7 | 34.00 | 31.05 | 29.00 | 34.60 | 32.60 | 32.40 | 35.60 |
| 36 | FPC1.0-36RMDXX7 | 40.00 | 37.05 | 35.00 | 40.60 | 38.60 | 38.40 | 41.60 |
| 40 | FPC1.0-40RMDXX7 | 44.00 | 41.05 | 39.00 | 44.60 | 42.60 | 42.40 | 45.60 |

| | | | | |
|-----|------------|-----------------------|----------------------------|-----------|
| 4 | STATOR | BRASS | | 2 |
| 3 | TERMINAL | PHOSPHOR BRONZE | | POSITIONS |
| 2 | COVER | THERMOPLASTIC UL94V-0 | BLACK | 1 |
| 1 | HOUSING | THERMOPLASTIC UL94V-0 | NATURAL | 1 |
| NO. | COMPONENTS | MATERIALS | FINISH/COLOR SPECIFICATION | QUANTITY |

Unless Otherwise specified tolerance

X. ±0.35 X.XX: ±0.20
 X.X: ±0.25 X.XXX: ±0.15

| SCALE: | UNIT: |
|----------------------|--------------------|
| As Shown | mm |
| DRAW Wu Feng Rong | DATE 07/23/2021 |
| CHECK BobYang | DATE 07/23/2021 |

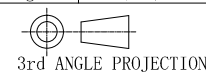

Antenk® ANTENK ELECTRONICS CO., LTD
 Http://www.antenk.com
 E-mail:sales@antenk.com

TITLE: 1.0mm FPC H=2.0mm Dual Contact
 Back Flip Type Connector

DRAWING NO: FPC1.0-XXRMDXX7

PRODUCT NO: FPC1.0-XXRMDXX7

| REV | DESCRIPTION | DATE |
|-----|-------------|------|
| 1 | | |
| 2 | | |
| 3 | | |
| 4 | | |
| 5 | | |