

P. C. B LAYOUT

TYPE	NO. of Positions	A	B	C	D
A6	06	7.62	5.08	7.62	10.10
A8	08	10.16	7.62	7.62	10.10
A10	10	12.7	10.16	7.62	10.10
A12	12	15.24	12.70	7.62	10.10
A14	14	17.78	15.24	7.62	10.10
A16	16	20.32	17.78	7.62	10.10
A18	18	22.86	20.32	7.62	10.10
A20	20	25.40	22.86	7.62	10.10
A22	22	27.94	25.40	7.62	10.10
A24	24	30.48	27.94	7.62	10.10
A28	28	35.56	33.02	7.62	10.10

TYPE	NO. of Positions	A	B	C	D
B20	20	25.4	22.86	10.16	12.60
B22	22	27.94	25.40	10.16	12.60
B24	24	30.48	27.94	10.16	12.60
B28	28	35.56	33.02	10.16	12.60
B32	32	40.64	38.10	10.16	12.60

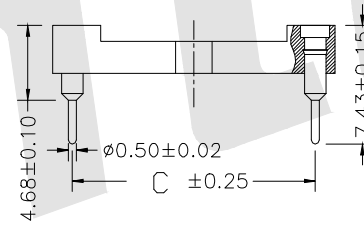

TYPE	NO. of Positions	A	B	C	D
C24	24	30.48	27.94	15.24	17.70
C28	28	35.56	33.02	15.24	17.70
C32	32	40.64	38.10	15.24	17.70
C36	36	45.72	43.18	15.24	17.70
C40	40	50.80	48.26	15.24	17.70
C42	42	53.34	50.80	15.24	17.70
C48	48	60.96	58.42	15.24	17.70
C50	50	63.50	60.96	15.24	17.70
C52	52	66.04	63.50	15.24	17.70

TECHNICAL SPECS:

Current Rating: 1.0Amp  
 Contact Resistance: 10mΩ max  
 Dielectric Strength: Min 1000 V RMS  
 Mechanical Life: Min 100 Cycles  
 Mating Pin: Ø0.40 to Ø0.56mm  
 Operating Temperature: -40° C to +105° C  
 Sleeve: Brass CuZn36Pb3 (C36000)  
 Contact Clip(4 finger): BeCu(C17200)  
 Contact Plating: Au or Sn Over Ni  
 Insulator Material: PPS+30%GF UL 94V-0  
 06p~16P Insulators without center bar  
 36p~52P Insulators with center two bar  
 64P Insulators with center three bar

Ordering Code:

MIFES08 - X - X - X - X - X  
 ① ② ③ ④ ⑤ ⑥

- ① Series No:
- ② Type Selection(See Table)  
 AX: PITCH 7.62MM XP  
 BX: PITCH 10.16MM XP  
 CX: PITCH 15.24MM XP  
 For Example:  
 A6=PITCH 7.62MM 06P
- ③ Pin Plating  
 S1: Tin 150"  
 S2: Tin 200"  
 G0: Gold flash  
 G1: 3u" Gold  
 G2: 5u" Gold  
 G3: 10u" Gold  
 G4: 15u" Gold  
 G5: 30u" Gold
- ④ Clip Plating  
 S1: Tin 150"  
 S1: Tin 200"  
 G0: Gold flash  
 G1: 3u" Gold  
 G2: 5u" Gold  
 G3: 10u" Gold  
 G4: 15u" Gold  
 G5: 30u" Gold
- ⑤ Packing  
 A: Tray  
 B: Bag  
 C: Tube  
 D: Tape Reel

Unless otherwise specified tolerance  
 X. ±0.35 X.XX: ±0.20  
 X.X: ±0.25 X.XXX: ±0.15



ANTENK ELECTRONICS CO., LTD  
 Http://www.antenk.com  
 E-mail:sales@antenk.com

SCALE: As Shown UNIT: mm  
 DRAW Wu Sai DATE 22/03/2018  
 CHECK BobYang DATE 22/03/2018



TITLE: 2.54mm Dual-in-line Socket Straight  
 DIP(H=3 L=7.43) Series

DRAWING NO: MIFES08-XXXXX  
 PRODUCT NO: MIFES08-XXXXX

⚠ Add 3 Series  
 Add Option of Plating  
 DESCRIPTION

12/11/2020  
 18-03-21  
 DATE

REV