

HSF

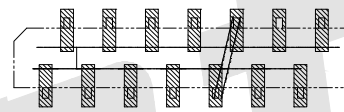

ROHS

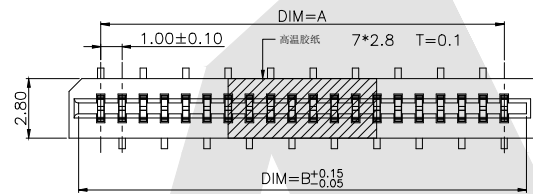
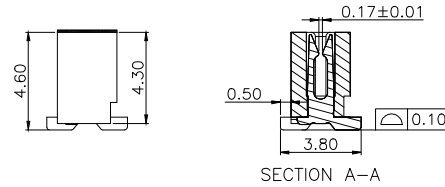
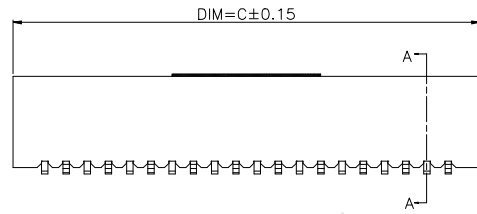

TYPE A
PCB LAYOUT

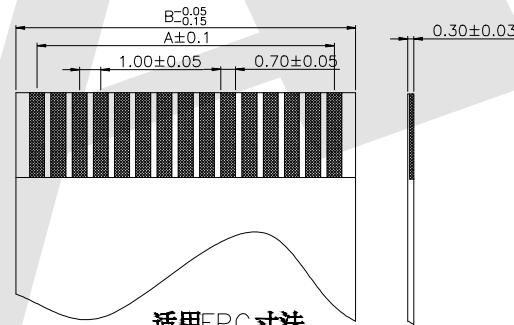

适用FPC寸法
APPLICABLE FPC

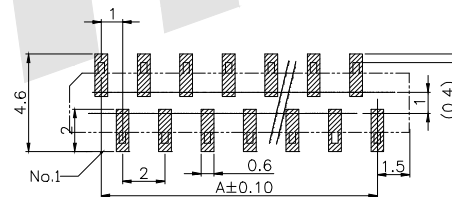

TYPE B
PCB LAYOUT

RECOMMENDED PCB LAYOUT

PIN数	DIM=A	DIM=B	DIM=C
4	3.0	5.1	6.0
5	4.0	6.1	7.0
6	5.0	7.1	8.0
7	6.0	8.1	9.0
8	7.0	9.1	10.0
9	8.0	10.1	11.0
10	9.0	11.1	12.0
11	10.0	12.1	13.0
12	11.0	13.1	14.0
13	12.0	14.1	15.0
14	13.0	15.1	16.0
15	14.0	16.1	17.0
16	15.0	17.1	18.0
17	16.0	18.1	19.0
18	17.0	19.1	20.0
19	18.0	20.1	21.0
20	19.0	21.1	22.0
21	20.0	22.1	23.0
22	21.0	23.1	24.0
23	22.0	24.1	25.0
24	23.0	25.1	26.0
25	24.0	26.1	27.0
26	25.0	27.1	28.0
27	26.0	28.1	29.0
28	27.0	29.1	30.0
29	28.0	30.1	31.0
30	29.0	31.1	32.0
31	30.0	32.1	33.0
32	31.0	33.1	34.0
33	32.0	34.1	35.0
34	33.0	35.1	36.0
35	34.0	36.1	37.0
36	35.0	37.1	38.0
37	36.0	38.1	39.0
38	37.0	39.1	40.0
39	38.0	40.1	41.0
40	39.0	41.1	42.0

MATERIAL

HOUSING:HIGH-TEMP.
ACTUAOR:HIGH-TEMP.
CONTACT:COPPER ALLOY. PLATING:ALL TIN
OR GOLD.
HOLDDOWN:COPPER ALLOY. PLATING:ALL
TIN, LEAD FREE.

ELECTRICAL

VOLTAGE: 50V MAX.
CURRENT: 0.5A MAX.
DIELECTRIC WITHSTANDING VOLTAGE: 250 VAG.
INSULATION RESISTANCE: 50 MEGAOHMS MIN.
CONTACT RESISTANCE: 20 MILLIOHMS MAX.

ENVIRONMENTAL

TEMPERATURE RANGE: -20° C TO 85° C.

FEATURE AND SPECIFICATIONS

SIZES 03 TO 61 PIN.
FOR 0.3mm THICKNESS FFC/FPC.

Ordering Code:

FPC1.0 - XX - SM - D - X - X - X - X
① ② ③ ④ ⑤ ⑥ ⑦ ⑧

① 1.0mmFPC Series:

② Contact NO:
XX-XXpin
For example:
06=06pin

③ APPERANCE:
RM:SMT Right Angle
RT:DIP Right Angle
SM:SMT Straight
ST:DIP Straight

④ Contact type:
D: Dual contact

⑤ Packing Type:
T: Tube packing
A: tray packing
R: tape & reel

⑥ Special Function
A:Type A
B:Type B

⑦ Plating:
G0:Gold Flash
G1: 3U"gold
SN: MATT-TIN 90-120U"
S0: SELECTIVE GOLD
S1: SELECTIVE GOLD 3U"

⑧ Series Number: 4



Unless Otherwise specified tolerance
X. ±0.35 X.XX: ±0.20
X.X: ±0.25 X.XXX: ±0.15

SCALE: As Shown	UNIT: mm
DRAW Jack Bao	DATE 10/18/2018
CHECK BobYang	DATE 10/18/2018



Antenk® ANTENK ELECTRONICS CO.,LTD
Http://www.antenk.com
E-mail:sales@antenk.com

TITLE:
1.0mm FPC, VERTICAL SMT, DOUBLE CONTACT

DRAWING NO: FPC1.0-XXSMDXXX-4

PRODUCT NO: FPC1.0-XXSMDXXX-4

⚠ Add Series Number: 4

REV DESCRIPTION DATE

1 2 3 4 5 6 7 8