

PS3001/PS3002-H Series

Tact Switches

SPECIFICATIONS

RATING: 30mA / 28VDC

OPERATING SPEED: 10mm/sec

ELECTRIC LIFE: 20,000 cycles

FULL TRAVELS: 2.0mm

OPERATING TEMPERATURE: -40°C to 95°C

MATERIALS

PUSHER: POM Black

DUST PROTECTION CAP: POM Black

CASE: PA Nature glass fiber reinforced

SPRING: Piano wire

CONTACT/TERMINALS: Brass, silver plated



POLE OPTIONS

SPST

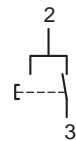
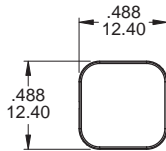

CIRCUIT

NOTE

Force: 3.4~6.4N

Operating position: 8.9 ± 0.2 mm

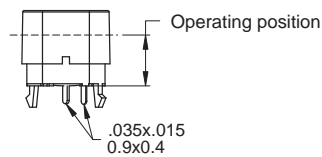
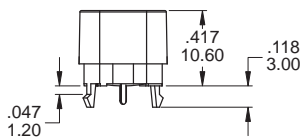

Part No. Shown : PS3001

P.C. MOUNTING

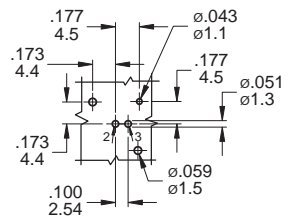

SPDT

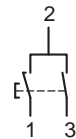
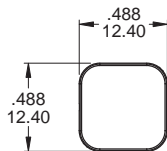

CIRCUIT

NOTE

Force 1: 5~7N

Force 2: 10~13N

Operating position 1: 9.7

Operating position 2: 8.9

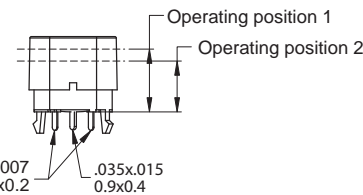
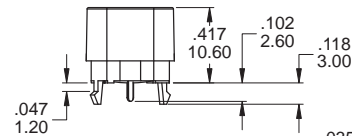

Part No. Shown : PS3002-H

P.C. MOUNTING

