

## KW4-3Z-3 系列 MINIATURE MICRO SWITCH 小型微动开关

### ■ 订货型号指引 Ordering Instruction

开关类别 Switch Type	外壳特征 Outline characteristic	接触形式 Circuit Code	接触形式 Circuit Code	按钮露出本体高度规格 Button high out of Bousing	外壳颜色 Housing Color	额定负载 Electrical Rating	温度等级 Degree of temperature	操作柄类型 Lever Type	按钮处操作力 Operatioon force on button	特殊说明 Special remark
KW4-3Z 系列微动开关 / KW4-3Z Series Micro-Switch	A 塑壳外扣式 Hook up style	1 SPDT 单极双投	1 2.8 快接端子 2.8X0.5 2.8 Quick connect	1 1.3mm	0 绿色 Green	2 5A 125/250VAC T120 UL 5(2) 250VAC T85 VDE 3A 250VAC T85 50E3 VDE 5A 250VAC T120 UV&CE&CQC	1 T55	L No lever 不带压柄	4.5N Max	D 假脚 Dull Terminal
	B 塑壳合盖式 Basic style	2 SPST-NO 单极单投 - 常开	2 焊接端子 Solder terminal	2 1.4mm	1 黑色 Black	5 10(6)A 250VAC TUV&CE 10A 250VAC T85 TUV&CE 10.1A 125VAC T120 UL	3 T120	L1 17mm 压柄 17mm Lever	250 250 ± 50gf	S 条纹触点 Serrated contact
	C 双联 Double pole	3 SPST-NC 单极单投 - 常闭	3 PCB 端子 PCB terminal	3 1.7mm	2 棕色 Brown	6 12A 30VDC T120 UL	... 其他 其他	L2 R 型压柄 R Lever	130 130 ± 30gf	R 端子右折 45 度 Terminals right bend 45°
	... 其他 Other		4 右侧 PCB 端子 Right side PCB terminal	4 1.9mm	... 其他 Other	7 10A 36VDC		L3 滚轮压柄 Roller Lever	70 70 ± 30gf	L 端子左折 45 度 Terminals left bend 45°
			5 左侧 PCB 端子 Left side PCB terminal	5 2.8mm 蘑菇按钮 2.8mm Mushroom button	... 其他 Other			L4 29mm 压柄 29mm Lever	X Max.OF	W 带线 With wire
			6 后侧端子 Back side terminal	6 2.5mm 双联单按钮 2.5mm DP single button				... 其他 Other	... 其他 Other	HR 空心铆钉 Hollow Rivet
			7 椭圆孔焊接端子 Solder terminal with oval hole	7 3.3mm 高蘑菇按钮 3.3mm High Mushroom button						MR 机械铆接 Mechanical riveting
			0 非标准端子 Non-standard terminal	8 1.4mm (胶木) 1.4mm Bakelite						ST 插座 Socket
				... 其他 Other						M 磁铁 Magnet
										GW 材料灼热丝要求 Glow wire
									SL 特殊 Special	
									C 镀银触点 Silver plating contact	
									P 镀层要求 Plating thickness request	
									SP 小行程 Small Travel	
									HF 无卤材料 Halogen free material	
									... 其他 Other	



### ■ 特性参数 Parameters

项目 Item	特性值 Value
工作速度 / Operating speed	0.1mm~1m/S
工作频率 / Operating frequency	机械频率 60 次 / 分钟 / Mechanical 60cycles/min 电气频率 25 次 / 分钟 / Electrical 25cycles/min
绝缘电阻 / Insulation Resistance	≥ 100MΩ (DC500V)
接触电阻 / Contact Resistance	≤ 50mΩ (初始值 / Initial value)
介电强度 / Test voltage	同极不相接端子之间 (Between terminals of same polarity)
	带电金属零件与地 (外壳) 之间 Between current-carrying metal parts and ground(case)
抗震动性 / Vibration resistance	10~55 HZ 1.5mm 双振幅 Double amplitude
抗冲击 / Shock resistance	破坏 (Destruction) : 动作力 (OF) > 0.5N; 1000m/S <sup>2</sup> (approx. 100G) Max
	动作力 (OF) ≤ 0.5N; 500m/S <sup>2</sup> (approx. 50G) Max
	故障 (Malfunction) : 动作力 (OF) > 0.5N; 300m/S <sup>2</sup> (approx. 30G) Max
	动作力 (OF) > 0.5N; 200m/S <sup>2</sup> (approx. 20G) Max
寿命 / Service Life	1. 机械寿命 ≥ 1000000 次 Mechanical ≥ 1000000cycles 2. 电气寿命 ≥ 50000 次 Electrical ≥ 50000cycles (取决于具体型号 / Depend on model No.)
触电保护等级 / Degree of protection against electric shock	Class I / Class II
PTI (漏电起痕指数)	250
安规认证 / Approvals	UL CUL VDE TUV CE CQC



■接触形式说明 Circuit Illustration

转换式 SPDT	常开式 SPDT-NO	常闭式 SPDT-NC
1 转换型 SP change-over	2 常开型 Normally Open	3 常闭型 Normally Closed

■外形特征 Outline Characteristic

外扣式 Hook up Style	合盖式 Basic Style
A	B

■标准端子规格 Termination

<p>快接端子 Quick connect terminal</p> <p>1</p>	<p>焊接端子 Solder terminal</p> <p>2</p>	<p>PCB端子 PCB terminal</p> <p>3</p>
<p>右侧PCB端子 Right side PCB terminal</p> <p>4</p>	<p>左侧PCB端子 Left side PCB terminal</p> <p>5</p>	

■安装孔尺寸 Mounting Hole Dimensions

	PCB端子 PCB terminal	左侧PCB端子 Left side PCB terminal	右侧PCB端子 Right side PCB terminal

## L 杠杆规格种类 (levers Forms)

<p><b>L1</b></p>	<p><b>L9</b></p>	<p><b>L17</b></p>
<p><b>L2</b></p>	<p><b>L10</b></p>	<p><b>L18</b></p>
<p><b>L3</b></p>	<p><b>L11</b></p>	<p><b>L19</b></p>
<p><b>L4</b></p>	<p><b>L12</b></p>	<p><b>L20</b></p>
<p><b>L5</b></p>	<p><b>L13</b></p>	<p><b>L21</b></p>
<p><b>L6</b></p>	<p><b>L14</b></p>	<p><b>L22</b></p>
<p><b>L7</b></p>	<p><b>L15</b></p>	<p><b>L23</b></p>
<p><b>L8</b></p>	<p><b>L16</b></p>	<p><b>L24</b></p>

KW4-3Z-3 系列 MINIATURE MICRO SWITCH 小型微动开关



NINGBO JIALIN ELECTRONICS CO.,LTD.



嘉林电子

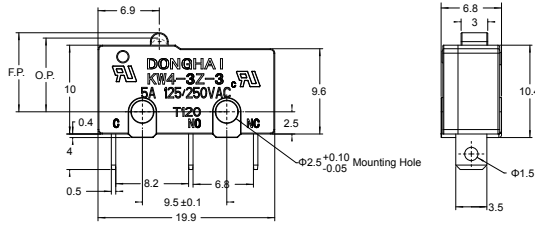
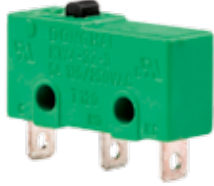

B

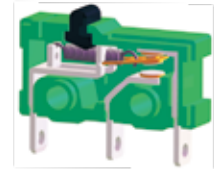
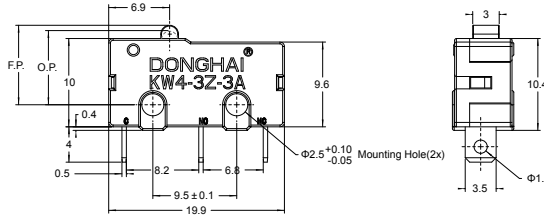

A

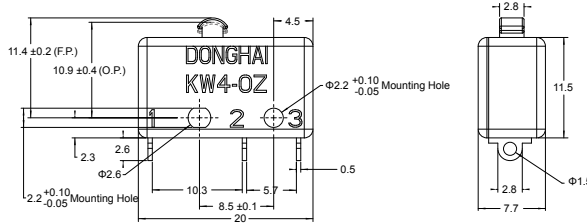

C

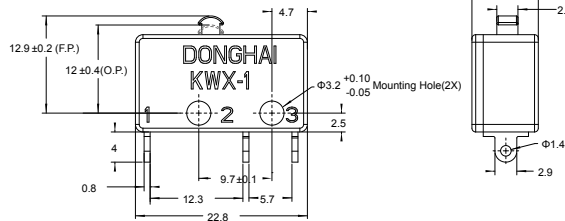

E

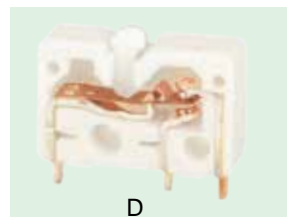
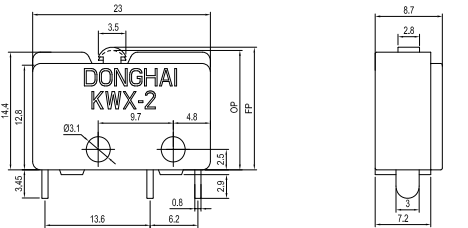

D

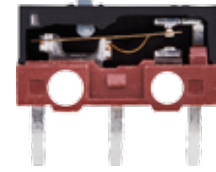
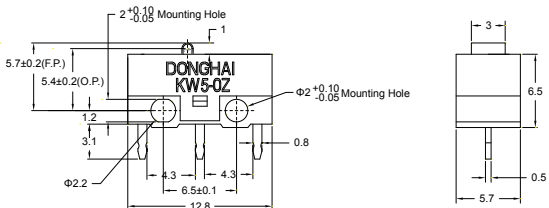

F

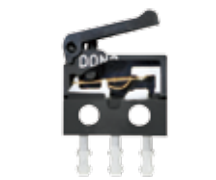
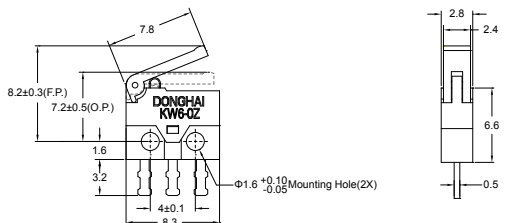

G

CONTACT US FOR MORE TECH IFO 16

## KW4-3Z-3 系列 MINIATURE MICRO SWITCH 小型微动开关



KW4-3Z-3B222023L  
(SPST-NO)



KW4-3Z-3B225023L  
(SPST-NO)



KW4-3Z-3B232023L  
(SPST-NO)



KW4-3Z-3B242023L  
(SPST-NO)



KW4-3Z-3B252023L  
(SPST-NO)



KW4-3Z-3B212023L  
(SPST-NO)



KW4-3Z-3B322223L  
(SPST-NC)



KW4-3Z-3B122023L  
(SPDT)



KW4-3Z-3B125023L  
(SPDT)



KW4-3Z-3B132023L  
(SPDT)



KW4-3Z-3B142023L  
(SPDT)



KW4-3Z-3B152023L  
(SPDT)



KW4-3Z-3B112023L  
(SPDT)



KW4-3Z-3B162023L  
(SPDT)



KW4-3Z-3B322023L  
(SPST-NC)



KW4-3Z-3B325023L  
(SPST-NC)



KW4-3Z-3B332023L  
(SPST-NC)



KW4-3Z-3B342023L  
(SPST-NC)



KW4-3Z-3B352023L  
(SPST-NC)



KW4-3Z-3B312023L  
(SPST-NC)



KW4-3Z-3B125223L  
(SPDT)



KW4-3Z-3B222023L1  
(SPST-NO)



KW4-3Z-3B222023L2  
(SPST-NO)



KW4-3Z-3B242023L4  
(SPST-NO)



KW4-3Z-3B222023L3  
(SPST-NO)



KW4-3Z-3B222023L7  
(SPST-NO)



KW4-3Z-3A-3B222023L54-R  
( SPST-NO )



KW4-3Z-3B222223L1  
(SPST-NO)



KW4-3Z-3B122023L1  
(SPDT)



KW4-3Z-3B122023L2  
(SPDT)



KW4-3Z-3B142023L4  
(SPDT)



KW4-3Z-3B122023L3  
(SPDT)



KW4-3Z-3B122023L7  
(SPDT)



KW4-3Z-3B222023L104  
( SPST-NO )



KW4-3Z-3B112023L17  
(SPDT)



KW4-3Z-3B322023L1  
(SPST-NC)



KW4-3Z-3B322023L2  
( SPST-NC )



KW4-3Z-3B222023L23  
(SPST-NO)



KW4-3Z-3B322023L3  
(SPST-NC)



KW4-3Z-3B122023L5  
( SPDT )



KW4-3Z-3B152023L3  
( SPDT )



KW4-3Z-3B312223L2  
(SPST-NC)