

NS-525 重型組合式裁床
Heavy Duty Flexible Cutting Table
NS-526 重型防火板面組合式裁床
Heavy Duty Laminated Flexible Cutting Table



NS-526

- 適合自動拉布機拉布
- 採用優質鋼質腳架，結構穩固，承載能力強
- 台腳可調高度為30"~34"
- 採用三腳型台腳設計，堅固耐用
- 活動式組合，易於安裝及拆散，可根據客戶需要加長或縮短
- 採用不鏽鋼摺板包邊做傍位，配合藝誠拉布機無需安裝Z型路軌
- Suitable for working together with Automatic Cloth Spreader
- Adopt high quality steel leg , stable structure and strong supporting ability
- Leg height is adjustable between 30"~34"
- Adopt leg structure type of three legs, strong and durable
- Flexible combination, easy to assemble and disassemble, may also lengthen or shorten it according to the customer's need
- Adopt stainless steel curved plate as guide, work together with Cloth Spreader of Ngai Shing , no need to install Z track



防火板
Laminated board

台面材質對比
Material of table top



纖維板
Fiber board



不銹鋼摺板包邊作傍位
Stainless steel curved plate as guide

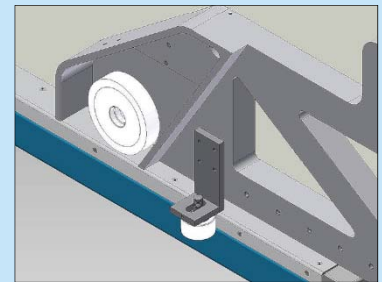

無路軌裁床与拉布機配合原理圖
Work Principle of Cloth Spreader & Cutting Table without Track

型號 Model	台面材質 Table Top Material	台面寬度 Table Width (inch)	拉布闊度 Spread Cloth Width (inch)	每節長度 Length of Each Section (inch)	台腳可調高度 Adjustable Leg Height (inch)
		三腳 3 Legs			
NS-525	纖維板 Fiberboard	66、72、84	60、66、78	48	30~34
NS-526	防火板 Laminated Board	66、72、84	60、66、78	48	30~34



藝誠(余氏)發展有限公司
Ngai Shing Development Limited

香港九龍長沙灣永康街52號地下

G/F., 52 Wing Hong St.,

Cheung Sha Wan, Kln., Hong Kong.

Tel : (852) 2741 9981, 2742 0078
 Fax : (852) 2785 3149

E-MAIL: info@ngaishing.com
 Http://www.ngaishing.com