

Disposable Virus Sampling Tube

INSTRUCTION FOR USE

Product Name

Disposable Virus Sampling Tube

Product Description

Inactivated Disposable Virus Sampling Tube is based on Hank's balanced salt solution enriched with inactivator and nucleic acid protective agents. It is used for nucleic acid extraction of samples such as viruses, mycoplasma, chlamydia and ureaplasma.

Classic Disposable Virus Sampling Tube is an upgrade from the Hank's solution. Additional various components, such as BSA, HEPES, amino acids, cryoprotectant, etc., are added to enhance the virus integrity. It can be used for nucleic acid extraction of virus, mycoplasma, chlamydia and ureaplasma samples and later virus isolation.

The pH of the preservation solution is 7.4 ± 0.5 . The medium contains antibiotics and antimycotics for the purpose of inhabitation of bacteria and yeasts overgrowth. It helps to maintain the cellular integrity and preserve the viruses, mycoplasma, chlamydiae and ureaplasma.

Size

VST-01, VST-02, VST-03

3 mL×20 Pcs, 3 mL× 50 Pcs, 3 mL×100 Pcs

Kit Contents

Type	Components
VST-01	1×3 mL of classic medium in tube
	1×3 mL classic medium in tube, 1×pp fiber swab
VST-02	1×3 mL of inactivated medium in tube
	1×3 mL inactivated medium in tube, 1×pp fiber swab
VST-03	1×3 mL of stroke-physiological saline solution in tube
	1×3 mL stroke-physiological saline solution in tube, 1×pp fiber swab

Precautions: Materials required for isolation, extraction and culture of viruses, mycoplasma, chlamydiae and ureaplasma.

Storage and Expiration

This product expires in 12 months when stored at room temperature and in prevention of light. Manufacture date and expiration date are printed on the label.

Limitations

Disposable Virus Sampling Tube is intended to be used with the medium tubes and swabs provided in this product. The use of tubes of medium or swabs from any other source could affect the performance of the product.

Instructions for use

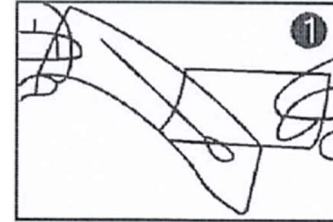

Unwrap the package, take out the swab.

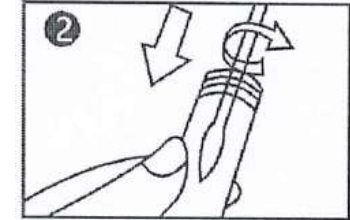

Use the swab to collect samples and put it back into the tube

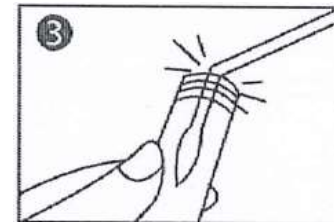

Break the swab rod and leave the sampling parts inside the tube.

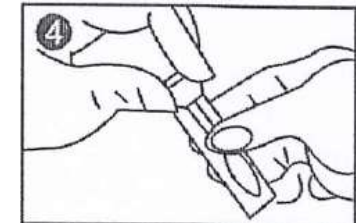

Screw the lid tightly and mark on the tube.

Principles of the Procedure after Specimen Collection

When collect specimens with Inactivated Disposable Virus Sampling Tube, tube can be transported to the laboratory at room temperature ($5-25^{\circ}\text{C}$) within 7 days. It's better with ice bag. Avoid repeated freeze-thaw cycles. For best performance, complete testing within 24 hours in controlled temperature environment.

When collect specimens with Classic Disposable Virus Sampling Tube, tube can be transported to the laboratory at $2-8^{\circ}\text{C}$ within 2 days. If it can not be delivered to the laboratory within 48hours, it should be stored at -70°C or below, and ensure that the collected specimens are delivered to the laboratory within 1 week. Avoid repeated freeze-thaw cycles. For best performance, complete testing within 24 hours.

Precautions

1. Please read this instruction carefully before use.
2. Disposable Virus Sampling Tube should be used by trained and qualified personnel.

3. Do not use beyond expiration date. Do not use if the original seal of the medium and swab is damaged. Check the outer packaging of the product before use to make sure it is complete with no content overflow. The labeling is unbroken with clear content and no shedding. The preservation solution should be pre-loaded in the sampling tube. It is normal phenomenon to have precipitate at low temperature. Inactivated Disposable Virus Sampling Tube is a clear solution, do not use if the color of the medium turned turbid, or cloudy; Classic Disposable Virus Sampling Tube is an orange-red color solution, do not use if the color of the medium has changed from light orange-red.

4. Avoid the medium in contact with eyes and skins.

5. Do not contaminate the tip of the swab before taking samples.

6. Be careful when the swab is inserted into the mouth for oral sampling. Avoid the risk of choking.

7. For single use only. Different patients are prohibited from using the same swab or tube.

8. Specimens for the search of viruses, mycoplasma, chlamydiae and ureaplasmas involves risk of infection, and must be collected and handed using proper PPE against biological risk according to published guidelines and local regulations.

9. Sample sites, condition, volume and timing of specimen collected are significant variables in obtaining reliable culture results. Follow recommended guidelines for specimen collection.

10. The use of this product in combination with diagnostic kits or instruments must be validated by the user prior to use.

11. Waste must be disposed of in compliance with local legislation. If necessary, take appropriate precautions for infected material.

Company Information

 Shenzhen Uni-medica Technology Co. Ltd









Tel: 86-0755-86505501 **Fax:** 86-0755-86505501-822

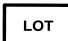

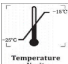

Registered and manufacturing address: Room 202, Block 6th, LiuXian Culture Park, Xili Town, Nanshan District, Shenzhen, Guangdong Province, P. R. China.

Post code: 518055 **Website:** www.uni-medica.com

 CMC Medical Devices & Drugs S.L.

Address: C/ Horacio Lengo Nº 18, CP 29006, Málaga, Spain

	Batch Code		Do Not Reuse
	Expiration Date in Year-Month-Day Format		Date of Manufacture
	Temperature Limitation		Consult instructions for use
	caution		Keep away from sunlight

SYMBOL	DESCRIPTION	SYMBOL	DESCRIPTION
	Manufactured By		CE Mark
	Authorized Representative	REF	Catalog Number
	In Vitro Diagnostic Medical Device		Potential Biological Hazards After Use