

# Platinum Resistance Temperature Sensor

**GAIMC**

## GTS300



### DESCRIPTION

Platinum resistance temperature sensor is a temperature sensor which is made by using the resistance of metal platinum (pt) as a function of temperature. It is widely used because of its high measurement accuracy, large measurement range, reproducibility and stability. Temperature measurement in the range of medium temperature (-200°C~ 650°C)

### FEATURES

- High precision and good stability ;
- High sensitivity and good linearity ;
- The response time is small and the interchangeability is good ;
- Small structure, easy installation and good waterproofness;
- Adopting imported German film chip,

### APPLICATION

Platinum resistance temperature sensor is mainly used in high precision temperature equipment such as medical, motor, industrial, temperature calculation, resistance calculation, etc., and its application range is very wide .

## DIMENSIONS

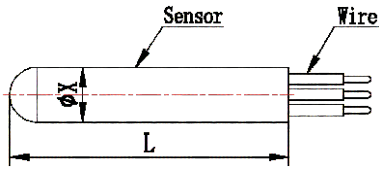

Fig.(a)

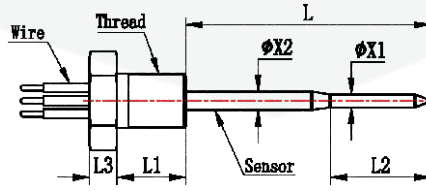

Fig.(b)

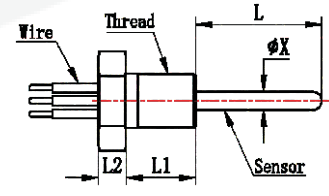
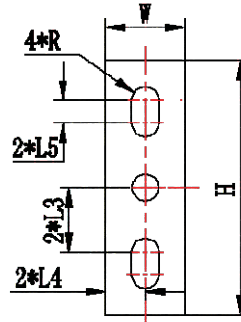
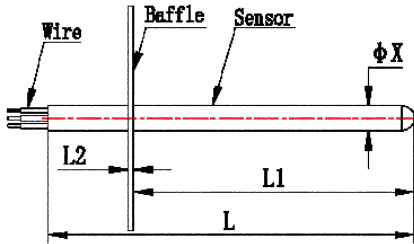
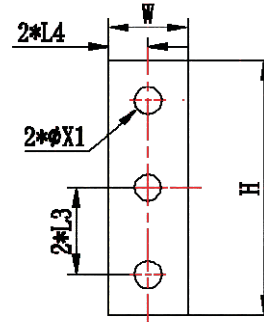

Fig.(c)



A Baffle



B Baffle

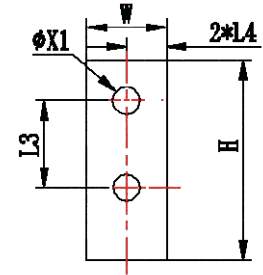

C Baffle

Fig.(d)

## PARAMETERS

|                        |   |
|------------------------|---|
| RTD                    | PT100, PT1000   |
| Accuracy               | 1/3DIN( $\pm 0.1^\circ\text{C}$ ), Grade A( $\pm 0.15^\circ\text{C}$ ), Grade B( $\pm 0.3^\circ\text{C}$ )        |
| Temp. range            | 1/3DIN: $0\sim+150^\circ\text{C}$ ; Grade A: $-50\sim+300^\circ\text{C}$ ; Grade B: $-70\sim+500^\circ\text{C}$ ; |
| Shell size             | Diameter: $\phi 3\sim\phi 9\text{mm}$ , length: $3\text{mm}\sim 1000\text{mm}$                                    |
| Shell material         | Stainless steel, copper, copper plated nickel, aluminum, ABS, PVC.  |
| Wire                   | UL series (such as UL1007), Supply line number, using temp. range, outside diameter and material requirements.    |
| Connector              | Molex, JST, DuPont, CWB, CJT, etc.  |
| Heat-shrinkable sleeve | PVC tube; glass fiber tube; teflon tube   |

Order instruction:

When you placing order , please inform us the following parameters:

- 1.Application and working environment (whether to waterproof, acid or alkali and other)
- 2.Accuracy requirement (1/3DIN( $\pm 0.1^\circ\text{C}$ ), Grade A: $\pm 0.15^\circ\text{C}$ , Grade B: $\pm 0.3^\circ\text{C}$ )
- 3.Temperature measurement range ( $-70\sim+500^\circ\text{C}$ )
- 4.Which wires output (Commonly 2 wires/3 wires/4 wires, Choose one of them)
- 5.Shell material(Stainless steel, copper, copper plated nickel, aluminum, ABS, PVC.)
- 6.Shell pipe diameter and length(Commonly Size: $3*30\text{mm}$ ,  $4*30\text{mm}$ ,  $5*30\text{mm}$ ,  $6*30\text{mm}$ ; others can be customized)
- 7.Wire material and length (Common PVC, silicone, teflon)
- 8.How to deal with end of Line (hung tin, with connector)