Multi-functional Hydra Cleaning Skin Rejuvenation Machine

SPA227 User Manual



IMPORTANT: before starting the equipment correctly, please follow the installation instructions. Any damages caused by incorrect operations will void the warranty.

Safety Information:

Thank you for choosing our products! This user instruction is specially designed for the safety of you and others. Please read the instructions carefully before installing or using the machine and follow them when using. The company does not take any responsibility for any accidents and problems caused by improper operation or mistakes, excluding quality problems.

Electrical Safety

Before installing the machine, make sure that your local electric network complies with the voltage and frequency indicated on the tag on the rear panel. Otherwise, the machine may be damaged in case of excessive current or voltage rise.

Never touch the machine with damp or wet hands or feet.

It is dangerous to change or try to modify the function of this machine in anyway.

Do not attempt to operate this unit if the power cord has been frayed or broken

Do not spill water or other liquids into or onto your unit.

During long periods of non-use, disconnect the unit's main power.

Safety Rules When Installing

Place the machine on a stable and secure base. It should not be subjected to any jolts or vibrations.

Never expose the unit to too high(>40°C) nor too low temperature(<5°C).

NEVER EXPOSE THE UNIT TO RAIN OR ANY OTHER HUMIDITY.

Do not expose the unit to direct sunshine or install the unit close to a source of heat(central heating, radiator...); otherwise the screen may be damaged.

Do not cover or block the ventil at or behind the unit.

Safety Rules When in Use

Well clean areas to treat before treatment.

Never touch the machine with damp or wet hands or feet.

Operate Interface Instruction

Treatment screen interface

Make sure the power line has been installed correctly; make sure the hand pieces are well connected with the equipment; Ensure the circuit breaker (if any) at the back of the machine is pressed to "on". The front button of the emergency stop switch set to standby state. Press the front button and the machine is powered. The working menu will appear automatically. Turn the key switch rightwards, the screen is on. Choose the Language. Choose the right parameter to do the treatment according to the needs of customer.

Turn on the machine and you can see the welcome screen and main selection interface.

1. Parts introduction:

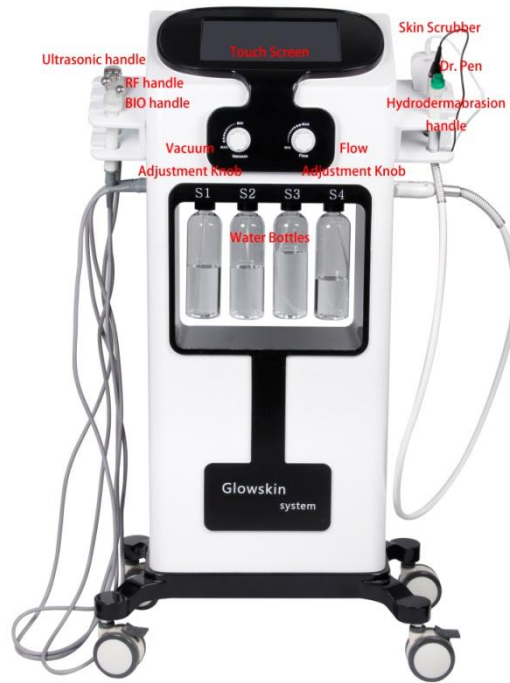

2. Installation

- (1) Open the package and get all the spare parts out;
- (2) Put the BIO hose into the port A;
- (3) Put the RF hose into port B;
- (4) Connect the Ultrasound hose with port C;
- (5) Connect the Hydradermabrasion hose with port D;
- (6) Connect the Dr. Pen hose with port E;
- (7) Connect the Skin Scrubber hose with port F;
- (8) Connect the power line;
- (9) Open the power switch.



3. User interface:

Open the power switch and enter the following interfaces (use your fingers instead of nail or pens to touch the screen):

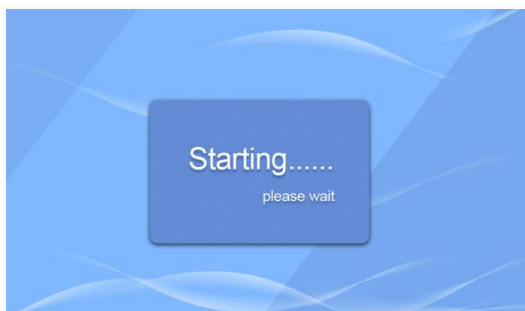





(1) Hydradermabrasion Interface

Hydradermabrasion– the latest in skin care technology. Hydradermabrasion utilizes the natural healing powers of water and oxygen to effort lessly exfoliate the skin without the use of hard crystals or abrasive textured wands, generating deeply hydrated and healthier looking skin.

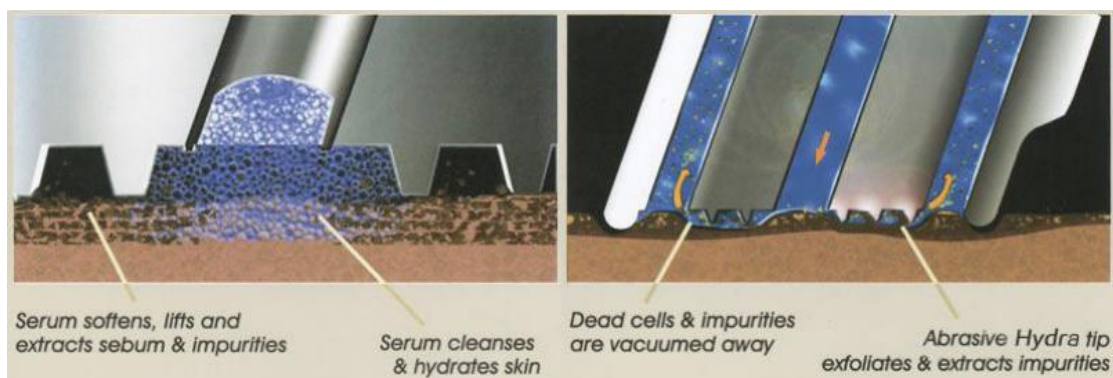
Application:

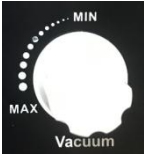
- Rejuvenate sun damaged skin-face, neck, shoulders, back, arms and legs.
- Reduce age spots.
- Minimize of blotchy skin coloring.
- Reduce acne and superficial scars from past injury.
- Remove blackheads and whiteheads.
- Reduce oily skin.
- Improve overall skin health.

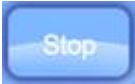

- ① Select bottle S1/S2/S3/S4, adjust Vacuum  and flow level  on the equipment, click  to set working time.
- ② Press  to start operation and  to stop operation.

(2) Ultrasonic Interface

Ultrasonic, with the frequency of 1-3 million times per second, with the process to be transmitted to the body, is absorbed by epidermis dermis subcutaneous tissue, the absorption of ultrasonic waves is converted into thermal energy, thermal effects of ultrasound, the living tissue temperature increased slightly 0.5-1°C, promote capillary function and fine inter cellular lymph flow, helps transport nutrients to the cells needed for blood vessels, promote metabolism and to assist the flow of lymph, maintain healthy skin. Maintain skin elasticity/ break down fat and prevent obesity. 1 million vibrations per second ultrasound, when the wave is transferred to the organization, with the ultrasonic vibrations stimulate biological tissue and skin tissue, relieve tension, to maintain skin elasticity. Heated generated by vibration can make it easier to break down fat and help prevent obesity.

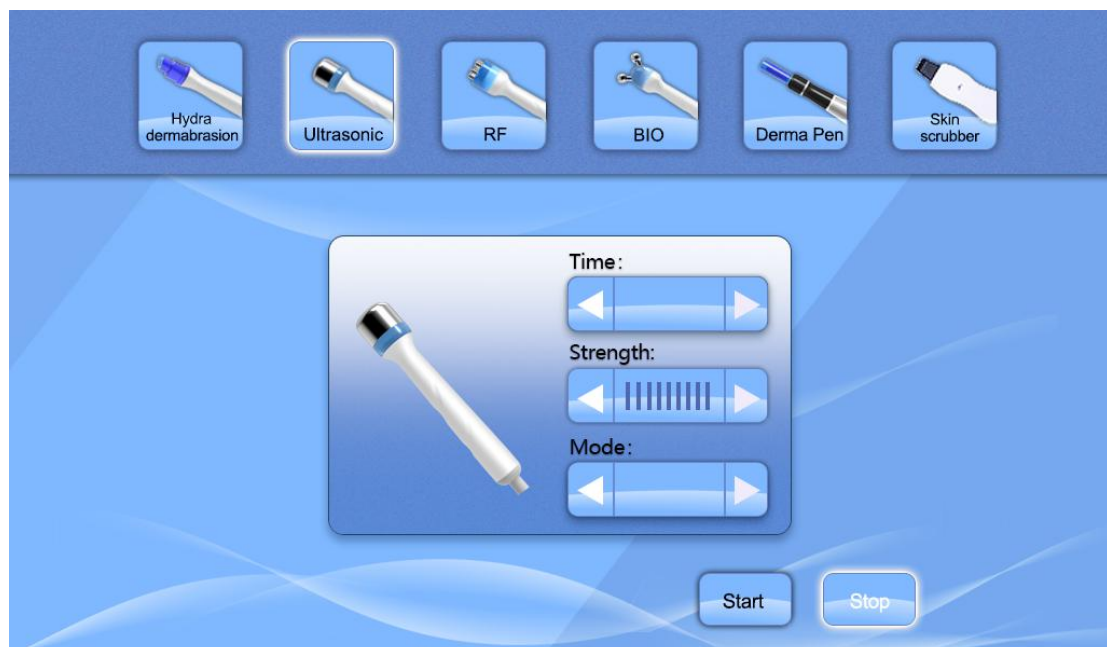

- ① Press the button  to adjust the strength.

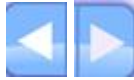
② Click on the button  to adjust the working time, working time for face is from 20-30mins.

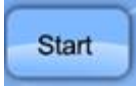
③ Apply medium(gel, essence etc) to the care area, click on the button  to start.

④ The working time to the instrument will automatically pause.

⑤ Use warm water to clean the skin.

⑥ Clean and disinfect used ultrasound working head.

***Precautions:**

① Apply enough medium to the care area when operating.

② Each part of the working hours should not exceed 30mins.

③ Do not use on your eyes, heart etc.

④ Do not stay a long time in one part of the body.

⑤ After the instrument moves the audio work head can not be used for a long time in the no-load state.

(3) RF Interface

Radio frequency radio waves enter the deep part of the skin, and the internal natural resistance movement causes the skin to heat up. The use of dermal collagen cellulose immediately produce a contraction principle at 45 – 60°C, which can smooth wrinkles, tighten the skin and delay skin aging.

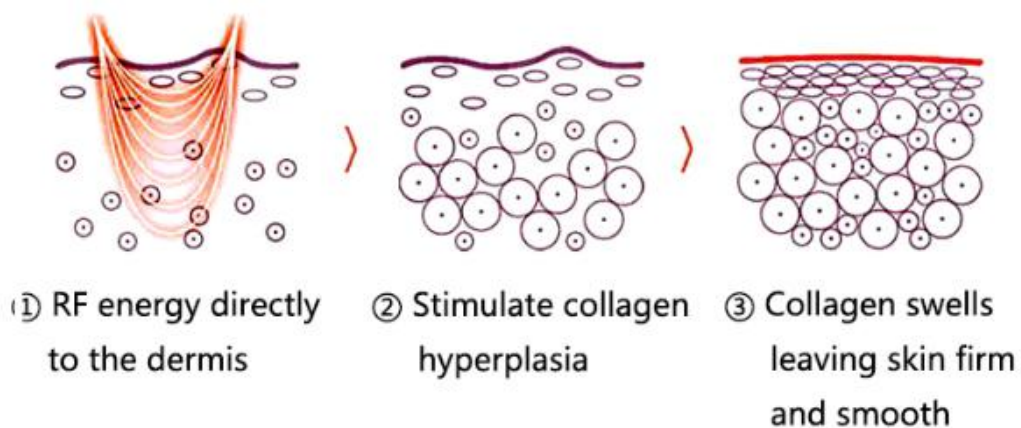

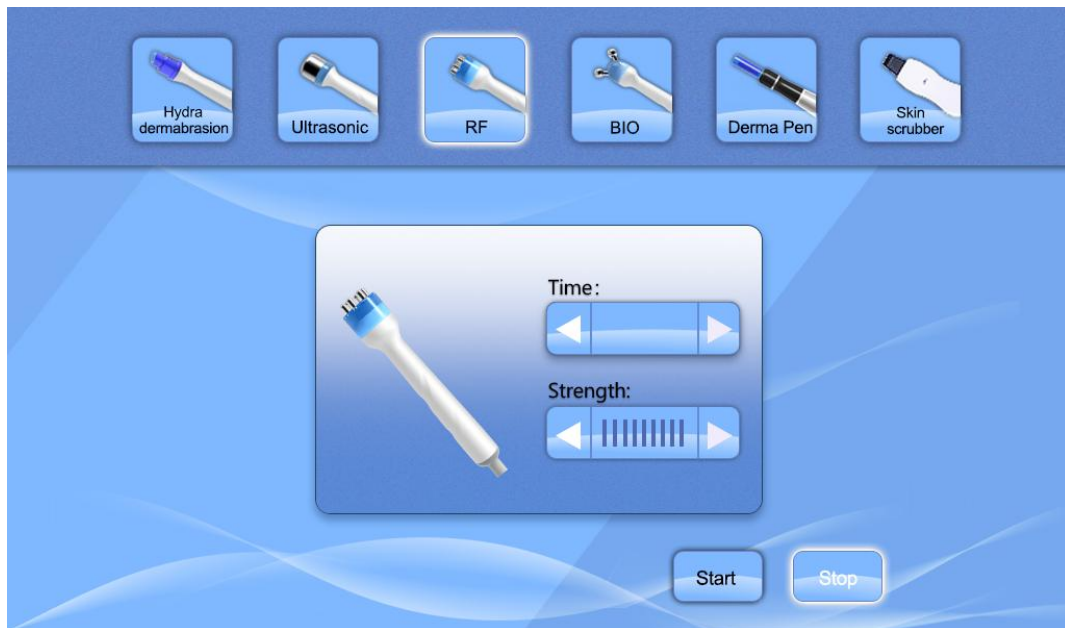

① Click  to adjust the strength.

② Click  to set treatment time: 20-30 minutes for face.

③ Click  to start operation

④ To put some cooling gel on the treatment area, move the RF work head from inside to outside, from down to up. Should reduce the output intensity, because there has less fat around the eye and Forehead.

⑤ The machine will pause when the treatment time is up.

⑥ To clean the skin with warm water, clean and disinfect the RF work head.

Remark:

① The operator should wear the insulated gloves before operate.

② The RF tip must completely contact the skin.

③ The RF tip should close to the skin and move slowly, can not stop there.

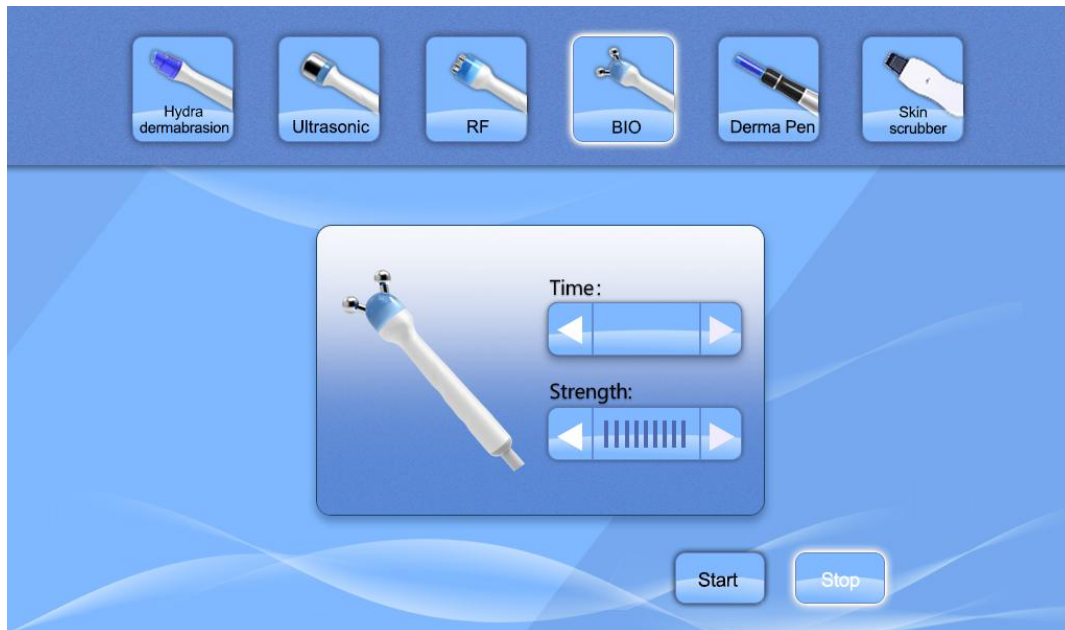

(4) BIO Interface

Microcurrent is a low level of electricity that mirrors the body's own natural electrical impulses. It is a non-surgical, non-invasive cosmetic technique that safely and effectively improves the health and appearance of the skin. When used in conjunction with specialized products a manual manipulations, these tiny microcurrent impulse encourage your body's currents at a cellular level. The signs of aging are greatly reduced, while skin tone and elasticity are dramatically improved.

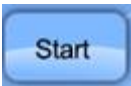

① Working time setting, click  to adjust the treatment time(1-60min).

② Power setting: click  to adjust the intensity.

③ Click  to start operation and  to end.

(5) Derma Pen Interface

A device for puncturing skin-penetrating drugs or cosmetics supports with a micro-needle guided between extended and retracted positions.



Preparation:

- ① Take out needle cartridge in the sterilized packing.
- ② Fitting round slots 1 into 2 of machine, push needle cartridge horizontally up to the end.

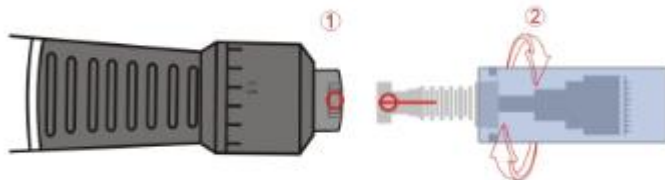

- ③ Lock the cartridge by turning it to the counter clockwise.
- ④ Adjustment of needle length should be done after turn on the machine.
- ⑤ If you want to remove the needle cartridge, turn it to the clockwise and push out horizontally, fitting round slots(slot 1, slot 2) together.

Adjustment of needle length

You can adjust the length of needle by turning the adjustment ring clockwise or counter clockwise. Turning it clockwise, length of it will be longer. Turning it counter clockwise, length of it will be shorter.



Adjustment of Speed and ON/OFF

Turn on speed level ring (Face 1-4, Body 5-6)

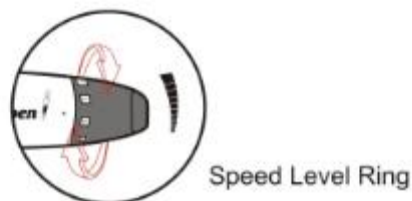

5 speed level control: Pressing the switch 2 seconds to open the device. It starts from the lowest speed to highest speed when you turn on the power firstly. The speed cycles low to high. Please press the switch 2 seconds when you need to stop the device. The flicker frequency of light faster, the speed is higher.

Region	Thin Skin	Thick Skin
Forehead	0.25 – 0.5mm	0.5 – 0.75mm
Between Eyebrow	0.25 – 0.5mm	0.5 – 1.0mm
Nose	0.25mm	0.5mm
Eye Area	0.25mm	0.25 – 0.5mm
Cheek Bone	0.5mm	0.5 – 1.0mm
Cheek and Chin	0.5 – 1.0mm	1.0 – 2.0mm
Upper Lip	0.25mm	0.25 – 0.75mm
Facial Scarring	1.0 – 1.25mm	1.5 – 2.0mm
Stretch Mark	1.5 – 2.0mm	1.5 – 2.0mm
Surgical & Burn Scars	2.0 – 3.0mm	

(6) Skin Scrubber Interface

With Ultrasonic Scrubber begins a new generation of aesthetic soft peeling. Using the high performance of ultrasounds, this exciting cosmetic breakthrough provides a safe painless and perfect physiological skin regeneration. By removing the superficial scaly layers of the skin, the Scrubber stimulates the revival of the skin tissue rendering it youthful and luminous from the first treatment.

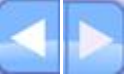

① Working time setting, click  to adjust the treatment time(0-60min).

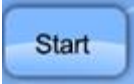
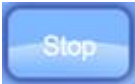
② Click  to start the operation and  to end.

Operation Steps:

A. Click the "ON/OFF" button to open the skin scrubber. When turned it on, the indicator light will be on and there will be a shock.

B. The "VOL" button is used for selecting different modes and energy.

C. P- Indicator light

L- Low energy, continuous mode

Z- Medium energy, continuous mode

H- High energy, continuous mode

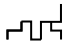
 Medium energy, pulse mode







D. Press the "VOL" button to select the working mode the customer can accept.



When the suction bottle is full, you will see the following interface and the machine will automatically stop, please empty the bottle regularly.



5. Spare Parts

Hydra dermabrasion handle		BIO	
Ultrasonic		Six polar RF	
Derma Pen		Skin scrubber	
Hydra dermabrasion tips			

6. Parameters

Working handles	Hydra dermabrasion, Ultrasound, BIO, RF, Skin scrubber, Derma Pen	
Screen	10.4 inch touch screen	
Vacuum	90Kpa	
Ultrasonic	1MHz	
RF	1MHz	
Skin scrubber	100 – 240VAC, 50/60Hz	
Derma Pen	Needle length	0.25 – 3mm(Adjustable)
	Speed control	6 levels
	Max speed	15000times/min
	Needle number	9/12/36/42 needles
Voltage & frequency	AC220 – 240V; 50/60Hz	
Power	250W	
Package size	61cm*42cm*115cm	

7. Contraindications:

- (1) The people who have heart disease need to use heart rhythm device, hypertensive patients.
- (2) The people who has acute inflammation, deep venous thrombosis, goiter, asthma, cancer and other patients
- (3) The people who's Vascular rupture Hemorrhage is traumatic and the wound is bleeding.
- (4) The pregnant women
- (5) The people who ever done the cosmetic surgery and there are filler in the body area
- (6) The people who has metal materials in the body (including metal teeth)
- (7) The people who has skin inflammation, body swollen
- (8) The people who has immune system dysfunction
- (9) The people who feels the numbness and do not respond to heat.

8. Product Service and Maintenance

- (1) Warranty: The warranty date is 1 years from the date of purchasing. We are responsible for the maintenance in our facility in GZ. When the warranty date is expired, we will charge the service fee or the cost of the component.
- (2) Professional Use: The merchandise of our Products is designed for professional use only and must be installed by a licensed professional electrician only. Failure to do so will void customer warranty.
- (3) Manufacturer Defects: In the event of defects immaterial and workmanship our obligation shall be limited to free labor and parts repair or replacement, solely a tour option, of any defective part for a period of one year from the date of purchase.
- (4) Disclaimer of Damages: The remedies provided here in are the buyer's sole and exclusive remedies and in no event shall our products be liable for direct, indirect, special, incidental, or consequential damages (including loss of profits)whether based on contract, tort, or any other legal theory.
- (5) Shipping Policy: For your protection, the acceptance of this shipment by the Transportation Company is an acknowledgement that the articles were delivered to them in good working condition and properly packed.
- (6) Exceptions
 - Inappropriate damage such as: dramatic impact, vibration, drop, condenser chamber burning, crystal rods destroying, etc.
 - Inappropriate damage or loss of key components such as the handpiece, protective glasses, power lines, you will be charged for the cost of accessories.
 - Consumer who repairs the machine caused by improper by himself.
 - Due to irresistible forces(such as fires, earthquakes and other natural disasters) of damage.
 - Beyond the period of warranty products.

For Derma Pen

(1) General maintenance

- Keep it with its power off. Wipe its surface out with a dry cloth.
- Keep it away from direct sunlight or high temperature and humidity.
- Do not leave the measurement, repair or alter of the device to non-professional staff.

(2) Routine inspection

- Make sure to inspect the device and adapter before use.
- Inappropriate damage or loss of key components such as the handpiece, protective glasses, power lines, you will be charged for the cost of accessories. When you use the device which has not been used for a long time, make sure to check if it works properly with safety.

Abnormal phenomenon	Solutions
Warning sound after clicking “START”	1 The probes and the cable, the probes and the machine is well connected or not. 2 Contact after-sales service if warning sound continues after connection.
The vacuum power is low	1 The pressure regulating knob is in the lowest level or not. 2 The connecting part of probe is clean or not. 3 Contact after-sales service if problem still exists.
The RF output is low or none in use	1 The RF intensity is in the lowest level or not. 2 Contact after-sales service if problem still exists.
The vacuum cable cannot pull out from the host machine	Press the upper and lower part of the cable and pull out lightly and simultaneously.
Abnormal vacuum mode	1 The bottle is empty or not. 2 The vacuum cable is bent or under heavy weight or not.
Touch button is abnormal	1 Restart the machine and try again. 2 Contact after-sales service if problem still exists.
Hot wind in the back of the machine	1 It’s normal because a fan is in the back. 2 Do not put the machine near the wall or in unventilated corners
The machine cannot start	1 The power cable is connected or not. 2 The main power button and the push button is open or not. 3 Make sure that the fuse in the socket is burned or not. If burned, replace it with the spare fuse in the socket. 4 Contact after-sales service if problem still exists.