

说明书: 单色双面印刷
材质: 128克铜板纸
成品尺寸: 105X80mm

HXSJ

Instructions

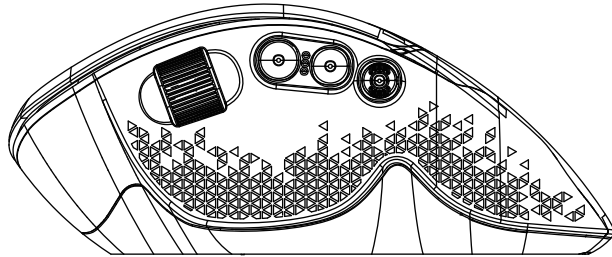

T32 | **WIRELESS MOUSE** 
Wireless technology: 2.4GHz

HOW TO USE:

Power Supply
ON / OFF

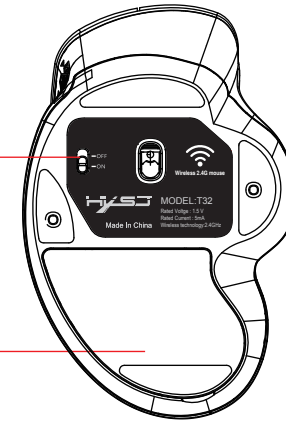
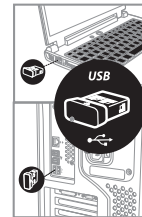

Open the battery cover and remove the micro receiver installed on the bottom of the mouse.
Plug the receiver into your computer's free USB port.

SPECIFICATIONS:

Brand: HXSJ
Model: T32
Color Classification: Black / Silver
Wireless technology: 2.4GHz
Wireless distance: 10m
Gross weight: 98±10 g
Item Size: L125*W80*H55(mm)

Package includes:
1 x Mouse
1 x USB Receiver
1 x English User Manual

Micro switch life: 10 million times
Number of keys: 6 keys
Battery type: 1 * AA batteries (not included)
Work: Photoelectricity
Rated voltage / current: 1.5V/5mA
Four-speed DPI switching: 800~1600~2400~3600DPI
System Requirements: Windows 98/Me/2000/XP/Vista/
Win 7/Win8/win10 or latest.

T32 
Wireless 2.4G

TECHNICAL PARAMETERS:

1. Can be a key control: power switch.
2. Enjoy 2.4G wireless technology, office casual games applicable.
3. Innovative aluminum side roller design.
4. Vertical side horizontal operation design, bid farewell to the "mouse hand"..
5. Wireless receiver, can be received within 10 meters of wireless.

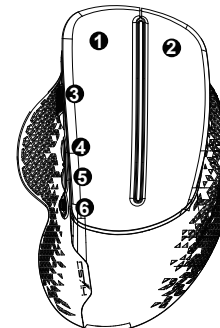

①. Left Button
②. Right Button
③. Middle button

④. Forward
⑤. Backward
⑥. DPI Loop+/-