

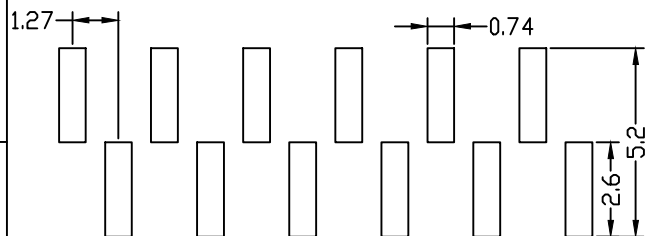

1.27mm Pin Header Single Row SMT Type W:2.5

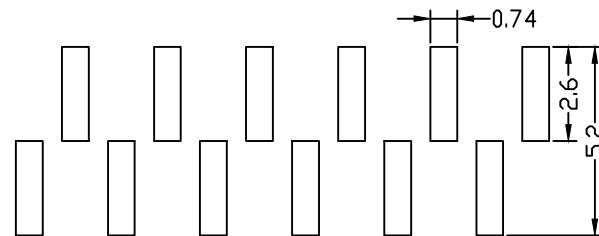

TYPE A
PCB LAYOUT



TYPE B
PCB LAYOUT

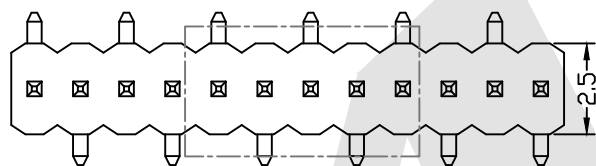

TYPE A

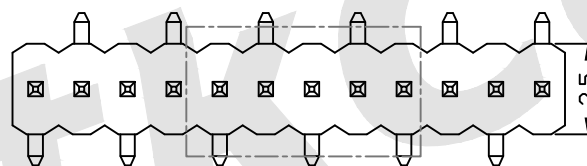

TYPE B

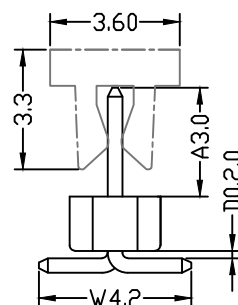
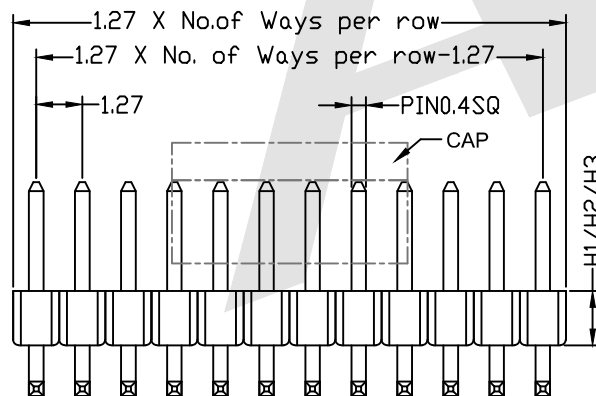

SPECIFICATION

Current Rating:	1Amp
Insulation Resistance:	1000M ohms min
Contact Resistance:	20M ohms max
Dielectric Withstanding:	AC500V
Operating Temperature:	-65°C to +125°C
Contact Material:	Brass
Insulator Material:	PA6T, UL 94V-0 Black

Ordering Code:

PHCM04 - X - X - S - A-D-W - X - X - X - X
 ① ② ③ ④ ⑤ ⑥ ⑦ ⑧ ⑨

- ① Series No:
- ② No. of Contacts
01 To 50
- ③ Contact Plating:
G0: Gold flash S0: Selective
G1: 3u" Gold S1: Selective 3u"
G2: 5u" Gold S2: Selective 5u"
G3: 10u" Gold S3: Selective 10u"
G4: 15u" Gold S4: Selective 15u"
G5: 30u" Gold S5: Selective 30u"
SN: Tin
- ④ Connector Type
S: Single
- ⑤ Pin Length:
A: 0300=3.00mm
D: 0020=0.20mm
W: 0420=4.20mm
Please mark the desired length in the A/D/W
- ⑥ Insulator Material
B: PA6T
C: LCP
E: PA9T
- ⑦ Packing
A: Tray B: Bag
T: Tube
U: Tube+CAP
R: Tape&Reel
W: Tape&Reel+CAP
- ⑧ Plastic High
H1: 0.65mm
H2: 1.5mm
H3: 2.0mm
- ⑨ PCB Layout Option
A: Type A
B: Type B

Unless Otherwise specified tolerance	
X. XX: ±0.20	X. XX: ±0.20
X. X: ±0.25	X. XXX: ±0.15

SCALE: As Shown	UNIT: mm
DRAW ZLA	DATE 24/04/2022
CHECK BobYang	DATE 24/04/2022

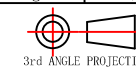

Atkconn® ATKCONN ELECTRONICS CO., LTD
[Http://www.atkconn.com](http://www.atkconn.com)

TITLE: 1.27mm Pin Header Single Row SMT Type
 (W=2.5,H=0.65,1.5,2.0)

DRAWING NO: PHCM04-XXS-0300-0020-0420-XXXX

PRODUCT NO: PHCM04-XXS-0300-0020-0420-XXXX

REV	DESCRIPTION	DATE