

HSF

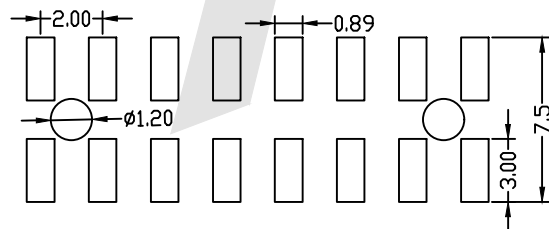

ROHS

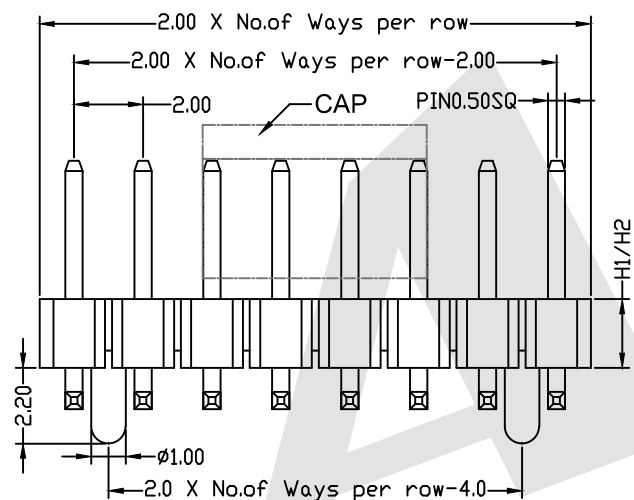
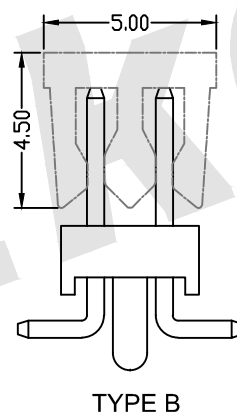
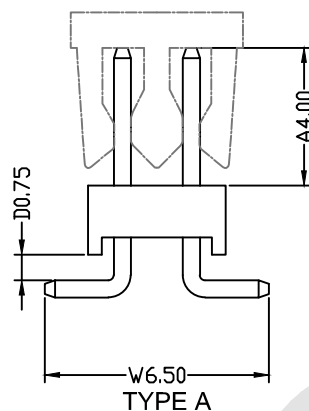
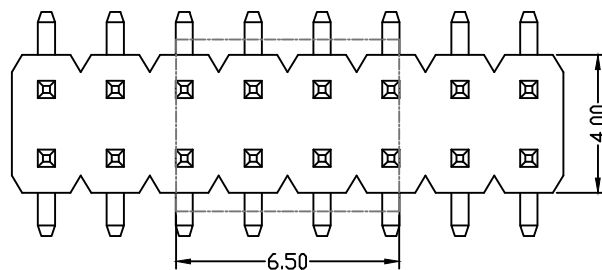

PCB LAYOUT

SPECIFICATION

Current Rating: 1.5 Amp
 Insulation Resistance: 1000M ohms min
 Contact Resistance: 20M ohms max
 Dielectric Withstanding: AC500V
 Operating Temperature: -65°C to +125°C
 Contact Material: Brass
 Insulator Material: PA6T,UL 94V-0 Black

Ordering Code:

PHDM05 - X - X - D - A - D - W - X - X - X - X
 ① ② ③ ④ ⑤ ⑥ ⑦ ⑧ ⑨

- ① Series No:
- ② No. of Contacts: 02 To 80
- ③ Contact Plating:
 G0: Gold flash S0: Selective
 G1: 3u" Gold S1: Selective 3u"
 G2: 5u" Gold S2: Selective 5u"
 G3: 10u" Gold S3: Selective 10u"
 G4: 15u" Gold S4: Selective 15u"
 G5: 30u" Gold S5: Selective 30u"
 SN: Tin
- ④ Connector Type: D: Dual
- ⑤ Pin Length:
 A: 0400=4.00mm
 D: 0075=0.75mm
 W: 0650=6.50mm
 Please mark the desired length in the A/D/W
- ⑥ Insulator Material:
 A: PBT B: PA6T
 C: LCP D: PA46
 E: PA9T
- ⑦ Packing:
 A: Tray
 B: Bag
 T: Tube
 U: Tube+CAP
 R: Tape&Reel
 W: Tape&Reel+CAP
- ⑧ With locating pegs option:
 A: Type A without pegs
 B: Type B with pegs
- ⑨ Plastic High:
 H1: 1.5mm
 H2: 2.0mm

Unless Otherwise specified tolerance
 X. XX: ± 0.20
 X. X: ± 0.25 X. XXX: ± 0.15
 X. ± 0.35

SCALE: As Shown UNIT: mm
 DRAW: ZLA DATE: 24/04/2022
 CHECK: BobYang DATE: 24/04/2022

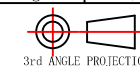

Atkconn® ATKCONN ELECTRONICS CO., LTD
[Http://www.atkconn.com](http://www.atkconn.com)

TITLE:
 2.00mm Pin Header DualRow SMT Type

DRAWING NO: PHDM05-XXD-0400-0075-0650-XXXX
 PRODUCT NO: PHDM05-XXD-0400-0075-0650-XXXX

REV	DESCRIPTION	DATE
1		
2		
3		
4		
5		