

3D VIEW

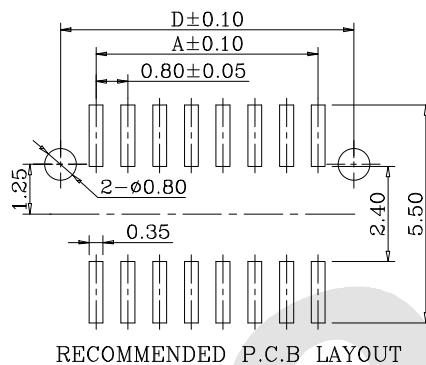

RECOMMENDED P.C.B LAYOUT

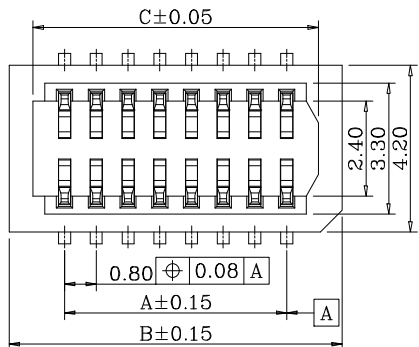
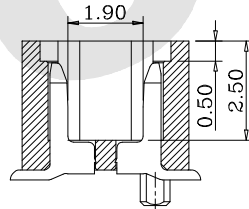
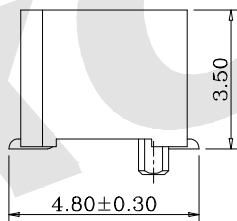
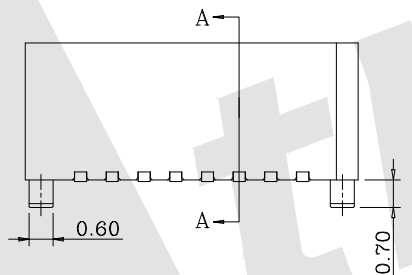

SECTION: A-A

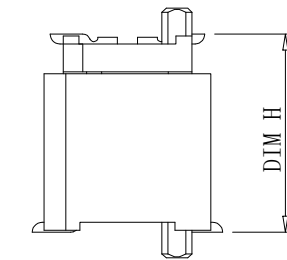
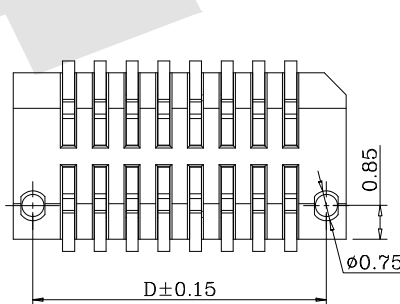

MATING HEIGHT: 4.50mm

- 1 Specification
- a.1 Current rating: 0.5A AC/DC
 - a.2 Voltage rating: 50V AC/DC
 - a.3 Contact resistance: 20m milliohms max
 - a.4 Insulation Resistance: 100Mega ohmsmin
 - a.5 Withstanding voltage: 500VAC/minute
 - a.6 Temperature range: -25°C to +80°C
2. Material and plating
- b.1 Insulator: PA9T, plastic (UL94V-0)
 - b.2 Contact: Brass
 - b.3 Finish: Gold plated

Ordering Code:

BB0.8 - F - X - X - X - X - 01V Δ
① ② ③ ④ ⑤ ⑥ ⑦

- ① Series NO:
0.8mm Board to Board connector
- ② M: Male F: Female
- ③ mating Height:
H: 4.5-4.50mm
H: 5.0-5.00mm
- ④ NO. of contacts:
see table
For example
24: 24poles
- ⑤ Contact Plating
G0: Gold flash
G1: 3u" Gold
G2: 5u" Gold
G3: 10u" Gold
G4: 15u" Gold
G5: 30u" Gold
SN: Tin
- ⑥ Packing
T: Tube A: Tray
B: Bag U: Tube+CAP
R: tape&Reel
W: tape&Reel+CAP
- ⑦ serial number: 01V Δ

CIRCUITS	DIM A	DIM B	DIM C	DIM D
2x5	3.20	6.00	4.80	5.00
2x6	4.00	6.80	5.60	5.80
2x7	4.80	7.60	6.40	5.60
2x8	5.60	8.40	7.20	7.40
2x9	6.40	9.20	8.00	8.20
2x10	7.20	10.00	8.80	9.00
2x11	8.00	10.80	9.60	9.80
2x12	8.80	11.60	10.40	10.60
2x13	9.60	12.40	11.20	11.40
2x14	10.40	13.20	12.00	12.20
2x15	11.20	14.00	12.80	13.00
2x16	12.00	14.80	13.60	13.80
2x17	12.80	15.60	14.40	14.60
2x18	13.60	16.40	15.20	15.40
2x19	14.40	17.20	16.00	16.20
2x20	15.20	18.00	16.80	17.00
2x21	16.00	18.80	17.60	17.80
2x22	16.80	19.60	18.40	18.60
2x23	17.60	20.40	19.20	19.40
2x24	18.40	21.20	20.00	20.20
2x25	19.20	22.00	20.80	21.00

Unless Otherwise specified tolerance
 X. ±0.35 X.XX: ±0.20
 X.X: ±0.25 X.XXX: ±0.15

SCALE: As Shown	UNIT: mm
DRAW ZLA	DATE 24/10/2022
CHECK BobYang	DATE 24/10/2022
VER. A0	

Atkconn® ATKCONN ELECTRONICS CO., LTD
[Http://www.atkconn.com](http://www.atkconn.com)

TITLE: 0.8mm Board to Board connector, female,
 mating Height=4.5-5.0mm

DRAWING NO: BB0.8F-XXXX01V

PRODUCT NO: BB0.8F-XXXX01V

REV	DESCRIPTION	DATE