

INSTALLATION SHEET

Thank you for using our led emergency twin spot lights. This Double Head Led Emergency Light is recommended for Commercial Lighting Fixture widely use in Hotel, Office, Public Buildings, Apartment Buildings, shopping mall, etc. Which can be used as emergency lighting in the case of electric outage. These instructions should be read carefully & retained after installation for future reference & maintenance.

INSTRUCTION

MODEL#: NA07-TS-39

- 2*8W Two LED Head Emergency Light Combo LED Exit Light
- 360 degree rotated Lamp Cap, Flexible
- 30degree side down
- High brighten LED light, efficient reflector
- Easy mounted back hole big iron handle
- Large Capacity Battery Box Internal.
- Waterproof Design. IP65 grade



SPECIFICATION

Input Voltage	AC85-265V/50-60HZ	Battery Type	6V 4500mAh Lead-acid battery
Wattage	2*8W	Dimension	22.5*6.5*31.5cm
Emergency Luminous	520LM	Protection Grade	IP65
Emergency Conversion Time	<5S	Charging time	24hours
Working Temperature	-10~50°C	Emergency time	180mins
Warranty	2 years		

INSTALLATION

Step1: Isolate mains power supply

Step2: Follow the wiring instructions below

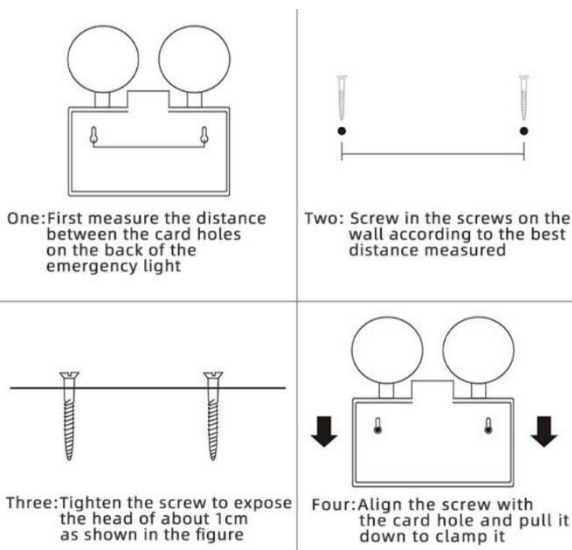

Step3: Ensure that all electrical connections are firm with no loose strands and secure the cable with the anchor provided.

Step4: Open the mains power, Lights on the LED lamp switch on/off to control lights. Check the emergency function, cut off the main supply, led lamp switch to emergency output immediately.

INDICATOR:

Green LED indicator is on that shows main power is on, when emergency function, green light is off

CUSTOMIZED

Pattern Design	Available, please send us your design artwork
LOGO Printing	Available on Packaging box, or sticker on the product
Packaging	10pcs per carton, carton size: 48*33.5*44cm, carton weight: 7/9kg

NOTICE:

When using electrical equipment, basic safety precautions should always be followed including the following:

- Before commencing installation or servicing, turn off and isolate the circuit to be worked on by removing the fuse or switching the circuit breaker off at the distribution board.
- This product is suitable for connection to a 85-265Vac 50/60Hz supply.
- The emergency fitting is not suitable for use on a battery supply, trickle or intermittent re-charging circuit.
- The emergency fitting is not protected against supply voltage polarity reversal.
- The recharging device will recharge the battery normally after removal of a battery short-circuit.
- When cutting holes, drilling or screwing take care not to damage existing wiring or pipework.

STORAGE:

If the emergency light is not used for over 3 months, it should be connected to AC power for full charging and discharging (until LED lamp is completely off). Then keeping the emergency driver on main power for 24 hours and put it in dry ventilated place.



The Waste Electrical & Electronic Equipments regulations (WEEE) requires that products bearing this symbol must not be disposed of with household waste as they may contain substances harmful to the environment. The local authority can provide advice on recycling.