

Dimension of PV Modules Unit: mm

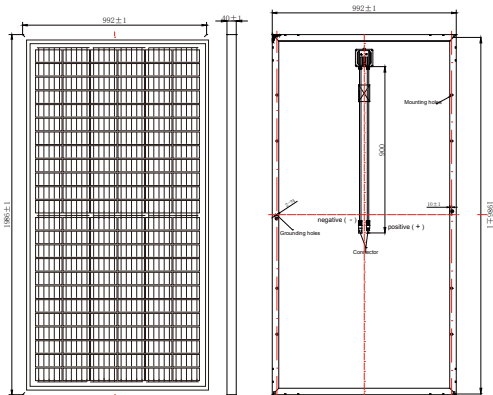

ELECTRICAL DATA(STC)

	335W	340W	345W	350W	355W	360W
Rated Power in Watts-Pmax(Wp)	335W	340W	345W	350W	355W	360W
Open Circuit Voltage-Voc(V)	47.30V	47.5V	47.6V	47.70V	47.80V	47.90V
Short Circuit Current-Isc(A)	9.13A	9.22A	9.32A	9.42A	9.52A	9.62A
Maximum Power Voltage-Vmp(V)	37.99V	38.2V	38.30V	38.40V	38.5V	38.60V
Maximum Power Current-Imp(A)	8.82A	8.90A	9.00A	9.11A	9.22A	9.32A
Module Efficiency (%)	17.00%	17.26%	17.51%	17.77%	18.02%	18.27%

STC: Irradiance 1000 W/m², Cell Temperature 25°C, Air Mass AM1.5 according to EN 60904-3.

ELECTRICAL DATA(NOCT)

	250W	255W	258W	261W	265W	269W
Maximum Power-Pmax (Wp)	250W	255W	258W	261W	265W	269W
Open Circuit Voltage-Voc (V)	44.00V	44.20V	44.30V	44.40V	44.5V	44.60V
Short Circuit Current-Isc (A)	7.45A	7.53A	7.62A	7.71A	7.80A	7.89A
Maximum Power Voltage-Vmp(V)	35.40V	35.6V	35.70V	35.80V	35.90V	36.00V
Maximum Power Current-Imp(A)	7.07A	7.15A	7.22A	7.30A	7.39A	7.47A

NOCT: Irradiance at 800 W/m², Ambient Temperature 20°C, Wind Speed 1 m/s.

MECHANICAL DATA

Solar cells	Poly Half-Cell 156.75x78.37mm, 5 Bus bars
Cell configuration	144 Cells (6x24)
Module dimensions	1986x992x40mm
Weight	23KGS
Front Cover	3.2mm Tempered Glass
Frame Material	Anodized Aluminum Alloy
J-BOX	IP68, 3 Diodes
Cable	4mm ² (IEC)/12AWG(UL),1000mm
Connectors	MC4 or MC4 Comparable
Standard Packaging	26pcs/pallet

TEMPERATURE & MAXIMUM RATINGS

Nominal Operating Cell Temperature (NOCT)	45°C±2°C
Temperature Coefficient of Voc	-0.32%/°C
Temperature Coefficient of Isc	0.05%/°C
Temperature Coefficient of Pmax	-0.39%/°C
Operational Temperature	-40~+85°C
Maximum System Voltage	1500V(IEC)/600V(UL)
Max Series Fuse Rating	20A

PACKAGING CONFIGURATION

	40HQ	20GP
Modules per container Package	696pcs	260pcs
Package Number	26pcs/pallet,2pcs/carton	26pcs/pallet
Package Weight	24pallets + 36cartons	10pallets

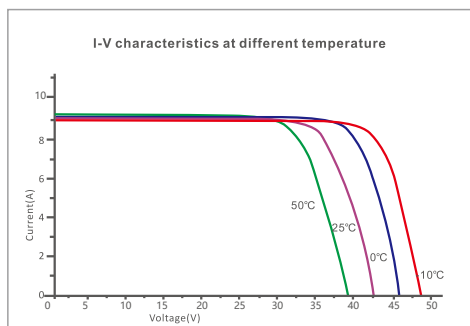
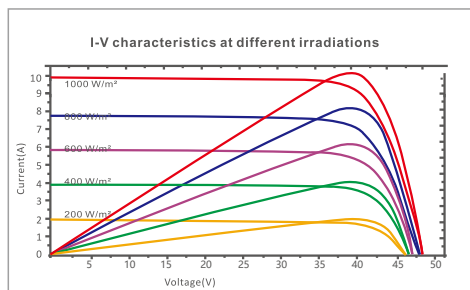



RS6I-P

144 Cells
 Poly Half-Cell

335-360W
 Power output

18.27%
 The Highest Efficiency

0~+5W
 Tolerance

WWW.RESTARSOLAR.COM

Half-cell high-efficiency solar panel is cutting cells One divides into two,it could reduce thermal resistance,improve output power 5-10W;it could meet 1500V whole system voltage design demand and reduce whole system cost 10%. In comparison to full solar cell modules,this one cells subfissure,power attenuation and sunshine occlusion is more lower;and excellent high temperature character. It is the best choice for large ground power station,Ecological agriculture fishery project and Distributed beach project.



**HIGHER ENERGY GENERATION
 AND LOWER POWER LOSS**



ANTI HOT SPOT&PID FREE



LESS SHADING EFFECT



**APPLICABLE FOR 1500V SYSTEM,LOWER
 SYSTEM COST**



**Entire module certified to withstand high
 wind loads(2400Pascal) and snow loads
 (5400 Pascal)***

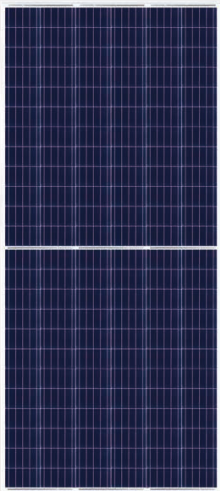

0.5% Annual Degradation over 30 years

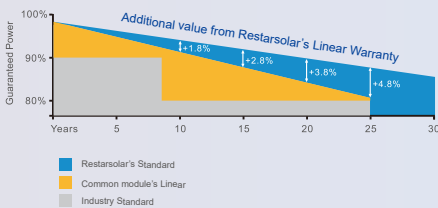

LINEAR PERFORMANCE WARRANTY
 12 year Product Warranty / 30 year Linear Power Warranty

Full range of products and certification systems
 ISO 9001 TUV PID-FREE CE IEC61215/61730/61701/62716

