



浙科模具科技有限公司

Zheke Mould Technology Co., Ltd

—— Making Worth by heart
—— 用心制造价值

Items 目录

- 1.Company Introduction 公司简介
- 2.Product Process 产品生产过程
- 3.Product Introduction 产品介绍
- 4.Company Product Vision 公司产品前景
- 5.Certificate 证书

1. Company Introduction 公司简介



Foshan Zheke Mould Technology Co., Ltd founded in 2005, and locate in Pearl River Delta Foshan city economic famous town——Shishan Town.

Company's main business is aluminum die casting mould and aluminum product R&D, design, manufacture and sale. Customers are mainly large lighting companies, automobile parts limited and machinery manufacturing company.

Zheke Mould company's predecessor is called Yongke Mould company, because of the increasing economies of scale, so Zheke mould company removal the bigger workshop and change the name.

Since the development of the company, there have been a major production six sets of CNC equipment, eight sets of cold chamber die casting machine, the maximum tonnage is 800 tons. There are other mould manufacturing equipment and die-casting post-processing equipment. The company's theoretical capacity can reach 5000 tons of aluminum/year.

Zheke Mould Company has been in the mold manufacturing industry for more than 20 years, Die casting industry over 10 years. Has many experienced technical backbone personnel.

佛山市浙科模具技术有限公司成立于2005年，位于珠三角佛山市经济名镇——狮山镇。

公司主要业务为压铸模具和铝合金产品的研发，设计，生产及销售。客户主要为大型照明公司，汽车零部件公司和机械设备制造公司。

浙科模具于2017年因生产规模扩大从南海里水搬迁过来，并把甬科模具改名为浙科模具。

公司发展至今，已有主要生产设备CNC六台，冷室压铸机8台，最高吨位为800吨，还有其他模具制造设备和压铸件后加工设备。公司理论产能可达5000吨铝/年。

浙科模具公司在模具制造行业已有20余年，压铸行业超10年，拥有多名经验丰富的技术骨干人员。



Slogan

产品理念



Our company business values is
making worth by heart

用心制造价值是浙科模具
公司的经营核心价值观



vision 愿景

To provide the best service to customers wholeheartedly is our company management idea

全心全意给客户提供最好的服务是浙科模具公司的经营理念。



Mission 使命

Our company lifelong goal is offer the best development platform for staff. Provide the best office living environment and benefits for staff.

给浙科员工最好的平台，提供最好的办公生活环境和福利是浙科模具公司的终身奋斗目标。



生产车间 Workshop





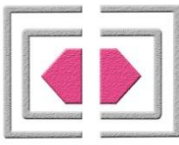

ZK MOULD



Company's legal representative profile 法人代表简介



Mr. Guozhong Chen who is the legal representative of Zheke Mould Technology Co., Ltd. He is 55 years old and from Ningbo City, Zhejiang Province.

Mr. Guozhong Chen had went to locate town company to engage in lathe work after he graduated from junior high school. After that, he went to learn mould manufacturing knowledge and technology mould in department of state-owned enterprise in Sichuan and Gansu province .

Mr. Guozhong Chen contract hardware company mold manufacturing workshop in Nanhai district, Foshan city, Guangdong province from the age of 25 to now. And he provide mould design and manufacture services for company.

Then he set up he's own mould factory, main in manufacture aluminum, zinc die casting mould design and manufacture, at the same time, he contact die casting processing technology and CNC machining process.

Foshan Nanhai Yongke Mould Hardware Co., Ltd it was founded in 2005, and this year changed the company named into Zheke Mould Technology Co., Ltd in 2017. Mr. Guozhong Chen relies on his own experience and efforts, not only a lot of technical people have been trained, but also make today's company achievements. Mr. Chen still keep fighting for this goal of Zheke mould company become a first-class die casting mould design and manufacture company all the time.

陈国忠，男，籍贯浙江省宁波市，55岁，现为佛山市南海甬科模具五金厂法人代表。

陈国忠先生初中毕业后就在本地乡镇阀门企业从事车床加工工作，后去往四川和甘肃两地国企模具部门学习模具制造知识和技术。

后从25岁至今在广东佛山市南海区先承包五金公司模具制造车间，为公司提供模具设计和制造服务；然后独自开办模具厂，主要制造铝，锌压铸模具的设计制造，同时接触压铸加工工艺和CNC加工工艺。

佛山市南海甬科模具五金厂挂牌成立于2005年至今，并于2017改名为浙科模具科技有限公司。陈国忠先生凭借自身的经验和努力，不仅培养出了许多技术人才，也造就今天的浙科。陈先生一直在为浙科能成为一家一流的压铸模具设计制造企业这个目标不断的奋斗着。

2.Product Process 产品生产过程

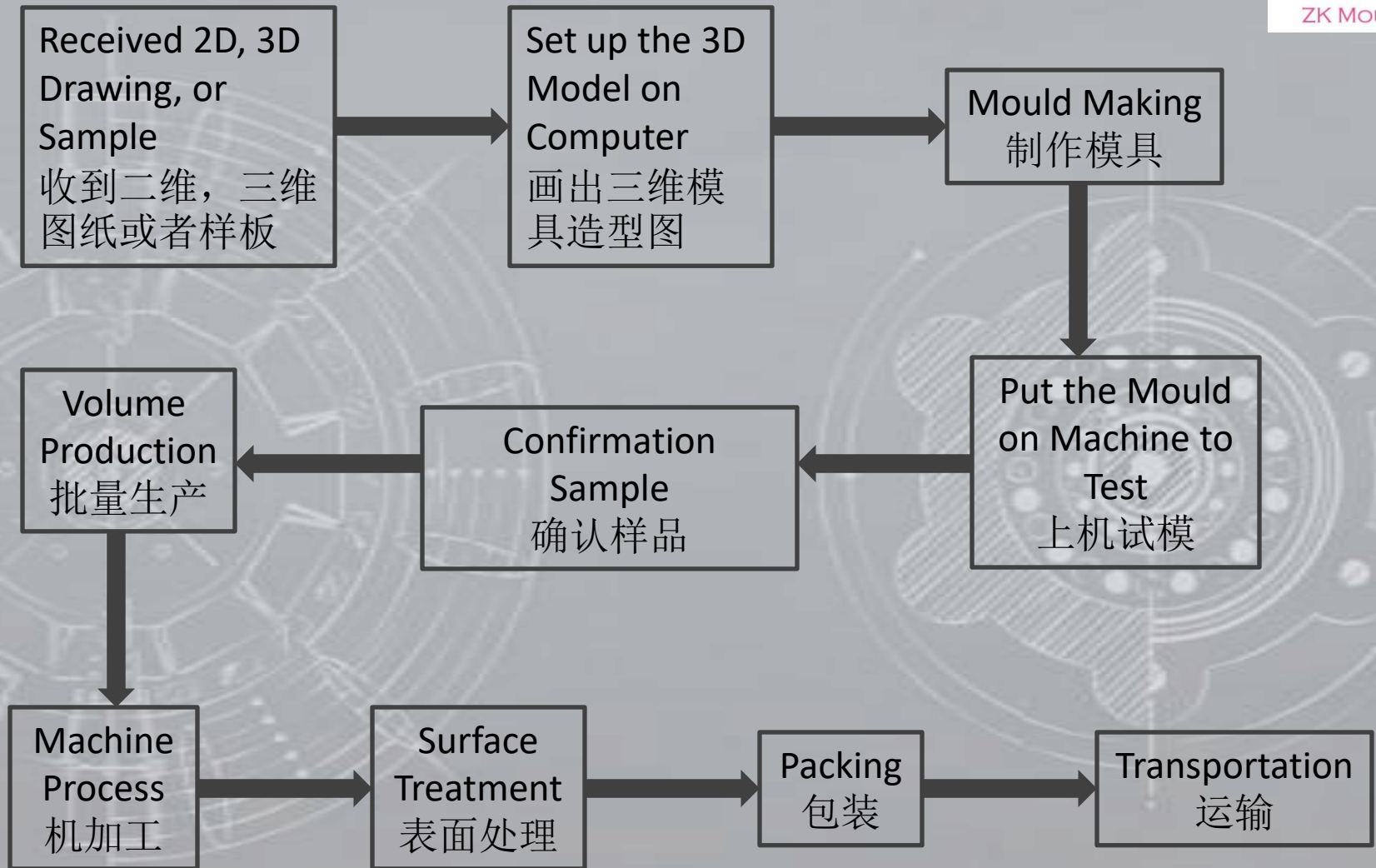

Received 2D, 3D Drawing, or Sample
收到二维，三维图纸或者样板

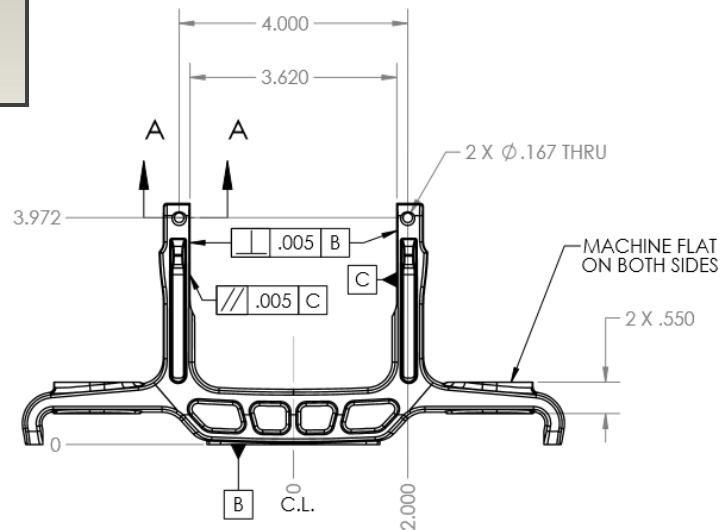
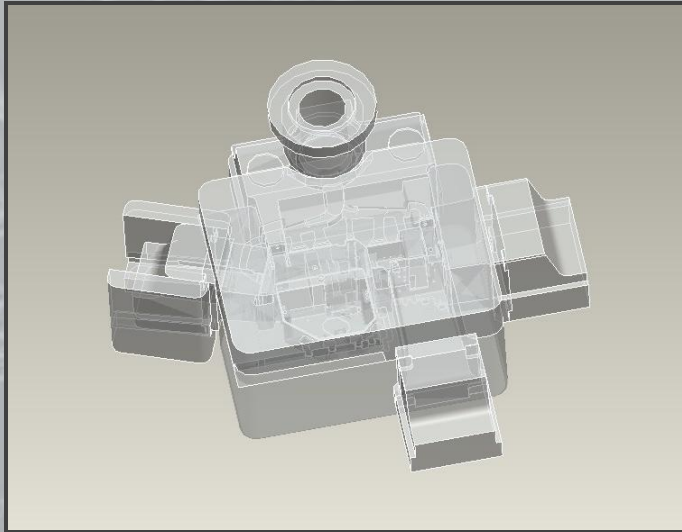

Draw the 3D Model on Computer

画出三维模具造型图

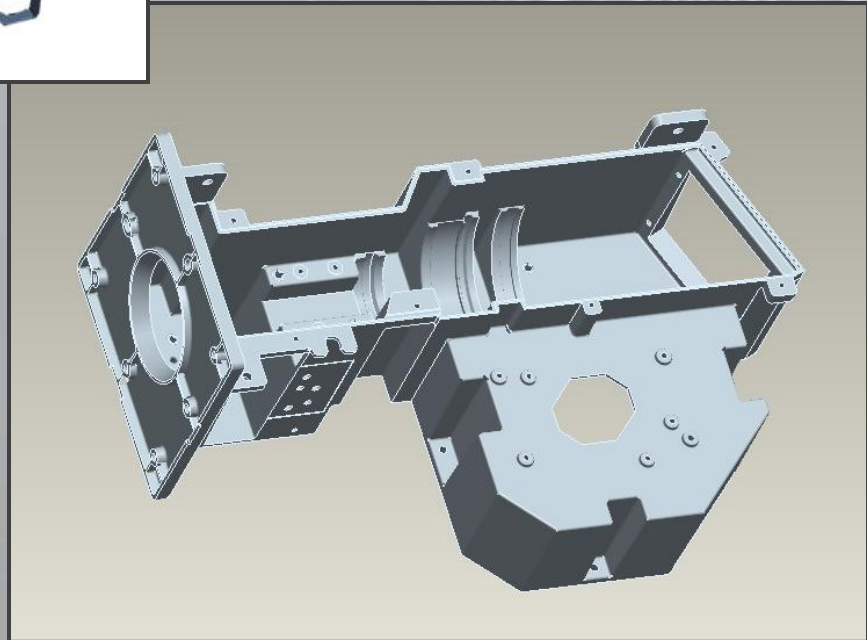
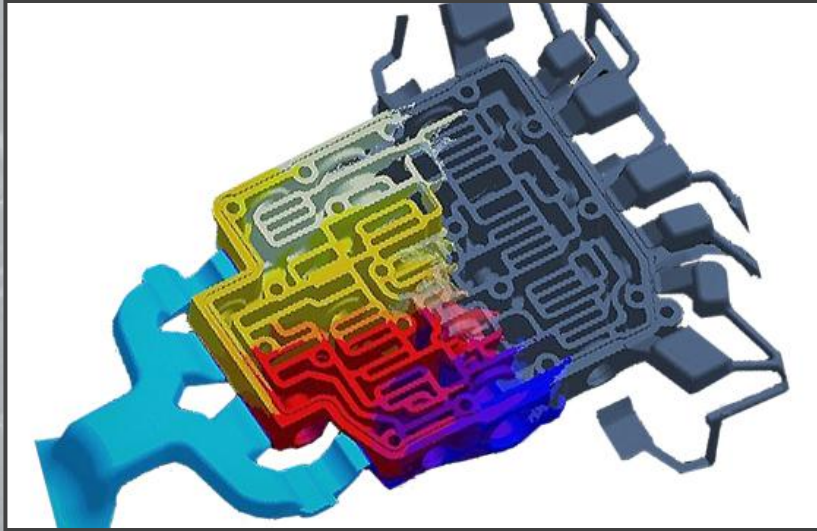

Mould Making 制作模具

Customer need to offer
sample or 2D or 3D
drawings to us for
mould making

客户必须提供样品或
者图纸用于制作模具



Mould Testing

上机试模

After mould making, then use die casting machine to make the sample, we can make constant adjustment according to customer's requirement.

制作模具后上压铸机制作样品，可根据客户的要求作出不断的调整



Sample Confirmation

样品确认

When we finish the sample making, we will call customer to confirm the sample.

If the customer unsatisfactory, we can be adjusted repeatedly until the customer is satisfied.

在完成制样后会通知客户过来确认样品，如不满意，可反复调整直到客户满意为止



Volume Production

批量生产

Volume production after
customer confirm the
sample



样品在经过客户
确认后就开始批
量生产



Machining Process

机加工

Multi-head Drilling and Tapping Machine 多头夹钻孔攻牙机

These machines Greatly
improve production
efficiency and capacity。

这些机械大大的提高生产
效率和产能的设备。

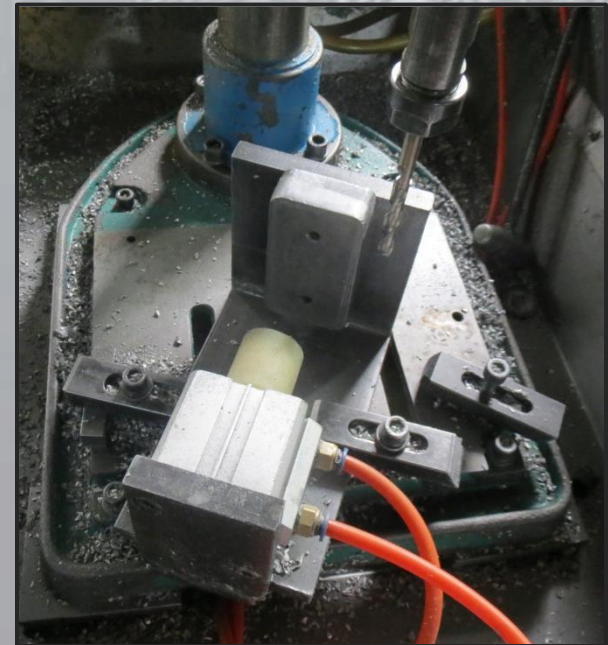

High Precision CNC Machining Center with Automatic tool magazine. 高精度数控带刀库加工中心

The accuracy can be up
to 0.01mm. The toll
magazine equipped
with 36 tools

全自动换装36把刀库，加
工精度可达0.01毫米

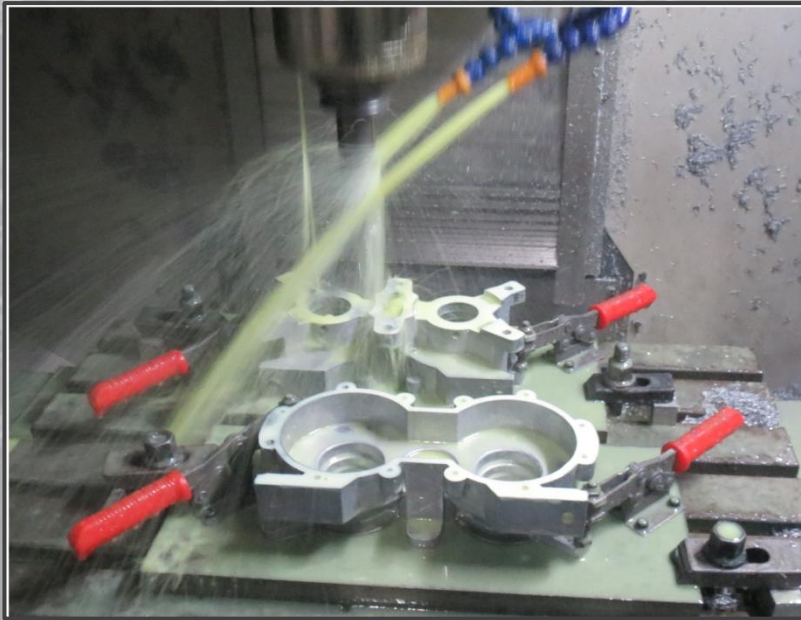

High speed and precision
CNC lathe.

高速精密数控车床

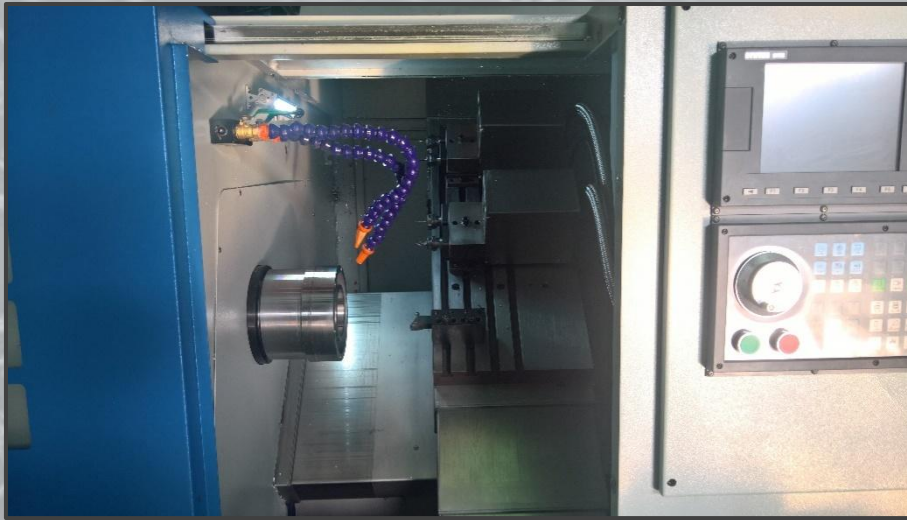

The accuracy can be up
to 1μ (0.001mm)

加工精度可达 1μ (0.001毫
米)。

Surface Treatment

表面处理

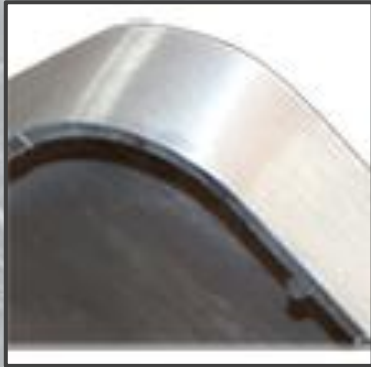

Finishing polishing

After deburring, we provide four main surface treatment services: powder coating, elect plating, shot blasting and finishing polishing.



Powder coating



Shot blasting

为毛坯打磨后根据客户要求可做喷粉,电镀,抛丸和精抛光等灯表面处理



Elect plating

Packing 包装



The workers will check and pack each product. The small product will be use carton to pack, then put on the pallet tightly by Plastic wrap. The large product will be orderliness put on the pallet tightly by Plastic wrap



每一件产品都会经过人工检查并打上包装，小件产品会用纸箱装并放在木托上用塑封围紧。大件产品会在木托摆放整齐并围紧塑封。



Transportation 运输



3.Product Introduction 产品介绍



- ◆ LED Light Part LED灯配件
- ◆ Automobile Parts 汽车配件
- ◆ Communication and Digital Parts 通信和数码配件
- ◆ Machine Parts 机械配件
- ◆ Furniture Parts 家具配件
- ◆ Household Appliance Parts 家电配件
- ◆ Other Aluminum Die Casting Parts 其他压铸铝配件
- ◆ Aluminum Die Casting Mould 压铸铝模具

◆ LED Light Part LED灯配件

1. 70-300 watt Street Light Aluminum Die Casting Housing 70-300瓦特路灯压铸体
2. 50-150 watt Workshop Light Aluminum Die Casting Housing 50-150瓦特车间灯压铸体
3. 20-60 watt Stage Light Aluminum Die Casting Heat Sink 20-60瓦特舞台灯压铸体
4. Large Size Stage Light Aluminum Die Casting Heat Sink 大型舞台灯压铸散热器

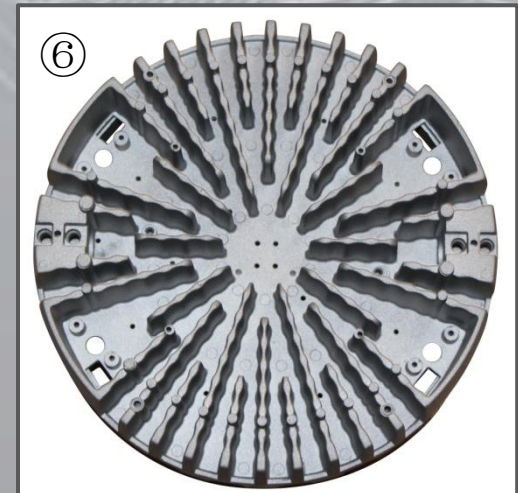
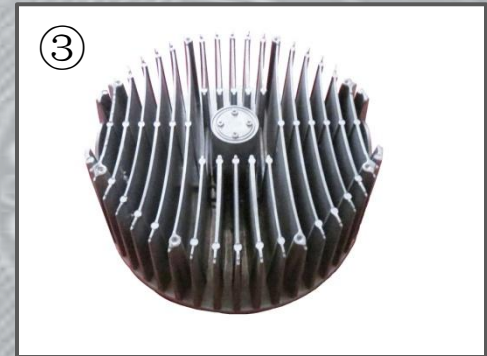
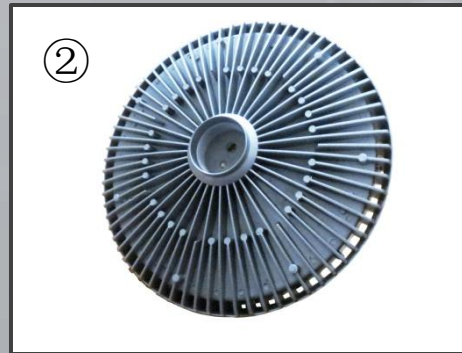

◆Automobile Parts 汽车零件

1. Automobile Aluminum Inlet and Outlet 汽车铝进气室外壳
2. Wheel Suspension 牵引控制臂（悬挂系统）
3. Automobile Air conditioner Compressor Comp（汽车空调中缸）

①



②

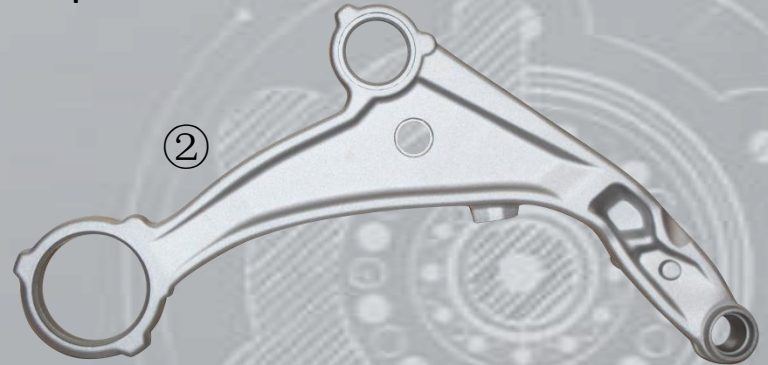

③



◆ Communication and Digital Parts

通信和数码零件



Base Plate
安装底座

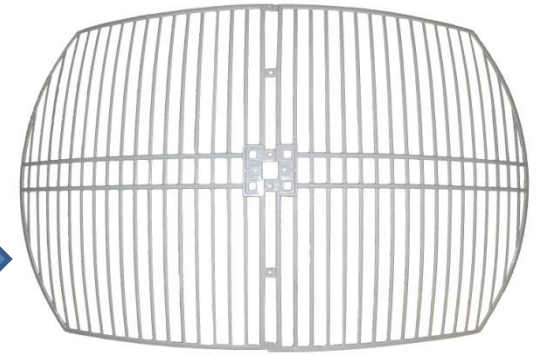

Aluminum Microwave
Antenna
铝微波天线



Industrial Communication
Device Connector
通讯装备连接件

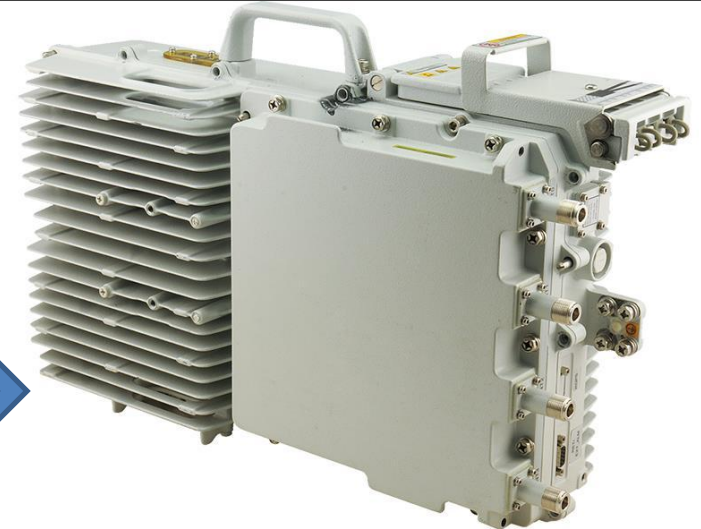

RRU Base Station
Aluminum Die Casting
Housing RRU
基站终端铝合金压铸外壳

◆ Machine Parts

机械配件



Ice Cream Machine Gearbox
雪糕机变速箱



电机外壳
Motor Housing



Draught Fan Casting
风机壳



铝合金吸盘器 铸铝手提
真空吸盘器外壳
Aluminum Suction Cup
Portable Vacuum Sucker



◆ Furniture Parts 家具配件



Chair Base
椅子底座

花园椅
Garden Chair



Drawer/ Cupboard/
Wardrobe/Cabinet
Handle
抽屉/橱柜/衣柜/柜
子把手

Aluminum Door Handle
铝门把手

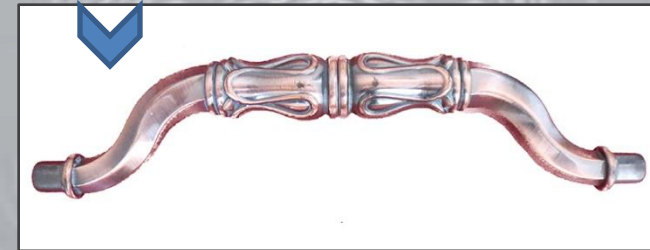

Aluminum alloy
furniture sofa feet
铝合金家具脚沙发
脚



梳妆台腿
Dresser Legs



◆ Household Appliance Parts

家电配件



Electric oven
Aluminum Bakeware
Electric Grill Plate
烤盘

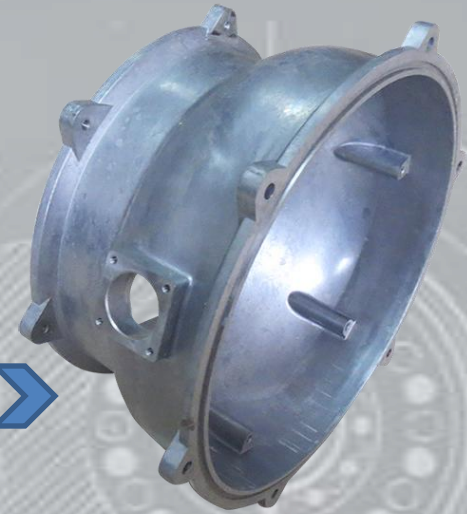

Household Round
electric Aluminum
Barbecue Pan Shell
家用电烤锅外壳



Household Vacuum Cleaner
Aluminum Housing
吸尘器外壳



Sandwich machine/
toaster machine
aluminum body shell
三明治机/烤面包机外壳

◆ Other Aluminum Die Casting Parts

其他压铸铝配件

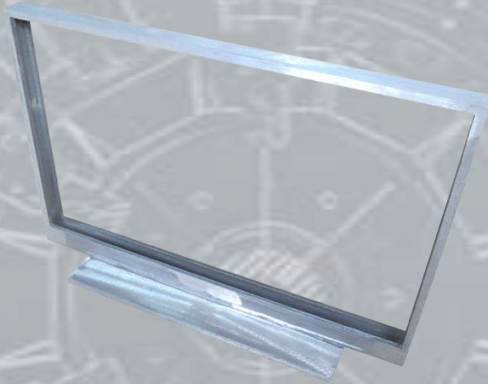

Vertical Aluminum Die Casting
Paper Frame/Photo Frame
立式压铸铝纸框/相框

Caster Aluminum Bracket
Activity Casters Bracket
Fixed Casters Bracket
铝合金铸铝脚轮支架



Precision Steel Round
Aluminum Die Casting
Steering Base

精密钢圆铝压铸转向底座



We can manufacture the
aluminum die casting
product according to
customer drawing and
sample

根据客户图纸和样品
都可以生产

Large cabinet aluminum lock
大型箱柜锁扣

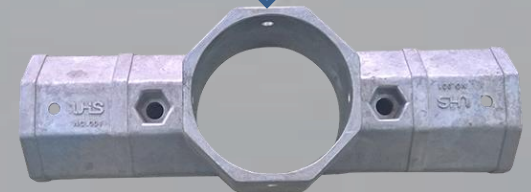

◆ Aluminum Die Casting Mould 压铸铝模具

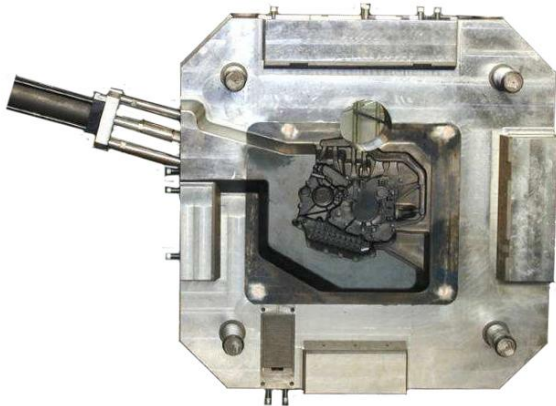

Automobile Steering Gear
Diverter Die Casting Mould
汽车转向机转向器压铸模具

Automobile Cylinder
Head Aluminum Die
Casting Mould
油缸盖压铸模具

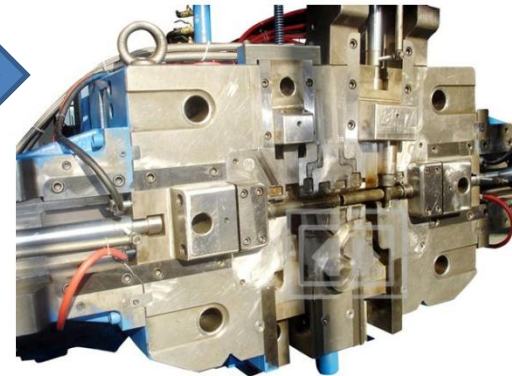

LED Light Heat Sink
Aluminum Die Casting
Mould
LED灯壳散热器压铸模具

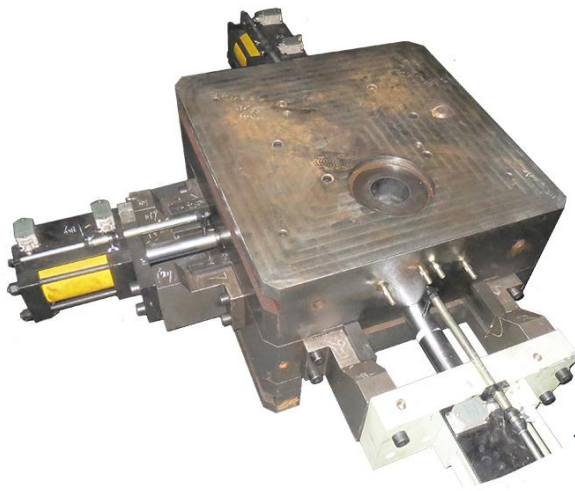

Reducer Motor Housing
Aluminum Die Casting
Mould
铝合金减速机电机外壳
压铸模具



4. Company Product Developing Vision

公司产品发展前景

Medical Apparatus Parts
医疗器械配件

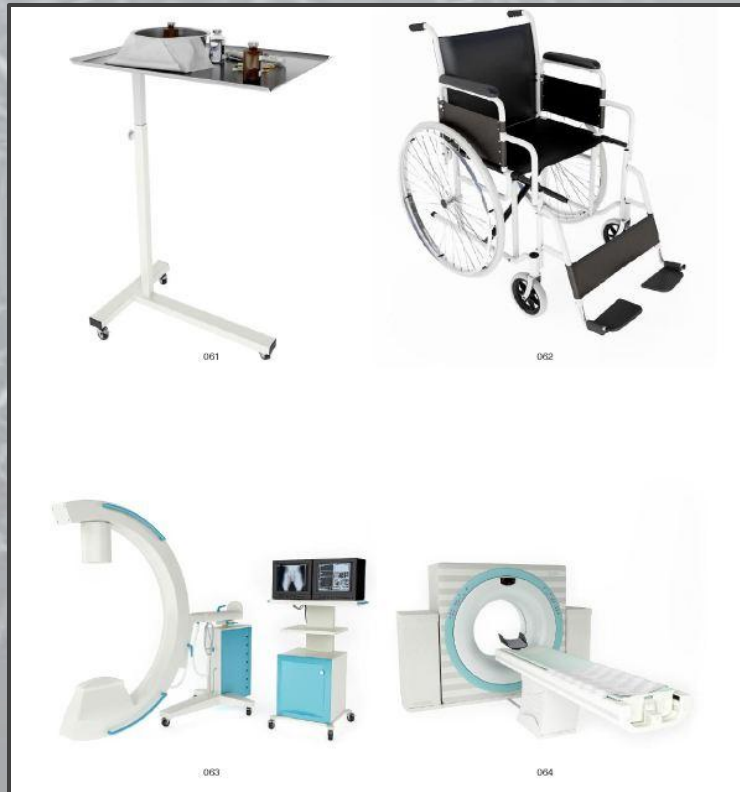

Food Machinery Parts
食品机械配件



Aviation Parts 航空配件

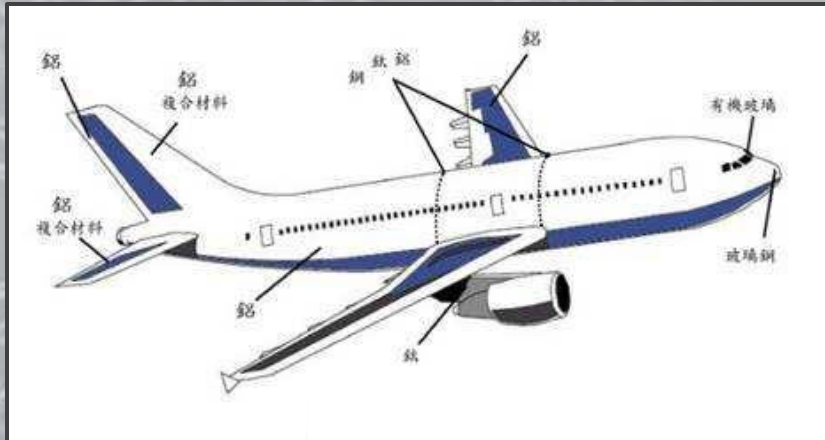

High-speed Rail Parts 高铁配件



Home building material Parts 家居建材配件



Construction Material Parts 建筑材料配件

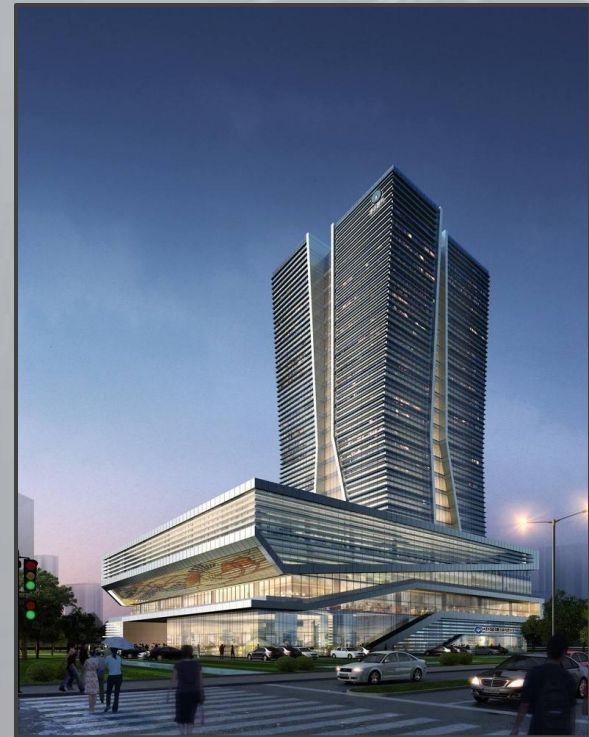

石油与能源机械部分
Oil and Energy Machine Parts



水利、环境和公共设施部分
Water, Environment , and
Public Facilities Parts



5.Certificate 证书

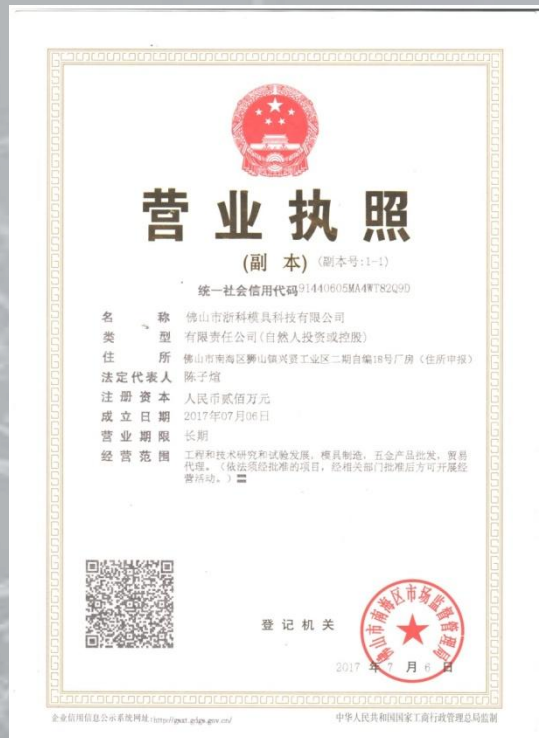

Contact Information

联系方式



Adalia Cheung
Mob: +86(0)13690380122

Zheke Mould Technolgy Co.,Ltd

Fax: +86 757 85107266

Email: adalia@zkdiecasting.com

Web: www.zkdiecasting.com

Address: Xingxian 2nd industrial park, 528200 Foshan,
Guangdong, P.R.China