

HSF

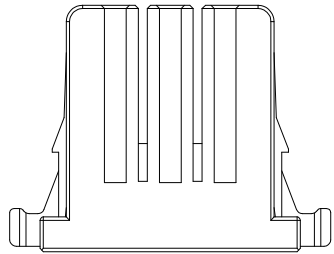

RoHS

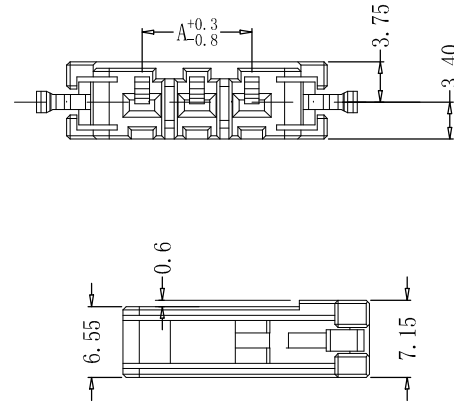
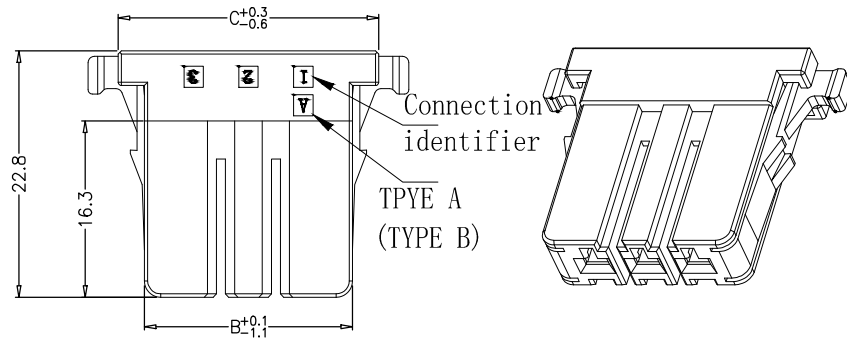

	Dimensions (mm)			Rated Current
	A	B	C	
	5.08	14.16	19.02	13A
	10.16	19.24	24.1	13A
	15.24	24.32	29.18	12.5A
	20.32	29.4	34.26	12.5A
	25.4	34.48	39.34	12A
	30.48	39.56	44.42	11.5A
	35.56	44.64	49.5	11A
	40.64	49.72	54.58	10.5A
	45.72	54.8	59.66	10A

NOTE:

Electric

Rated Voltage:600v AC, DC

Rated Current:single pole ≤16A ,See the table for details

Contact Resistance:≤10mΩ

Proof Voltage:2200V AC(1 min)

operating Temperature:-55℃ + 10℃

Materials

Wire range:AWG30~18(0.05~2.2mm<sup>2</sup>) OD≤2.4mm

Part NO. :AH5081-XP

Unless otherwise specified tolerance

X. ±0.35 X.XX: ±0.20  
X.X: ±0.25 X.XXX: ±0.15



ANTENK ELECTRONICS CO.,LTD  
Http://www.antenk.com  
E-mail:sales@antenk.com

SCALE: As Shown UNIT: mm

DRAW TMX DATE 13/01/2022

CHECK BobYang DATE 13/01/2022

TITLE:  
5.08mm dynamic housing connector

DRAWING NO: AH5081-XP

PRODUCT NO: AH5081-XP



REV DESCRIPTION

11/09/2020

DATE

1

2

3

4

5

6

7

8