

HSF

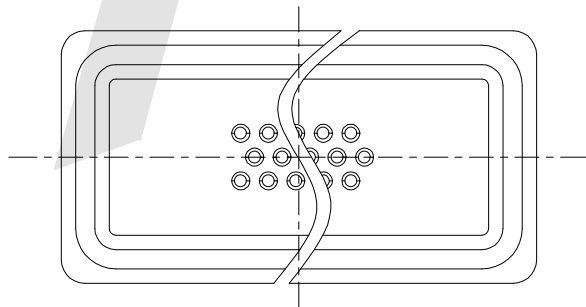

ROHS

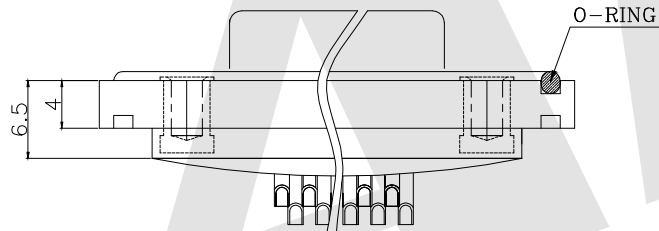
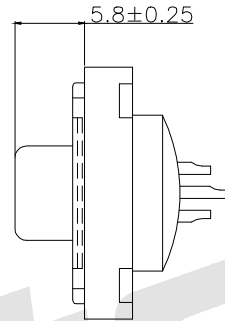
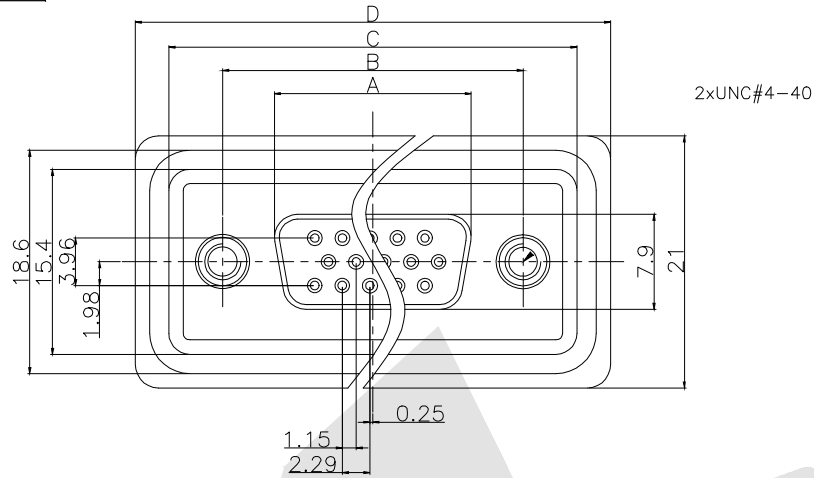

MATERIALS AND FINISH
 SHELL: STEEL, TIN FINISHED
 INSULATOR ; PBT UL94V-0 BLACK COLOR
 SIGNAL CONTACT: COPPER ALLOY , GOLD PLATED
 WATERTIGHT FRAME: PBT UL94-0 BLACK COLOR
 O-RING: SILICONE
 EPOXY SEALANT: EPOXY
 ELECTRICAL CHARACTERISTICS
 SIGNAL CONTACT CURRENT RATING 2.0 AMPS
 SIGNAL CONTACT RESISTANCE 10mΩ MAX
 DIELECTRIC WITHSTANDING VOLTAGE: 1000V AC MIN.
 INSULATION RESISTANCE :5GΩ MIN .
 TEMPERATURE RATING : - 55°C ~ + 105°C
 DEGREE OF PROTECTION: IP67 ACCORD

Ordering Code:

WHDB01 - F - XX - XX - X - X
 ① ② ③ ④ ⑤ ⑥

- ① Series
- ② Contact Type:
M:Male F:Female
- ③ Pin Number:
15 - 15PIN 26 - 26PIN
44 - 44PIN
- ④ Contact Plating
S: Selective Gold
S1: Selective 3u" Gold
S2: Selective 5u" Gold
S3: Selective 10u" Gold
S4: Selective 15u" Gold
S5: Selective 30u" Gold
G0: Gold flash G1: 3u" Gold over
G2: 5u" Gold over G3: 10u" Gold over
G4: 15u" Gold over G5: 30u" Gold over
- ⑤ Insulation Color Code:
B: Black L: Blue
W: White
- ⑥ Locked Type:
B: Rivet #4-40
C: Rivet & Rack Screw Attached
D: Rivet & Jack Screw Insert

Unless Otherwise specified tolerance
 X. ±0.35 X.XX: ±0.20
 X.X: ±0.25 X.XXX: ±0.15

SCALE: As Shown	UNIT: mm
DRAW ZLA	DATE 28/03/2022
CHECK BobYang	DATE 28/03/2022

Antenk ANTENK ELECTRONICS CO., LTD
 Http://www.antenk.com
 E-mail: sales@antenk.com

TITLE:
 D-SUB FEMALE STRAIGHT WATERPROOF TYPE

DRAWING NO: WHDB01-FXXXXXX

PRODUCT NO: WHDB01-FXXXXXX

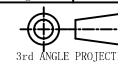

REV	DESCRIPTION	DATE
1		
2		
3		
4		
5		