

HSF



ROHS

42.77

120.00

22.77

60.00

10.00

19.00

A

B

C

D

E

F

G

F

10.50

12.50

CUT SIZE



NOTES:

1. WATERPROOF RATE: IP67
IP67: IMMERSED IN 1M WATER FOR 30 MINUTES
2. TEMPERATURE RANGE: -40° TO +80°
3. ELECTRICAL CHARACTERISTICS:
1-1 CURRENT RATING: 8AMPS+2AMPS.
1-2 CONTACT RESISTANCE: $\leq 10m\Omega$
1-3 INSULATION RESISTANCE: 100 MOhm Min. at 500VDC.
1-4 BREAKDOWN VOLTAGE: 500 V AC PER MINUTE.
4. LFE TEST: 500 CYCLES MIN.
5. OTHER GENERAL SPEG TO REFER "CIRCUAR SERIES GENERAL SPEC".
6. TO CONFORM TO ROHS REQUIREMENT
7. GREEN PRODUCT IDENTIFICATION LABEL ON PACKAGING: ROHS

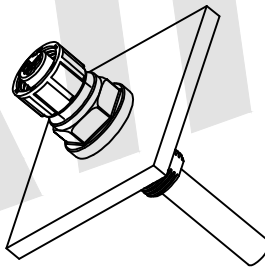

G	Cable	1	DEMAND
F	Nut	1	AL6063 BLACK
E	Over Mold	1	NYLON(UV) BLACK
D	O RING	2	SILIGONE RED
C	FEMALE SCREW NUT	1	AL6063 BLACK
B	Female PIN	/	PHOSPHOR BRONZE GOLD PLATING OVER NICKEL PLATING
A	BODY	1	NYLON+GF BLACK
Item	PART NAME	QTY	MATERIAL /FINISH

Pin Assignments 2 Pin	Pin Assignments 3 Pin	Pin Assignments 4 Pin	Pin Assignments 5 Pin	Pin Assignments 6 Pin	Pin Assignments 8 Pin	Pin Assignments 12 Pin

Unless Otherwise specified tolerance

X. ± 0.35	X. XX: ± 0.20
X. X: ± 0.25	X. XXX: ± 0.15
SCALE: As Shown	UNIT: mm
DRAW ZLA	DATE 13/05/2022
CHECK BobYang	DATE 13/05/2022

Antenk ANTENK ELECTRONICS CO., LTD
[Http://www.antenk.com](http://www.antenk.com)
 E-mail: sales@antenk.com

TITLE: M12B Flange Type Female Metal Nut

DRAWING NO: M12B-XP-F-002

PRODUCT NO: M12B-XP-F-002

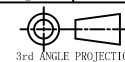

3rd ANGLE PROJECTION

REV	DESCRIPTION	DATE
-----	-------------	------

1

2

3

4

5

6

7

8