

HSF



ROHS

SPECIFICATIONS

- Voltage rating: 150V AC,DC
- Current rating: 1A AC,DC
- Withstanding Voltage: 500V AC/minute
- Insulation resistance:500MΩ min
- Temperature range: -40°C~+105°C

WAFER

- Part NO: AW1252V-S-2xNP
- Material: Pin: Brass/Tin over Nickel
Solder Tabs:Phosphor Bronze/Tin over Nickel
Insulator: Nylon 6T, UL94V-0
Cap: Nylon 6T, UL94V-0
- Mates with: AH1252 series Dual Row Housing
- Color: Ivory

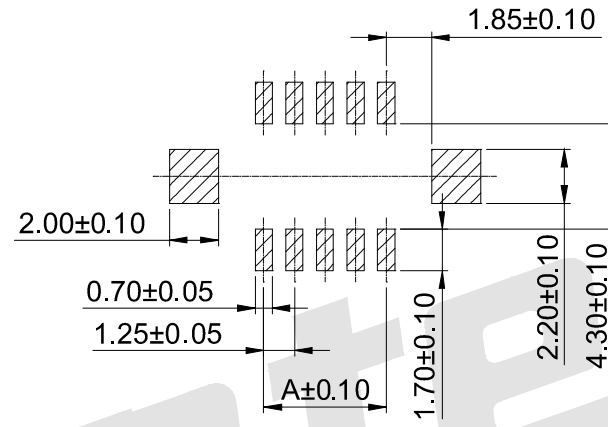
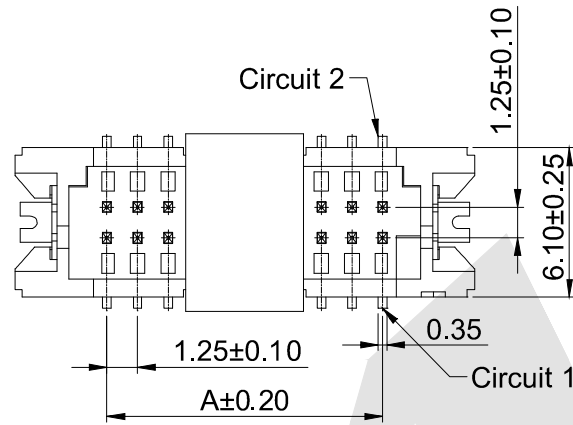

P.C.B LAYOUT

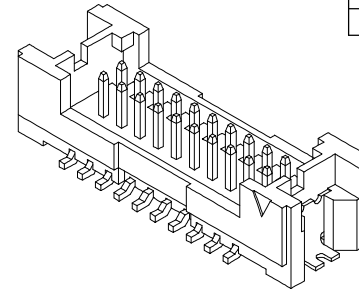
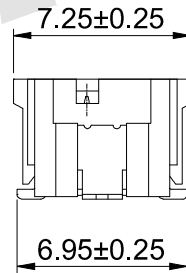
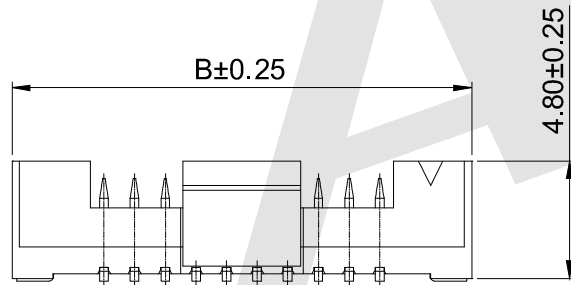

Ordering Information & Dimensions:

Poles	Part No.	Dimensions (mm)	
		A	B
10	AW1252V-S-2x5P	5.00	12.50
14	AW1252V-S-2x7P	7.50	15.00
20	AW1252V-S-2x10P	11.25	18.75
30	AW1252V-S-2x15P	17.50	25.00
40	AW1252V-S-2x20P	23.75	31.25

Unit:mm

Unless Otherwise specified tolerance
 X. ±0.35 X.XX: ±0.20
 X.X: ±0.25 X.XXX: ±0.15



ANTENK ELECTRONICS CO., LTD
[Http://www.antenk.com](http://www.antenk.com)
 E-mail:sales@antenk.com

SCALE: As Shown	UNIT: mm
DRAW Jack Bao	DATE 11/04/2017
CHECK Bob Yang	DATE 11/04/2017

TITLE: 1.25mm pitch 180° SMT Dual Row Wafer Connector Series

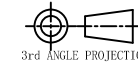

DRAWING NO: AW1252V-S-2xNP

PRODUCT NO: AW1252V-S-2xNP

REV	DESCRIPTION	DATE