

SPECIFICATIONS:

Voltage rating: 30V AC/DC
 Current rating: 0.5A AC/DC
 Withstanding Voltage: 200V AC/minute
 Insulation resistance: 100MΩ Min.
 Temperature range: -25°C To +85°C
 Contact resistance: 20mΩ Max.

Standards

HSF



RoHS

Assembly Layout

Vertical Type

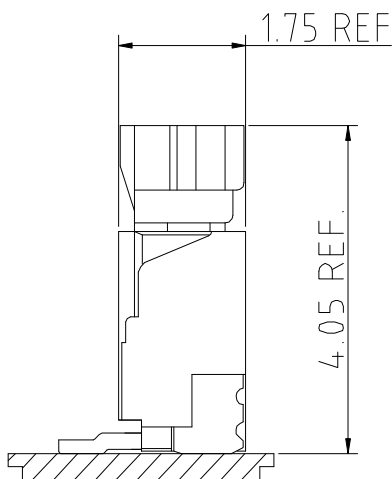

Right Angle Type

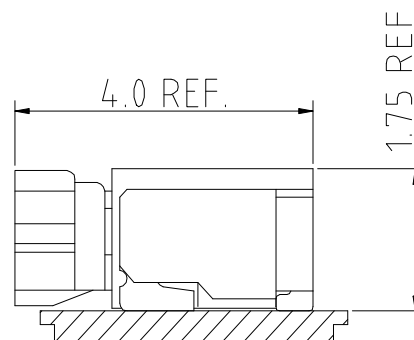

0.80mm Pitch IDC type connector

Material:

• Insulator: Nylon 46 UL94V-0

• Contact Phosphor Bronze

Applicable Wire: AWG#34

• Insulation O.D. 0.35mm

Plating: Tin plated over Nickel

Suitable: AW0800 Series Single Row Wafer

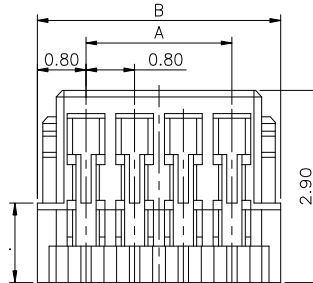
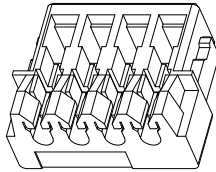
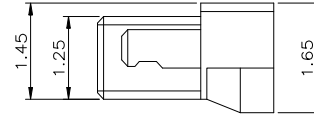
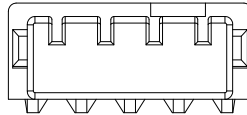

PART NO.	Dimension mm		PART NO.	Dimension mm	
	A	B		A	B
AH0800-2P-1	0.80	2.40	AH0800-14P-1	10.40	12.00
AH0800-3P-1	1.60	3.20	AH0800-15P-1	11.20	12.80
AH0800-4P-1	2.40	4.00	AH0800-16P-1	12.00	13.60
AH0800-5P-1	3.20	4.80	AH0800-17P-1	12.80	14.40
AH0800-6P-1	4.00	5.60	AH0800-18P-1	13.60	15.20
AH0800-7P-1	4.80	6.40	AH0800-19P-1	14.40	16.00
AH0800-8P-1	5.60	7.20	AH0800-20P-1	15.20	16.80
AH0800-9P-1	6.40	8.00	AH0800-21P-1	16.00	17.60
AH0800-10P-1	7.20	8.80	AH0800-22P-1	16.80	18.40
AH0800-11P-1	8.00	9.60	AH0800-23P-1	17.60	19.20
AH0800-12P-1	8.80	10.40	AH0800-24P-1	18.40	20.00
AH0800-13P-1	9.60	11.20			

0.80mm Pitch IDC type connector

Material:

• Insulator: Nylon 66 UL94V-0

• Contact Phosphor Bronze

Applicable Wire: AWG#36

• Insulation O.D. 0.29mm

Plating: Tin plated over Nickel

Suitable: AW0800 Series Single Row Wafer

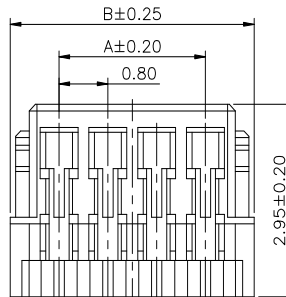
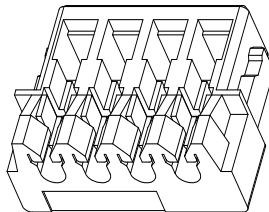
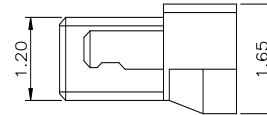
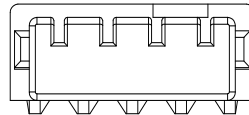

PART NO.	Dimension mm		PART NO.	Dimension mm	
	A	B		A	B
AH0800-2P-2	0.80	2.40	AH0800-14P-2	10.40	12.00
AH0800-3P-2	1.60	3.20	AH0800-15P-2	11.20	12.80
AH0800-4P-2	2.40	4.00	AH0800-16P-2	12.00	13.60
AH0800-5P-2	3.20	4.80	AH0800-17P-2	12.80	14.40
AH0800-6P-2	4.00	5.60	AH0800-18P-2	13.60	15.20
AH0800-7P-2	4.80	6.40	AH0800-19P-2	14.40	16.00
AH0800-8P-2	5.60	7.20	AH0800-20P-2	15.20	16.80
AH0800-9P-2	6.40	8.00	AH0800-21P-2	16.00	17.60
AH0800-10P-2	7.20	8.80	AH0800-22P-2	16.80	18.40
AH0800-11P-2	8.00	9.60	AH0800-23P-2	17.60	19.20
AH0800-12P-2	8.80	10.40	AH0800-24P-2	18.40	20.00
AH0800-13P-2	9.60	11.20			

0.80mm Pitch IDC type connector

Material:

• Insulator: Nylon 66 UL94V-0

• Contact Phosphor Bronze

Applicable Wire: AWG#32

• Insulation O.D. 0.38mm

Plating: Tin plated over Nickel

Suitable: AW0800 Series Single Row Wafer

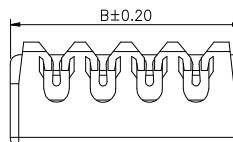
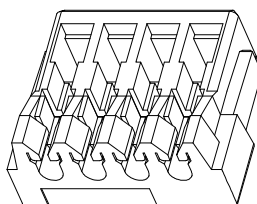
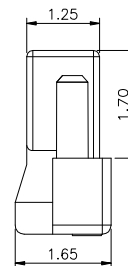
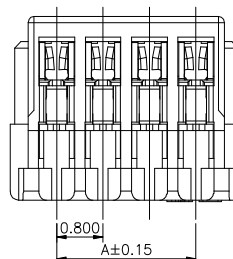

PART NO.	Dimension mm		PART NO.	Dimension mm	
	A	B		A	B
AH0800-2P-3	0.80	2.40	AH0800-13P-3	9.60	11.20
AH0800-3P-3	1.60	3.20	AH0800-14P-3	10.40	12.00
AH0800-4P-3	2.40	4.00	AH0800-15P-3	11.20	12.80
AH0800-5P-3	3.20	4.80	AH0800-16P-3	12.00	13.60
AH0800-6P-3	4.00	5.60	AH0800-17P-3	12.80	14.40
AH0800-7P-3	4.80	6.40	AH0800-18P-3	13.60	15.20
AH0800-8P-3	5.60	7.20	AH0800-19P-3	14.40	16.00
AH0800-9P-3	6.40	8.00	AH0800-20P-3	15.20	16.80
AH0800-10P-3	7.20	8.80	AH0800-22P-3	16.80	18.40
AH0800-11P-3	8.00	9.60	AH0800-24P-3	18.40	20.00
AH0800-12P-3	8.80	10.40	AH0800-25P-3	21.60	23.20

0.80mm Pitch 180° Wafer-SMT type connector

Material:

Insulator:LCP UL94V-0

Contact&Solder Nail :Phosphor Bronze

Plating:Gold Or Tin plated over Nickel

Suitable:AH0800&AH0801 Series Single Row Housing

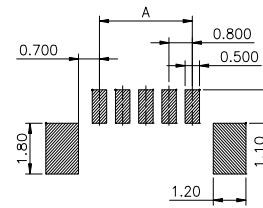
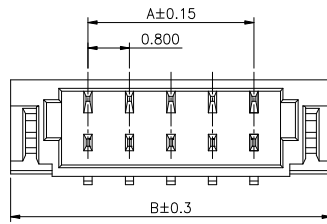

AW0800V-S-NP-X
SN:MATTE-TIN
G:GOLD FLASH

PART NO.	Dimension	
	A	B
AW0800V-S-2P-X	0.80	3.80
AW0800V-S-3P-X	1.60	4.60
AW0800V-S-4P-X	2.40	5.40
AW0800V-S-5P-X	3.20	6.20
AW0800V-S-6P-X	4.00	7.00
AW0800V-S-7P-X	5.60	8.60
AW0800V-S-8P-X	7.20	10.20
AW0800V-S-9P-X	8.80	11.80
AW0800V-S-10P-X	10.40	13.40
AW0800V-S-11P-X	11.20	14.20
AW0800V-S-12P-X	12.00	15.00
AW0800V-S-13P-X	12.80	15.80
AW0800V-S-14P-X	15.20	18.20
AW0800V-S-15P-X	16.80	19.80
AW0800V-S-16P-X	18.40	21.40

Recommended P.C.Board Layout

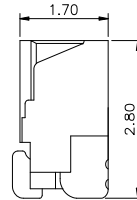
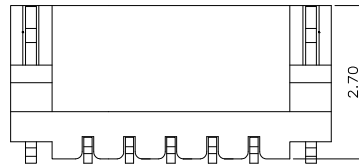

0.80mm Pitch 90° Wafer-SMT type connector

Material:

Insulator:LCP UL94V-0

Contact&Solder Nail :Phosphor Bronze

Plating:Gold Or Tin plated over Nickel

Suitable:AH0800&AH0801 Series Single Row Housing

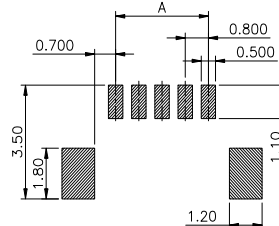
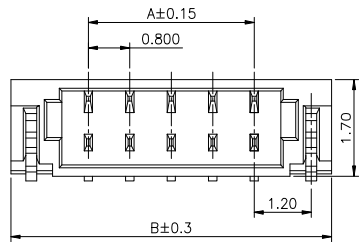

AW0800R-S-NP-X
SN:MATTE-TIN
G:GOLD FLASH

PART NO.	Dimension	
	A	B
AW0800R-S-2P-X	0.80	3.80
AW0800R-S-3P-X	1.60	4.60
AW0800R-S-4P-X	2.40	5.40
AW0800R-S-5P-X	3.20	6.20
AW0800R-S-6P-X	4.00	7.00
AW0800R-S-7P-X	5.60	8.60
AW0800R-S-8P-X	7.20	10.20
AW0800R-S-9P-X	8.80	11.80
AW0800R-S-10P-X	10.40	13.40
AW0800R-S-11P-X	11.20	14.20
AW0800R-S-12P-X	12.00	15.00
AW0800R-S-13P-X	12.80	15.80
AW0800R-S-14P-X	15.20	18.20
AW0800R-S-15P-X	16.80	19.80
AW0800R-S-16P-X	18.40	21.40

Recommended P.C.Board Layout

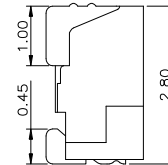
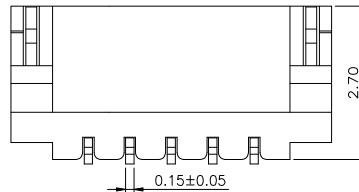

0.80mm Pitch housing connector

HOUSING

- Part NO.:AH0801-xP
- Suitable:AT0801T-XP series Terminal
- Mates with:AW0801V-S-xP,AW0801R-S-xP series Wafer
- Material:LCP,UL94V-0
- Color:Natural

Part No.	Dimensions(mm)	
	A	B
AH0801-02P	0.80	2.40
AH0801-03P	1.60	3.20
AH0801-04P	2.40	4.00
AH0801-05P	3.20	4.80
AH0801-06P	4.00	5.60
AH0801-07P	4.80	6.40
AH0801-08P	5.60	7.20
AH0801-09P	6.40	8.00
AH0801-10P	7.20	8.80
AH0801-11P	8.00	9.60
AH0801-12P	8.80	10.40
AH0801-13P	9.60	11.20
AH0801-14P	10.40	12.00
AH0801-15P	11.20	12.80
AH0801-16P	12.00	13.60
AH0801-17P	12.80	14.40
AH0801-18P	13.60	15.20
AH0801-19P	14.40	16.00
AH0801-20P	15.20	16.80

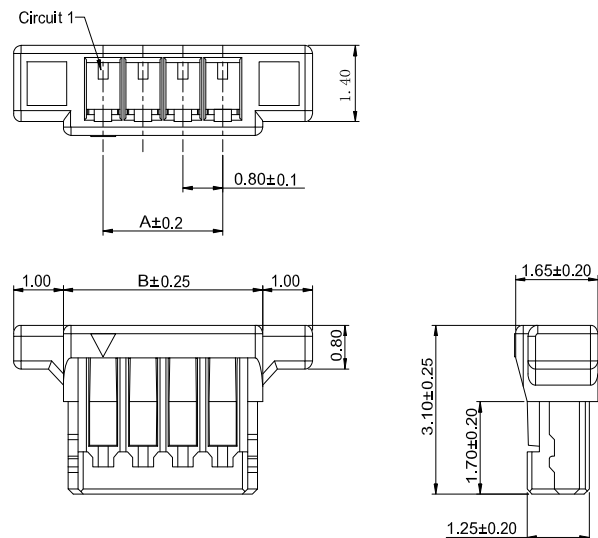

0.80mm Pitch housing connector

HOUSING

- Part NO.:AH0801-xP-2
- Suitable:AT0801T-xP series Terminal
- Mates with:AW0801V-S-xP,AW0801R-S-xP series Wafer
- Material:LCP,UL94V-0
- Color:Natural

Part No.	Dimensions(mm)	
	A	B
AH0801-02P-2	0.80	2.40
AH0801-03P-2	1.60	3.20
AH0801-04P-2	2.40	4.00
AH0801-05P-2	3.20	4.80
AH0801-06P-2	4.00	5.60
AH0801-07P-2	4.80	6.40
AH0801-08P-2	5.60	7.20
AH0801-09P-2	6.40	8.00
AH0801-10P-2	7.20	8.80
AH0801-11P-2	8.00	9.60
AH0801-12P-2	8.80	10.40
AH0801-13P-2	9.60	11.20
AH0801-14P-2	10.40	12.00
AH0801-15P-2	11.20	12.80
AH0801-16P-2	12.00	13.60
AH0801-17P-2	12.80	14.40
AH0801-18P-2	13.60	15.20
AH0801-19P-2	14.40	16.00
AH0801-20P-2	15.20	16.80

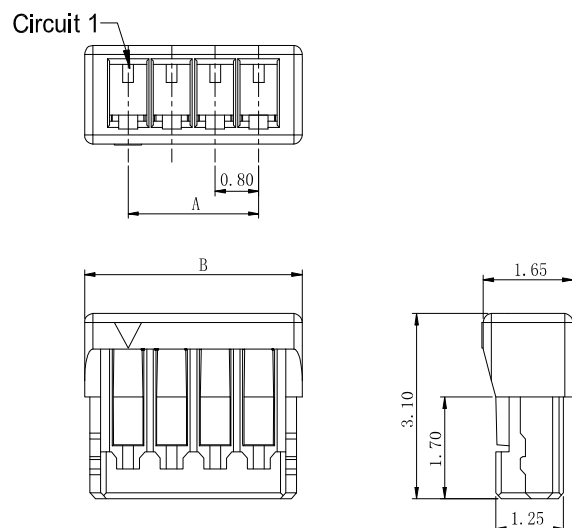

0.80mm pitch Crimp terminal connector

TERMINAL

- Part NO:AT0801T-xP
- Applicable wire:AWG#28-#32
- Material:Phosphor Bronze
- Finish:Tin Plated or Gold
- Used in AH0801-xP,AH0801A-xP series Housing

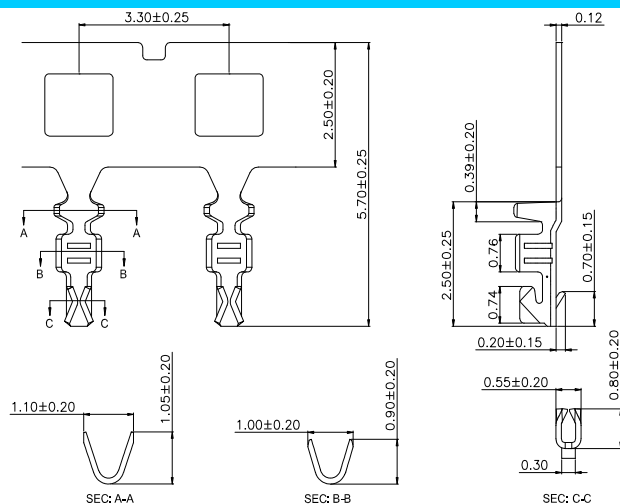

Ordering information & Specifications

Unit:mm

Part No.	Wire Range	Insulation O.D.	Material	Finish	Qty/reel
AT0801T-TP	AWG#28-#32	0.60mm(max)	Phosphor Bronze	Tin over Nickel	45,000 PCS
AT0801T-GP	AWG#28-#32	0.60mm(max)	Phosphor Bronze	Gold over flash	45,000 PCS