

HSF

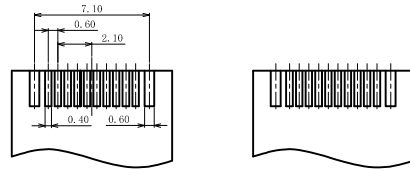

PCB LAYOUT

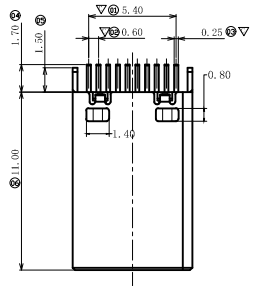
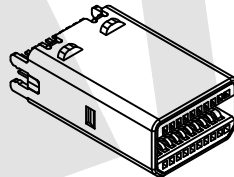
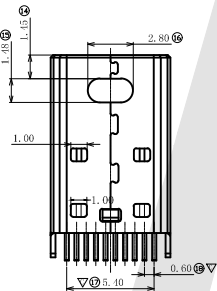
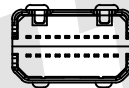
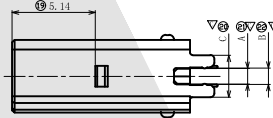
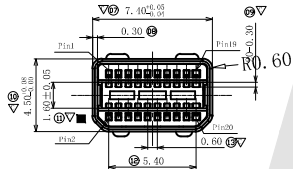

▽:Key Control Dimension
 ⊗:FAI Dimension
 ■:CPK Dimension.

TYPE	Dimension A	Dimension B	Dimension C
1	0.96	1.00	2.60
2	1.06	1.20	2.70
3	1.46	1.60	3.10

Top Row			Bottom Row		
Pin Number	Signal Type	Pin Name	Pin Number	Signal Type	Pin Name
1	GND	GND	2	In	HotPlug Detect
3	Out	ML_Lane 0(p)	4	CONFIG	CONFIG1
5	Out	ML_Lane 0(n)	6	CONFIG	CONFIG2
7	GND	GND	8	GND	GND
9	Out	ML_Lane 1(p)	10	Out	ML_Lane 3(p)
11	Out	ML_Lane 1(n)	12	Out	ML_Lane 3(n)
13	GND	GND	14	GND	GND
15	Out	ML_Lane 2(p)	16	I/O	AUX_CH(p)
17	Out	ML_Lane 2(n)	18	I/O	AUX_CH(n)
19	GND	GND	20	PWR Out	DP_PWR

Specifications

1. materials:
 - 1.1 Terminal:C5191,Selective Gold Plating and Matte Tin Plating;
 - 1.2 Housing:Moding LCP Black,Body LCP Nature;
 - 1.3 Shell:C2680 Gold Plating, Salt Spray 24H;
2. Electrics:
 - 2.1 Rated Voltage:40VAC MAX;
 - 2.2 Rated Current:0.5A
 - 2.3 Contact Resistance:30mΩ Max.
 - 2.4 Insulation Resistance:100MΩ Min.
 - 2.5 Withstand Voltage:300VAC;
3. Mechanical:
 - 3.1 Insertion Force:4.5Kgf Max.
 - 3.2 Withdrawal Force:1.0~4.0Kgf.
 - 3.3 Durability:10,000 Cycles
4. Enviromental:
 - 4.1 Temperature Range:-40℃~+85℃
5. Packing:Tray

Ordering Code:

MDP - M - X - X - X - 04
 ① ② ③ ④ ⑤ ⑥

- | | |
|---|---|
| ① Series No: | ④ Shell Plating:
1:Nickel Plated
2:Tin-Nickel Plated
3:Gold Plated |
| ② Male/female:
M:male | ⑤ Straddle Type:
See the table |
| ③ Contact Plating:
1: Selective 1u"
2: Selective 3u"
3: Selective 5u"
4: Selective 15u"
5: Selective 30u"
6: All Gold | ⑥ series number:
04 |

Unless Otherwise specified tolerance
 X. ±0.35 X.XX:±0.20
 X.X:±0.25 X.XXX:±0.15

SCALE: As Shown UNIT: mm
 DRAW ZLA DATE 24/03/2022
 CHECK BobYang DATE 24/03/2022

Antenk ANTENK ELECTRONICS CO.,LTD
 Http://www.antenk.com
 E-mail:sales@antenk.com

TITLE: Mini Display Port Plug(straddle selective type)

DRAWING NO: MDP-M-X-X-X-04

PRODUCT NO: MDP-M-X-X-X-04

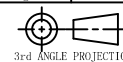

REV	DESCRIPTION	DATE
1		
2		
3		
4		
5		