

HSF

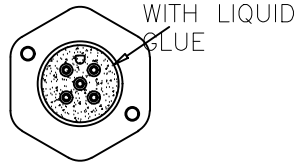

ROHS

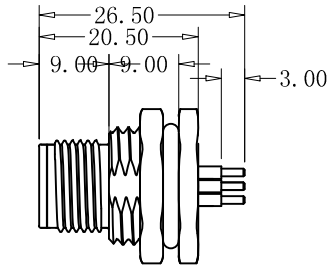
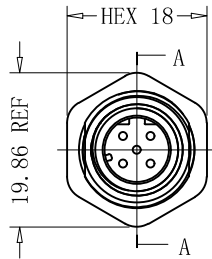

3D View

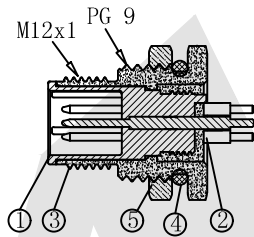

Section A-A

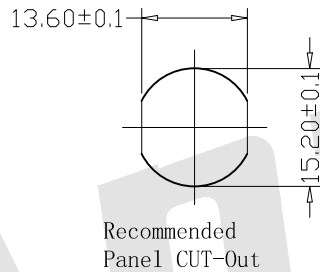

Recommended Panel CUT-Out

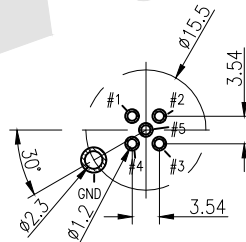

3~5P RECOMMENDED PCB LAYOUT; TOL: ±0.05mm

Notes:

- Waterproof rate: IP68  
IP68: Immersed in 1M water for 24 hours
- Electrical characteristics  
Temperature range: -40° C to +100° C  
rating: 60V AC/DC 5A  
Dielectric withstanding voltage: 500V AC for one minute
- For panel thickness Max of 4.0mm

Order Code:

M12 - D - XP - M - 143  
① ② ③ ④ ⑤

- Type of M series: M12
- Code option: D Code
- NO. of PINS: 03~05
- Gender option: Male
- Series number: 143

M12-D-03P -M-143	
M12-D-04P -M-143	
M12-D-05P -M-143	
P/N	PIN ASSIGNMENTS FRONT VIEW

5	Nut	Copper alloy	Nickel plating 60u	1
4	Waterproof ring	Silicone	Red	2
3	Shell	Copper alloy	Nickel plating 60u	1
2	Plug Pin	Copper alloy	Gold plating 3u	3~5
1	Plastic core	Nylon UL94 V-0	Black	1
NO.	ITEM	MATERIALS	SURFACE	QUANTITY

Unless Otherwise specified tolerance  
X. ±0.35 X.XX: ±0.20  
X.X: ±0.25 X.XXX: ±0.15

SCALE: As Shown	UNIT: mm
DRAW ZLA	DATE 07/04/2022
CHECK BobYang	DATE 07/04/2022

**Antenk** ANTENK ELECTRONICS CO., LTD  
Http://www.antenk.com  
E-mail: sales@antenk.com

TITLE:  
M12 3~5P Male Lock Front PG9 D Code DIP  
180° Unshielded

DRAWING NO: M12-D-XP-M-143

PRODUCT NO: M12-D-XP-M-143

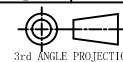

3rd ANGLE PROJECTION

REV	DESCRIPTION	DATE
1		