



OPzS-250

GREENSAVER OPzS batteries are designed with a combination of die-casting Tubular positive framework and superfluous electrolyte technologies to offer a very high level of reliability and a long service life.

GREENSAVER OPzS batteries used special filter and proof design to ensure no acid fog runs over and burning proof, and also convenient examine and maintenance.

GREENSAVER OPzS batteries make if idea for a wide range of applications such as Telecommunications, Photovoltaic System, Security System, emergency lighting and UPS.

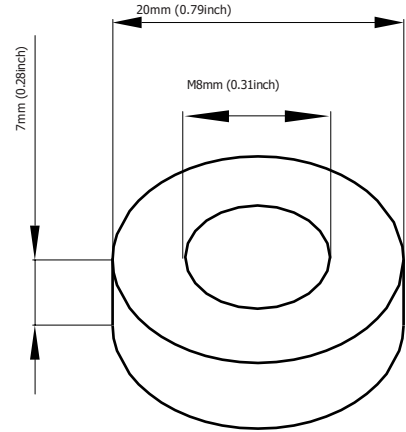

Features & Benefits

- Low maintenance.
- Super long service life.
- Transparent containers, convenient to observe.
- Special filter installation for acid fog proof.
- High quality and high reliability.
- Special pole sealed technology.
- DIN40736-1 complaint.

Cell Dimensions

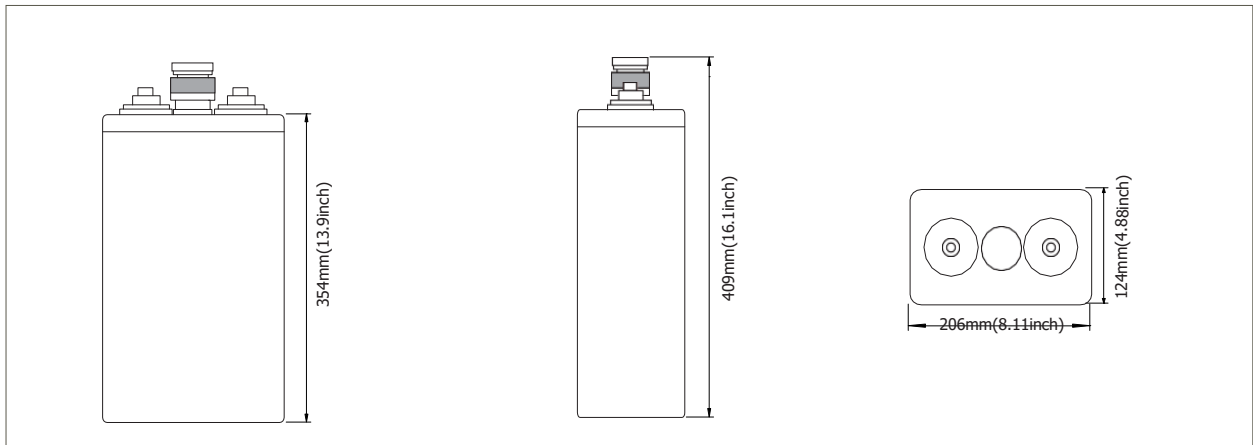

Terminal Dimensions

Battery Model	OPzS250			
Designed Floating Life	20 Years			
Capacity(25°C)	24HR(11.3A,1.80V)	10HR(25.0A,1.80V)	5HR(42.0A,1.80V)	1HR(134A,1.75V)
	271AH	250AH	210AH	134AH
Dimensions	Length	Width	Height	Total Height
	124mm(4.88inch)	206mm(8.11inch)	353mm(13.9inch)	409mm(16.1inch)
Approx. Weight	without electrolyte:16.3Kg (35.9 lbs)		with electrolyte:20.9Kg(46.1 lbs)	
Internal Resistance	Full charged at 20°C: 0.0008 Ohm			
Self Discharge	3% of capacity declined per month at (20°C)			
Capacity Affected by Temp.(10HR)	40°C	25°C	0°C	-15°C
	102%	100%	85%	65%
Charge Voltage(25°C)	Cycle use		Float use	
	2.35-2.40V/cell(-5mV/cell/°C), max. Current: 62A		2.23V/cell(-3.0mV/cell/°C)	

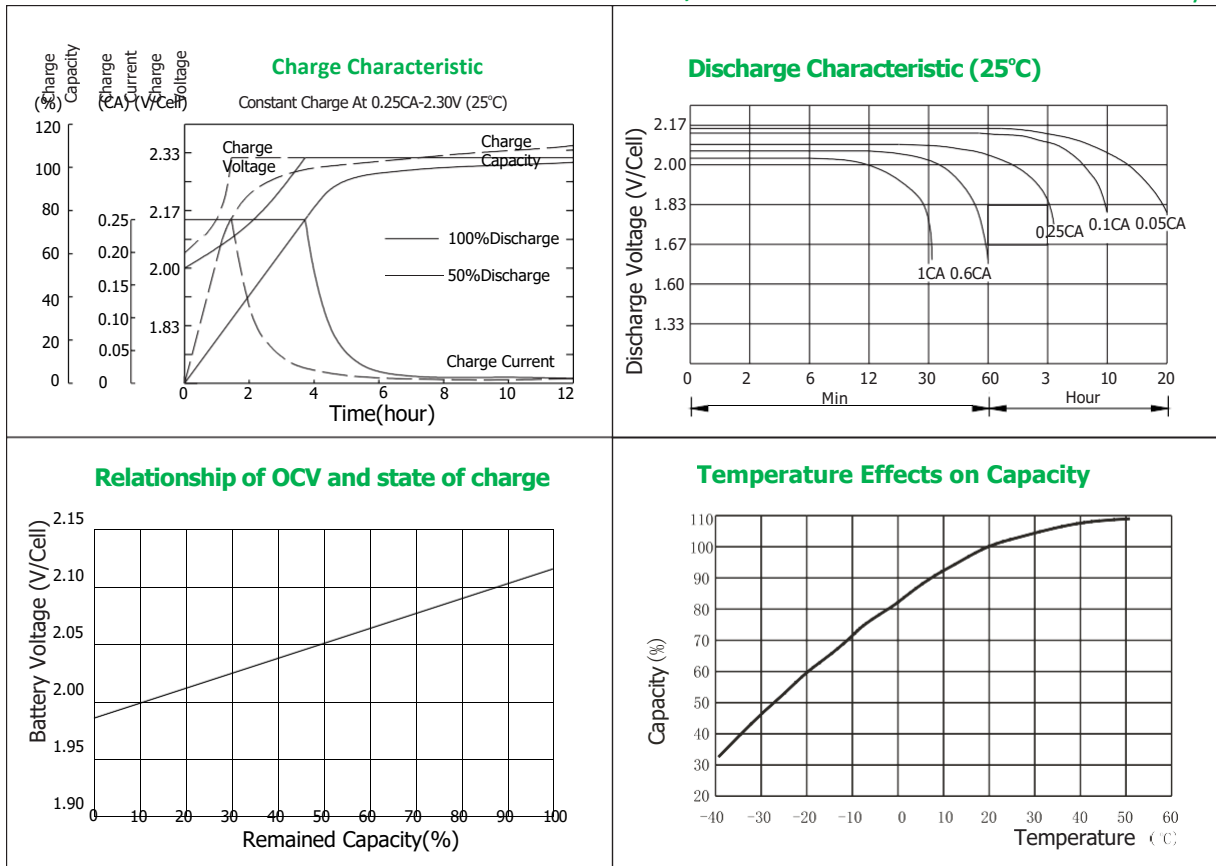

Constant Current Discharge Data Units: Amperes (25°C, 77°F)

End voltage	minutes		hours									
	30	1	2	3	4	5	6	8	10	24	48	
1.60V	212.4	145.4	90.6	65.8	52.4	44.9	39.8	32.2	26.5	11.9	6.6	
1.65V	205.0	142.1	88.7	64.4	51.4	44.5	39.2	32.0	26.4	11.9	6.6	
1.70V	196.8	137.7	86.8	63.3	50.9	43.9	38.6	31.6	26.2	11.8	6.5	
1.75V	189.6	133.8	84.2	61.9	50.0	43.1	37.9	30.9	25.9	11.5	6.4	
1.80V	173.6	127.6	81.4	60.9	49.0	42.0	36.9	30.2	25.1	11.3	6.3	
1.85V	145.9	118.4	77.0	58.5	47.5	40.8	35.6	29.4	24.8	11.0	6.0	
19.5V	124.6	94.5	67.3	52.7	44.1	37.9	32.9	26.6	22.3	10.0	5.6	

Constant Power Discharge Data Units: Watts per cell (25°C, 77°F)

End voltage	minutes		hours									
	30	1	2	3	4	5	6	8	10	12	24	
1.60V	429.7	329.2	181.6	137.8	110.0	93.1	81.9	67.5	57.0	49.1	25.2	
1.65V	407.3	305.9	180.6	136.8	109.4	92.5	81.3	67.1	56.6	48.8	25.0	
1.70V	388.5	287.0	178.0	135.3	108.0	91.1	80.1	66.1	55.8	48.2	24.7	
1.75V	372.7	269.8	173.1	131.8	103.9	87.9	78.4	65.1	54.8	47.5	24.4	
1.80V	357.8	254.9	166.7	128.3	101.5	83.9	74.9	62.0	52.0	44.5	23.9	
1.85V	344.0	236.6	160.7	121.9	96.5	81.7	72.0	60.3	49.8	42.7	23.3	
1.95V	314.3	210.9	145.8	117.9	101.5	84.6	68.6	57.3	45.2	39.1	22.3	

