



OPzS-2000

GREENSAVER OPzS batteries are designed with a combination of die-casting Tubular positive framework and superfluous electrolyte technologies to offer a very high lever of reliability and a long service life.

GREENSAVER OPzS batteries used special filter and proof design to ensure no acid fog runs over and burning proof, and also convenient examine and maintenance.

GREENSAVER OPzS batteries make if idea for a wide range of applications such as Telecommunications, Photovoltaic System, Security System, emergency lighting and UPS.

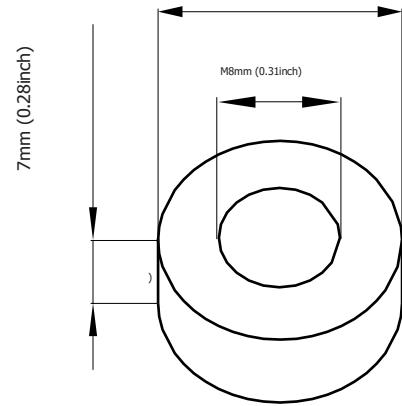

Features & Benefits

- Low maintenance.
- Super long service life.
- Transparent containers, convenient to observe.
- Special filter installation for acid fog proof.
- High quality and high reliability.
- Special pole sealed technology.
- DIN40736-1 compliant.

Cell Dimensions

Terminal Dimensions

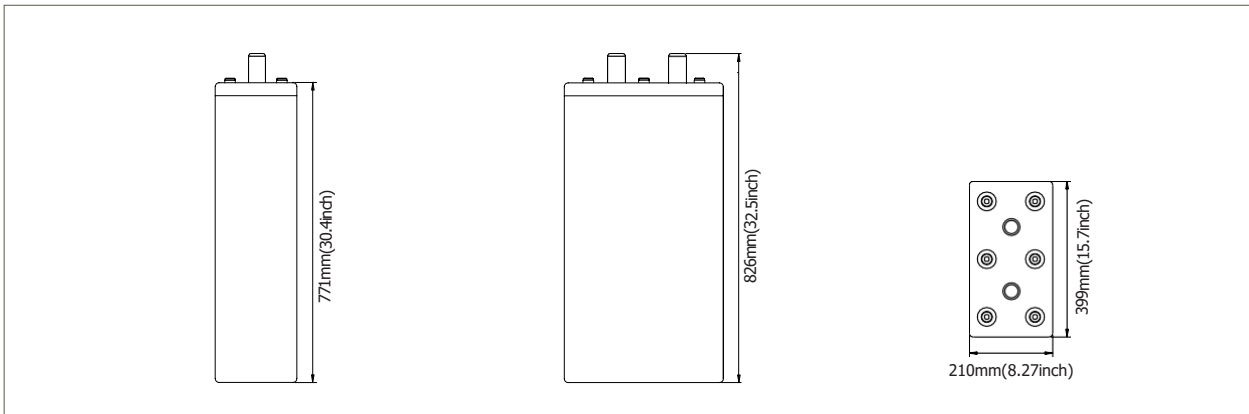

Battery Model	OPzS2000			
Designed Floating Life	20 Years			
Capacity(25°C)	24HR(89.5A,1.80V)	10HR(200A,1.80V)	5HR(333A,1.80V)	1HR(1059A,1.75V)
	2148AH	2000AH	1665AH	1059AH
Dimensions	Length	Width	Height	Total Height
	399mm(15.7inch)	210mm(8.27inch)	771mm(30.4inch)	826mm(32.5inch)
Approx. Weight	without electrolyte:118Kg (260 lbs)		with electrolyte:161Kg (355 lbs)	
Internal Resistance	Full charged at 20°C: 0.0005 Ohm			
Self Discharge	3% of capacity declined per month at (20°C)			
Capacity Affected by Temp.(10HR)	40°C	25°C	0°C	-15°C
	102%	100%	85%	65%
Charge Voltage(25°C)	Cycle use		Float use	
	2.35-2.40V/cell(-5mV/cell/°C), max. Current: 500A		2.23V/cell(-3.0mV/cell/°C)	

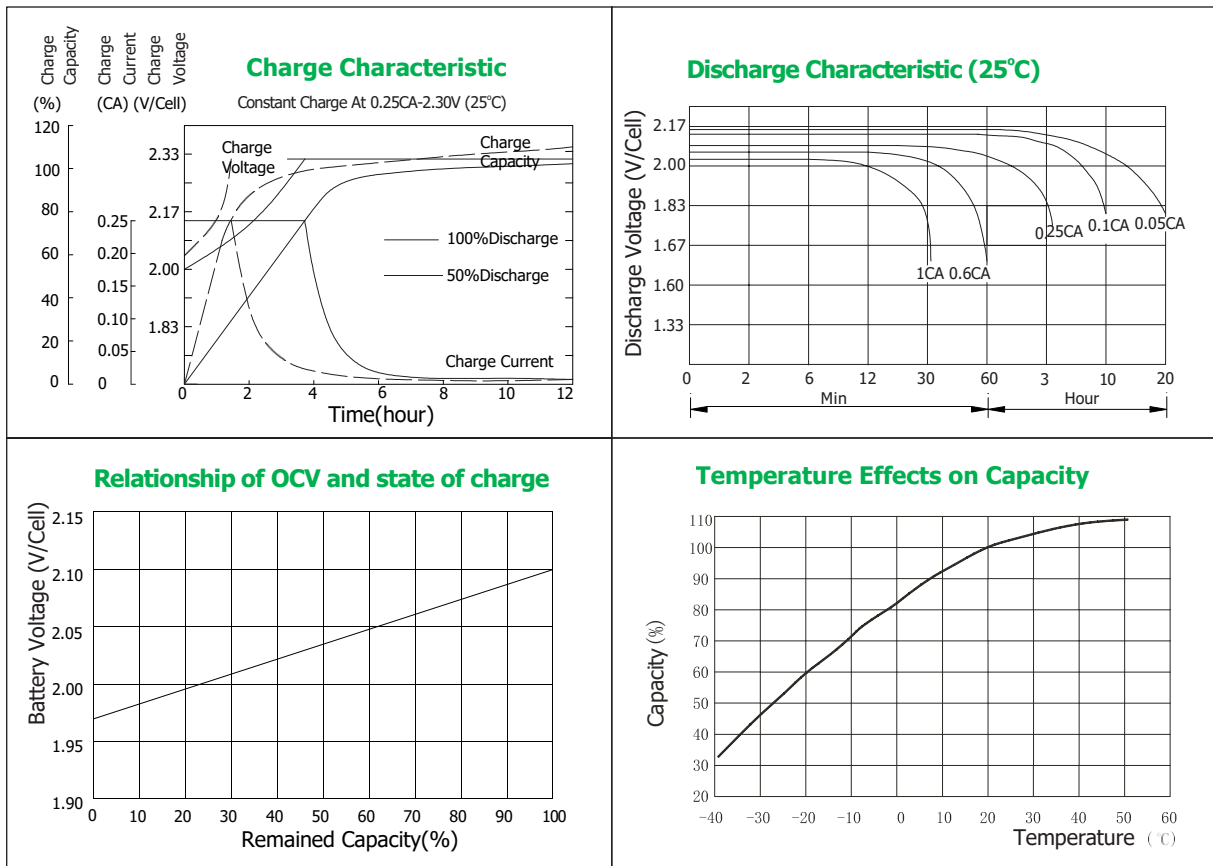

Constant Current Discharge Data Units: Amperes (25°C, 77°F)

End voltage	minutes	hours									
	30	1	2	3	4	5	6	8	10	24	48
1.60V	1681.2	1151.9	718.1	518.4	413.2	355.6	314.3	254.5	211.6	94.4	52.1
1.65V	1626.0	1123.7	703.5	510.5	408.3	351.7	310.2	252.5	210.5	94.4	51.7
1.70V	1559.1	1090.8	687.0	501.8	402.5	346.8	305.4	249.6	209.6	93.4	51.2
1.75V	1501.0	1058.8	668.5	491.1	395.6	340.9	299.5	244.8	206.5	91.4	50.6
1.80V	1373.0	1008.4	643.1	479.4	386.8	333.2	291.7	239.1	200.3	89.5	49.8
1.85V	1154.8	937.6	610.0	463.9	375.1	322.5	281.9	232.3	197.6	86.5	47.4
1.95V	985.2	748.5	531.0	415.1	348.6	300.0	260.4	210.5	177.7	79.4	44.2

Constant Power Discharge Data Units: Watts per cell (25°C, 77°F)

End voltage	minutes	hours									
	30	1	2	3	4	5	6	8	10	12	24
1.60V	3403.9	2606.1	1437.3	1093.2	872.6	736.9	648.0	534.7	451.3	376.8	198.4
1.65V	3223.8	2424.0	1428.4	1085.2	866.7	731.9	643.5	531.0	448.2	374.2	197.2
1.70V	3077.3	2270.6	1408.5	1070.3	854.7	721.7	634.6	523.7	442.0	369.1	194.5
1.75V	2952.5	2135.9	1368.7	1043.4	821.7	696.1	620.6	515.1	433.9	362.3	191.7
1.80V	2834.8	2015.3	1320.0	1014.6	801.7	664.3	592.7	491.0	411.6	343.7	188.5
1.85V	2724.0	1874.7	1270.3	964.9	761.7	646.4	569.6	478.0	394.6	329.5	183.5
1.95V	2485.4	1668.8	1151.8	932.1	801.7	669.6	542.9	454.0	357.9	298.8	174.7

