



OPzS-2500

GREENSAVER OPzS batteries are designed with a combination of die-casting Tubular positive framework and superfluous electrolyte technologies to offer a very high lever of reliability and a long service life.

GREENSAVER OPzS batteries used special filter and proof design to ensure no acid fog runs over and burning proof, and also convenient examine and maintenance.

GREENSAVER OPzS batteries make if idea for a wide range of applications such as Telecommunications, Photovoltaic System, Security System, emergency lighting and UPS.

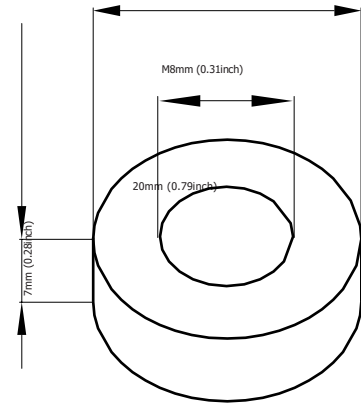

Features & Benefits

- Low maintenance.
- Super long service life.
- Transparent containers, convenient to observe.
- Special filter installation for acid fog proof.
- High quality and high reliability.
- Special pole sealed technology.
- DIN40736-1 compliant.

Cell Dimensions

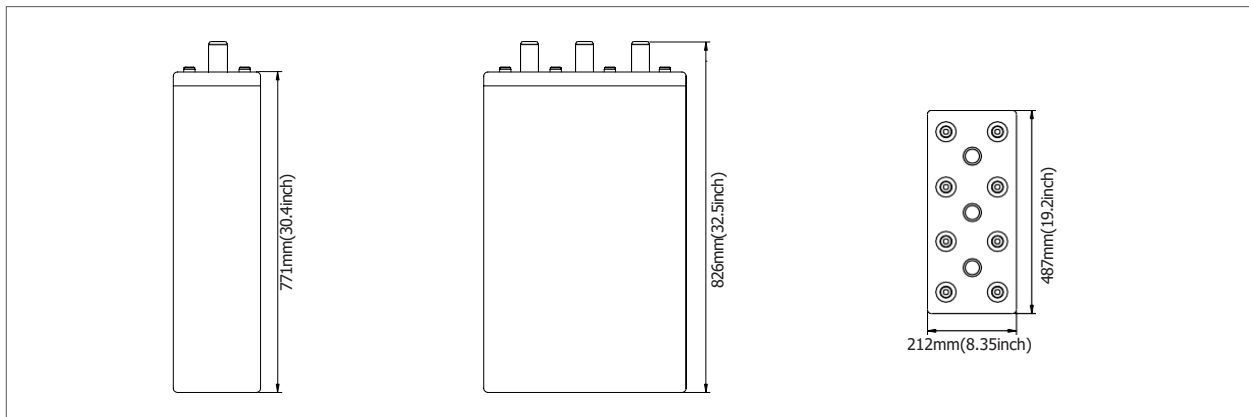

Terminal Dimensions

Battery Model	OPzS2500			
Designed Floating Life	20 Years			
Capacity(25°C)	24HR(112A,1.80V)	10HR(250A,1.80V)	5HR(417A,1.80V)	1HR(1324A,1.75V)
	2688AH	2500AH	2085AH	1240AH
Dimensions	Length	Width	Height	Total Height
	487mm(19.2inch)	212mm(8.35inch)	771mm(30.4inch)	826mm(32.5inch)
Approx. Weight	without electrolyte:152Kg (335 lbs)		with electrolyte:204Kg(450 lbs)	
Internal Resistance	Full charged at 20°C: 0.0005 Ohm			
Self Discharge	3% of capacity declined per month at (20°C)			
Capacity Affected by Temp.(10HR)	40°C	25°C	0°C	-15°C
	102%	100%	85%	65%
Charge Voltage(25°C)	Cycle use		Float use	
	2.35-2.40V/cell(-5mV/cell/°C), max. Current: 625A		2.23V/cell(-3.0mV/cell/°C)	

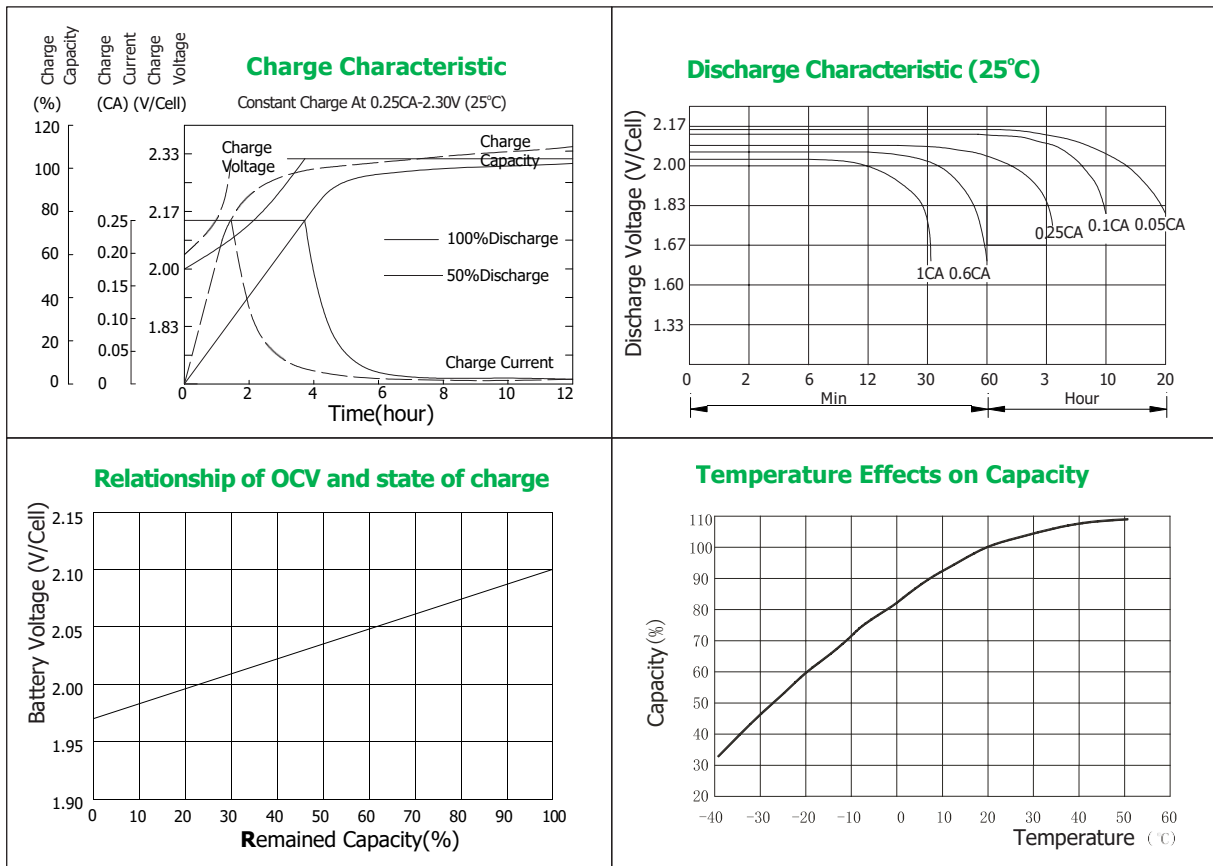

Constant Current Discharge Data Units: Amperes (25°C, 77°F)

End voltage	minutes	hours									
	30	1	2	3	4	5	6	8	10	12	24
1.60V	2101.5	1439.9	897.6	648.0	516.5	444.5	392.9	318.1	264.5	118.0	65.1
1.65V	2032.5	1404.6	879.4	638.1	510.4	439.6	387.8	315.6	263.1	118.0	64.6
1.70V	1948.9	1363.5	858.8	627.3	503.1	433.5	381.8	312.0	262.0	116.8	64.0
1.75V	1876.3	1323.5	835.6	613.9	494.5	426.1	374.4	306.0	258.1	114.3	63.3
1.80V	1716.3	1260.5	803.9	599.3	483.5	416.5	364.6	298.9	250.4	111.9	62.3
1.85V	1443.5	1172.0	762.5	579.9	468.9	403.1	352.4	290.4	247.0	108.1	59.3
1.95V	1231.5	935.6	663.8	518.9	435.8	375.0	325.5	263.1	222.1	99.3	55.3

Constant Power Discharge Data Units: Watts per cell (25°C, 77°F)

End voltage	minutes	hours									
	30	1	2	3	4	5	6	8	10	12	24
1.60V	4254.9	3257.6	1796.6	1366.5	1090.8	921.1	810.0	668.4	564.1	471.0	248.0
1.65V	4029.8	3030.0	1785.5	1356.5	1083.4	914.9	804.4	663.8	560.3	467.8	246.5
1.70V	3846.6	2838.3	1760.6	1337.9	1068.4	902.1	793.3	654.6	552.5	461.3	243.1
1.75V	3690.6	2669.9	1710.9	1304.3	1027.1	870.1	775.8	643.9	542.4	452.9	239.6
1.80V	3543.5	2519.1	1650.0	1268.3	1002.1	830.4	740.9	613.8	514.5	429.6	235.6
1.85V	3405.0	2343.4	1587.9	1206.1	952.1	808.0	712.0	597.5	493.3	411.9	229.4
1.95V	3106.8	2086.0	1439.8	1165.1	1002.1	837.0	678.6	567.5	447.4	373.6	218.4

