

NS-6045J-DI

數碼襯衫釘鈕機

Digital Shirt Button Sewing Indexer



	2	2200RPM	DP x 5 #12~#14	



- 適用於男女裝襯衫鈕子筒自動釘鈕
- 適合二孔鈕和四孔鈕，可數碼調節布夾距離，釘鈕數量可根據需要選擇
- 可根據鈕子寬窄數碼調校鈕邊距離
- 採用高精度送鈕裝置，配合自動裁片送料系統，大大提高工作效率
- 備自動收料系統能整齊收料，方便操作
- 一人操作兩台機產量: 3300~3600件/8小時 (6粒鈕/件)
- 數碼調節釘鈕範圍：320~620mm
- 數碼調節鈕釦中心与鈕子邊距離：5~19mm

跟機件：

縫紉機(JUKI LK-1903BNSS301/MC672KNN)

7個四孔送扣爪(一個已裝機，規格：1.0-2.4 *4)，其餘6個規格分別為：1.0-2.0，1.0-2.4，1.2-2.6，1.2-2.8，1.2-3.0，1.2-3.2

5個二孔送扣爪，規格分別為：1.0-2.4，1.2-2.6，1.2-2.8，1.2-3.0，1.2-3.2

- Suitable for automatic button sewing on under placket of men's or women's shirt
- Suitable for 2- and 4-hole buttons sewing, digitalized adjustment of distance between fabric clips; button sewing quantity can be preset
- The distance from button to under placket edge can be adjusted through digital interface according to placket width
- Adopt highly accurate button feeding device and automatic fabric pieces feeding system to boost efficiency
- With an automatic finished workpiece collecting device
- Output of one worker two machines: 3300~3600 pcs/8 hours (6 buttons/piece)
- Digitalized adjustment of button sewing range: 320~620mm
- Digitalized adjustment of button center to placket edge distance: 5~19mm

Standards:

Sewing head(JUKI LK-1903BNSS301/MC672KNN)

7 pieces of 4-hole button feeding claws(one has been mounted, spec.: 1.0-2.4 *4), the specs of other 6 pieces are respectively: 1.0-2.0, 1.0-2.4, 1.2-2.6, 1.2-2.8, 1.2-3.0, 1.2-3.2

5 pieces of 2-hole button feeding claws, respective specs: 1.0-2.4, 1.2-2.6, 1.2-2.8, 1.2-3.0, 1.2-3.2



效果圖 Finished Result



釘鈕操作
Button Sewing

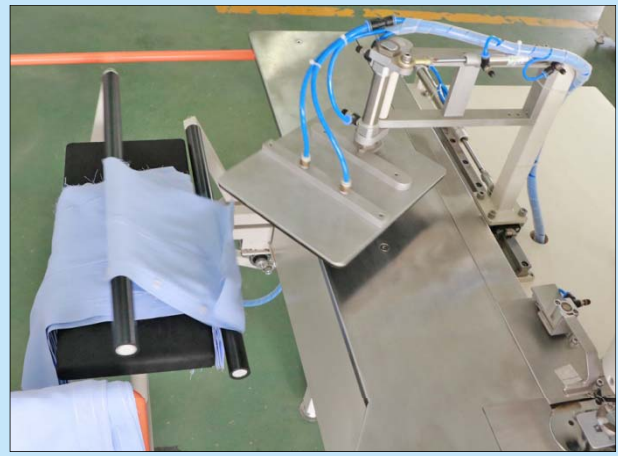

自動收料系統
Automatic Collecting System

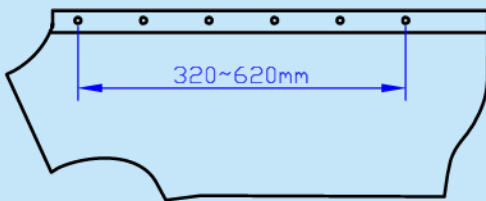

數碼調節釘鈕範圍：320~620mm
Digitalized adjustment of button sewing range:
320~620mm

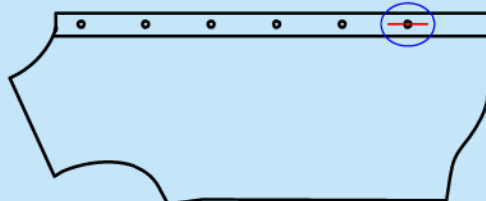

數碼調節鈕釦中心与鈕子邊距離：5~19mm
Digitalized adjustment of button center to placket edge distance:
5~19mm

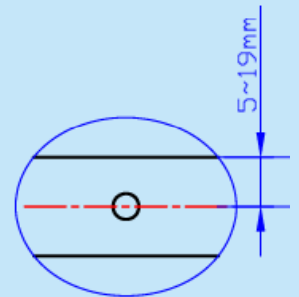

型號 Model	適用衣車頭機型 Applicable Sewing Machine Head Model	電源 Power Supply	總功率(kW) Total Power	壓縮空氣壓力 (kgf/cm ²) Compressed Air Pressure	耗壓縮空氣量 (L/min) Compressed Air Consumption	鈕釦直徑(mm) Button Diameter	鈕釦厚度(mm) Button Thickness	釘鈕範圍(mm) Button Sewing Range	鈕釦至鈕子邊距離(mm) Distance from Button Center to Placket Edge
NS-6045J-DI	JUKI LK-1903BN	1PH/220V/50Hz	1	5	10	Ø9~20	1.8~4	320~620	5~19



藝誠(余氏)發展有限公司
Ngai Shing Development Limited

香港九龍長沙灣永康街52號地下
G/F., 52 Wing Hong St.,
Cheung Sha Wan, Kln., Hong Kong.

Tel: (852) 2741 9981, 2742 0078 E-MAIL: info@ngaishing.com
Fax: (852) 2785 3149 Http://www.ngaishing.com